

Franklyn James



4 Oakland Quay

, London, E14 9EA

Asking Price £380,000

8th Floor studio suite located in the highly sought-after Baltimore Wharf. The apartment features a spacious, open-plan design with a versatile living and sleeping area which includes a wall-mounted bed that easily folds away to reveal a stylish dining table. It also boasts a spacious shower room and a private balcony

Residents of Baltimore Wharf enjoy 24-hour concierge service, on-site security, access to a state-of-the-art gym, and a 25-meter swimming pool. Ideally situated moments from Crossharbour DLR station and also within walking distance of Canary Wharf, the development is surrounded by a variety of shops, cafes, restaurants, and convenient local amenities.

- Ideal first time buy
- Stylish studio
- Residence facilities
- Chain Free
- Prime location
- Long lease
- Short walk to Crossharbour DLR

Viewing

Please contact our Westferry Sales Office on 02070056080 if you wish to arrange a viewing appointment for this property or require further information.

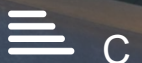

Franklyn
James

Floor Plan

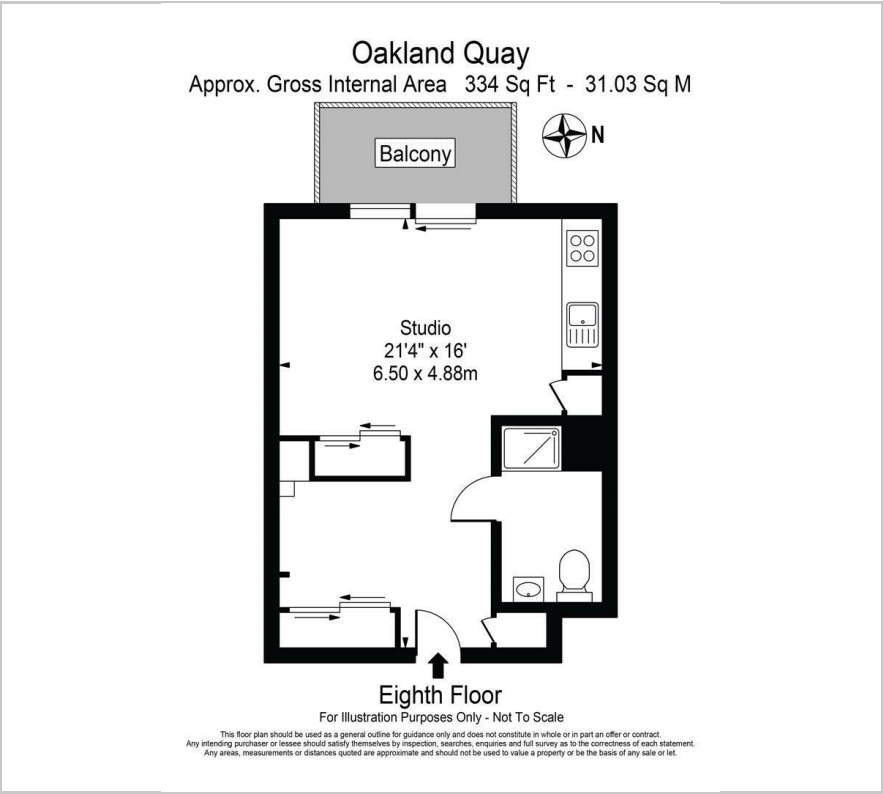

Area Map



Energy Efficiency Graph

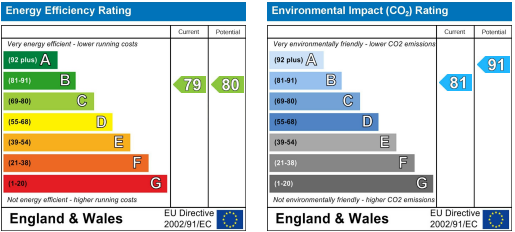

These particulars, whilst believed to be accurate are set out as a general outline only for guidance and do not constitute any part of an offer or contract. Intending purchasers should not rely on them as statements of representation of fact, but must satisfy themselves by inspection or otherwise as to their accuracy. No person in this firm's employment has the authority to make or give any representation or warranty in respect of the property.