

# Franklyn James



626 Commercial Road

, London, E14 7HS

Asking Price £625,000

Franklyn James is proud to present this stunning share of freehold apartment with views of Canary Wharf and the Limehouse Marina. Perfect for hosting and family-life alike, the home boasts ample family accommodation and light-filled internal living space with ceiling heights of 2.7m.

At the heart of the home is a spacious kitchen which features a walk-in larder. The layout also boasts a master bedroom with ensuite, further double bedroom and a spacious family bathroom as well as a private balcony with breathtaking views of Canary Wharf, and an allocated parking space in a private garage (shared with one other flat). The flat features exclusive access to a large attic, ideal for expansive storage.

Wonderful parks, pubs and restaurants are abundant in the area with easy access to Bethnal Green, Mile End, Victoria Park, Shoreditch and Hackney. The home also has incredible transport links. A bus stop on the doorstep, 3 min walk to Limehouse DLR, 10 min walk to the Jubilee or Elizabeth Line and Canary Wharf pier mean that Greenwich, Stratford, Tottenham Court Road and Bank are all equally accessible.

If you enjoy London but are looking for a space to unwind and enjoy family and friends, do not miss out on this unique opportunity.

## Viewing

Please contact our Westferry Sales Office on 02070056080 if you wish to arrange a viewing appointment for this property or require further information.

- Stunning apartment
- Share of freehold
- Immaculately presented
- Allocated parking
- Engineered wood throughout
- Balcony with stunning views
- Ample storage space
- Top Floor Flat



Franklyn James



Floor Plan

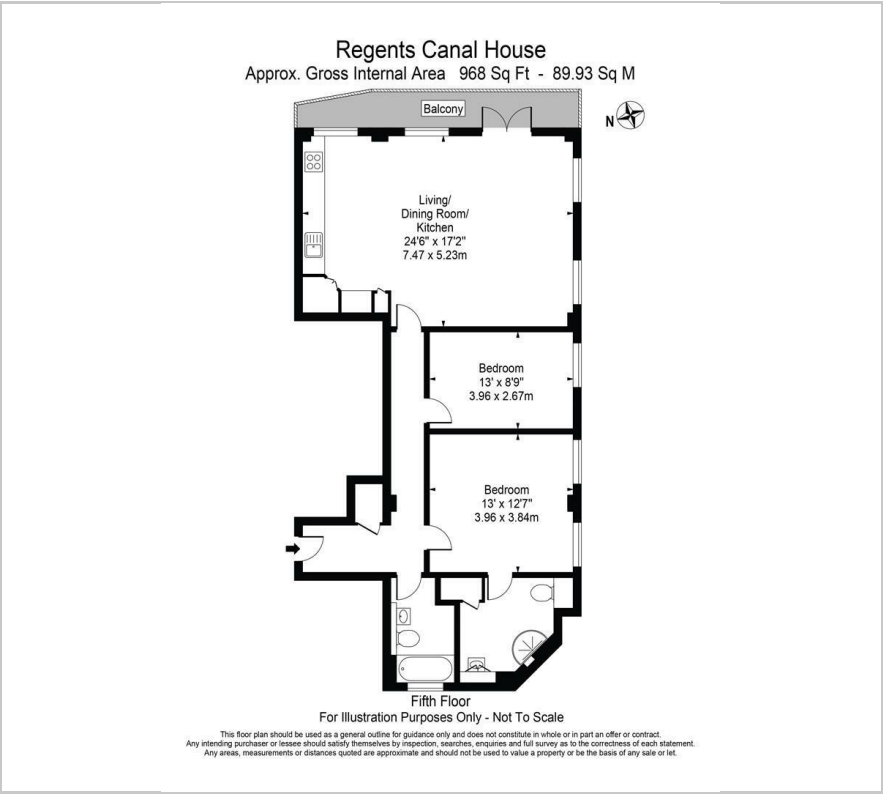

Area Map



Energy Efficiency Graph

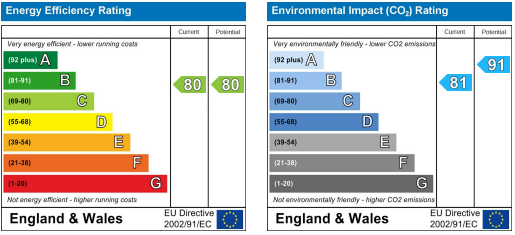

These particulars, whilst believed to be accurate are set out as a general outline only for guidance and do not constitute any part of an offer or contract. Intending purchasers should not rely on them as statements of representation of fact, but must satisfy themselves by inspection or otherwise as to their accuracy. No person in this firms employment has the authority to make or give any representation or warranty in respect of the property.