

Franklyn James



1 Maritime Quay

Isle of dogs, London, E14 3QE

Asking Price £475,000

Share of freehold.

Enjoy stunning views of the river Thames this summer from the large terrace of this attractive apartment in the much sought-after Maritime Quay. Accommodation comprises main entrance with lift, entrance hall, open-plan reception/dining room with access onto terrace, separate kitchen, master bedroom with access onto terrace and en suite shower room, second bedroom and main bathroom. Situated on the first floor, this two double bedroom home would make a fantastic first time buy or investment opportunity.

Please note, the property has been extensively refurbished to include a new kitchen and white goods, new flooring and fully repainted.

Located on a private road in the popular Maritime Quay development, the property is perfectly positioned for the Thames Clipper service and Island Gardens DLR station which both provide great transport links into the City and Canary Wharf.

- Two double bedrooms
- Side aspect river views
- Gated allocated parking
- Large terrace
- Recently re-decorated
- New kitchen and white goods
- New flooring
- No chain
- Share of freehold
- EWS1 Compliant

Viewing

Please contact our Westferry Sales Office on 02070056080 if you wish to arrange a viewing appointment for this property or require further information.



Floor Plan

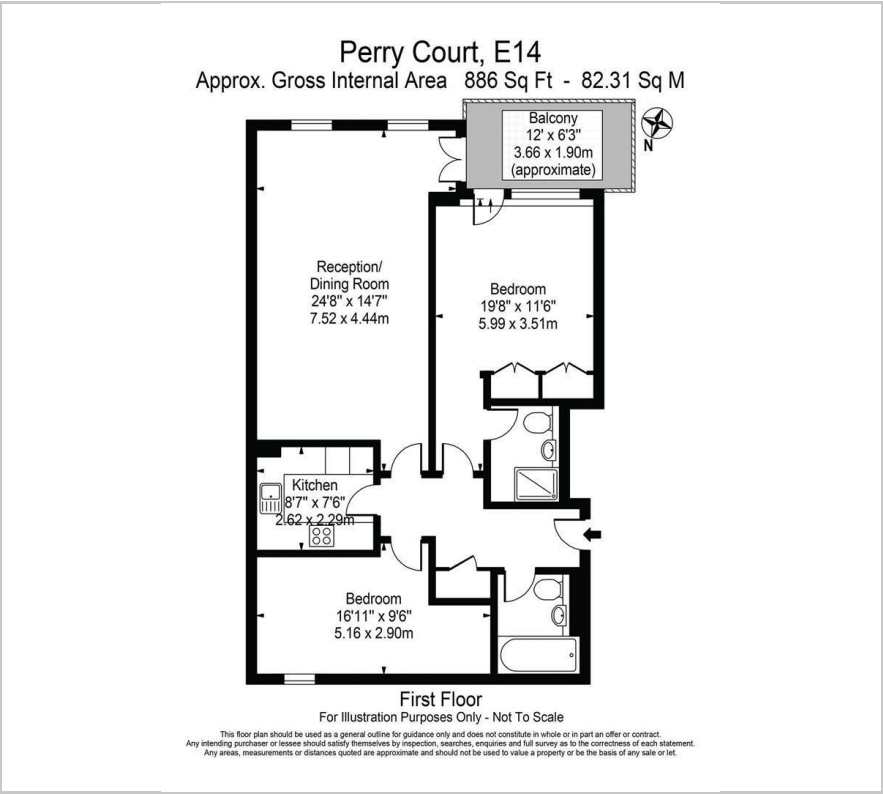

Area Map



Energy Efficiency Graph

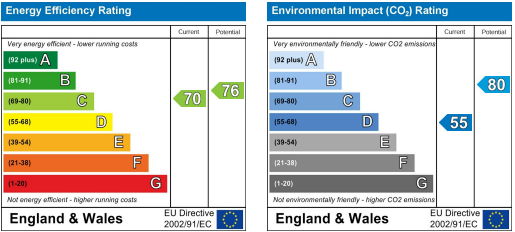

These particulars, whilst believed to be accurate are set out as a general outline only for guidance and do not constitute any part of an offer or contract. Intending purchasers should not rely on them as statements of representation of fact, but must satisfy themselves by inspection or otherwise as to their accuracy. No person in this firm's employment has the authority to make or give any representation or warranty in respect of the property.