

Franklyn James



17 Napier Avenue

Isle of Dogs, London, E14 3QB

£2,275 Per Calendar Month

An attractive two double bedroom apartment in the much sought-after Maritime Quay which includes a secure parking space. Accommodation comprises entrance hall, semi-open plan reception/kitchen with access onto terrace, master bedroom with en suite shower room, second bedroom with access onto private balcony and main bathroom.

Located on a private road in the popular Maritime Quay development, the property is perfectly positioned for the Thames Clipper service and Island Gardens DLR station which both provide great transport links into the City and Canary Wharf.

- Two double bedrooms
- Two bathrooms
- Private balcony
- Large living area
- Secure allocated parking
- Close to Island Gardens DLR station

Viewing

Please contact our Westferry Lettings Office on 02070056080 if you wish to arrange a viewing appointment for this property or require further information.



Floor Plan

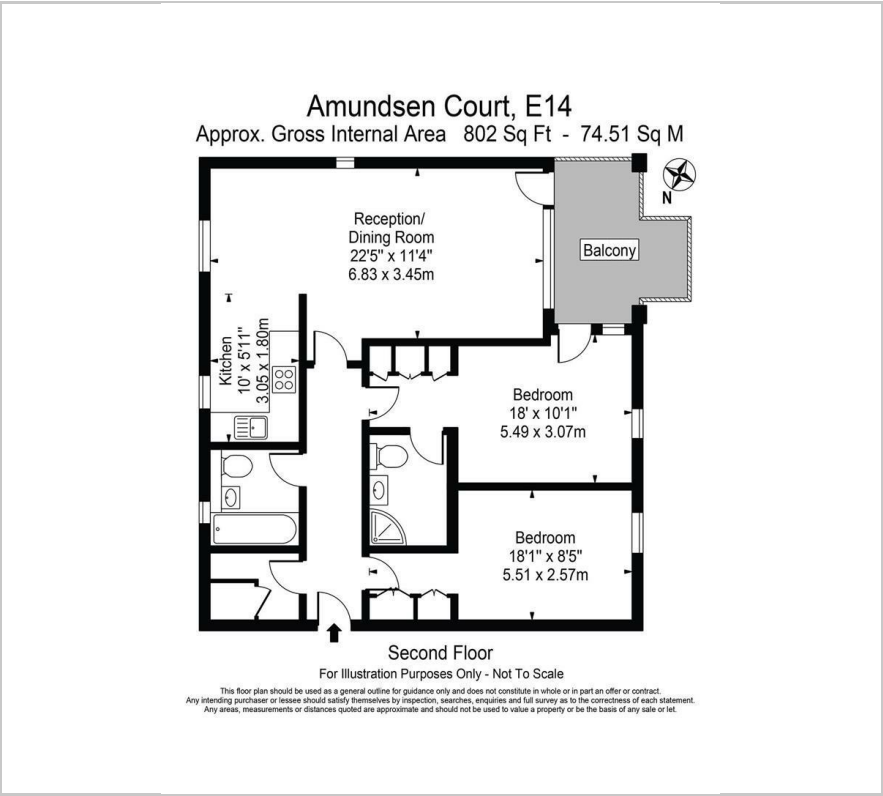

Area Map



Energy Efficiency Graph

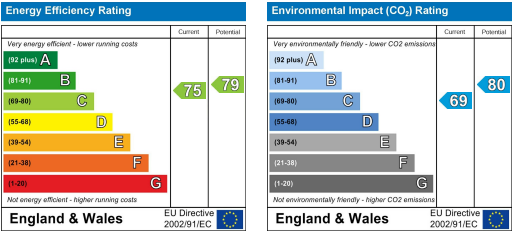

These particulars, whilst believed to be accurate are set out as a general outline only for guidance and do not constitute any part of an offer or contract. Intending purchasers should not rely on them as statements of representation of fact, but must satisfy themselves by inspection or otherwise as to their accuracy. No person in this firms employment has the authority to make or give any representation or warranty in respect of the property.