

# Franklyn James



68 Molesworth Street

, London, SE13 7NZ

Asking Price £425,000

This could be an ideal flat to share with a partner or your first pad to live on your own if you no longer want a flatmate. Perfect if you work in the city or central London as it's only 5 minutes from Lewisham station from where it takes 22 minutes to Victoria and Westminster.

It has a wrap-around private balcony space on the sixth floor, which presents stunning views of London – giving you that WOW feeling every day!

There is also a concierge, perfect for those Amazon deliveries when you are at work or away.

The flat is in perfect condition, so you will not need to do any work on it. Just bring your furniture and pop the champagne open (on that lovely balcony of course).

Located in the sought-after Riverdale House development. The property boasts a spacious and bright open-plan kitchen and reception area which is complemented. It features two generous size double bedrooms and a modern bathroom equipped with both a bath and a shower.

An additional feature includes access to a beautifully landscaped garden on the rooftop terrace.

- Unfurnished
- Available NOW
- Spacious two double bedrooms
- One bathroom
- Concierge service
- Wrap around balcony
- Communal Roof Terrace
- Ample storage
- Walking distance to Lewisham high street
- Moments away from Lewisham DLR and Train Station

## Viewing

Please contact our Westferry Sales Office on 02070056080 if you wish to arrange a viewing appointment for this property or require further information.





Floor Plan

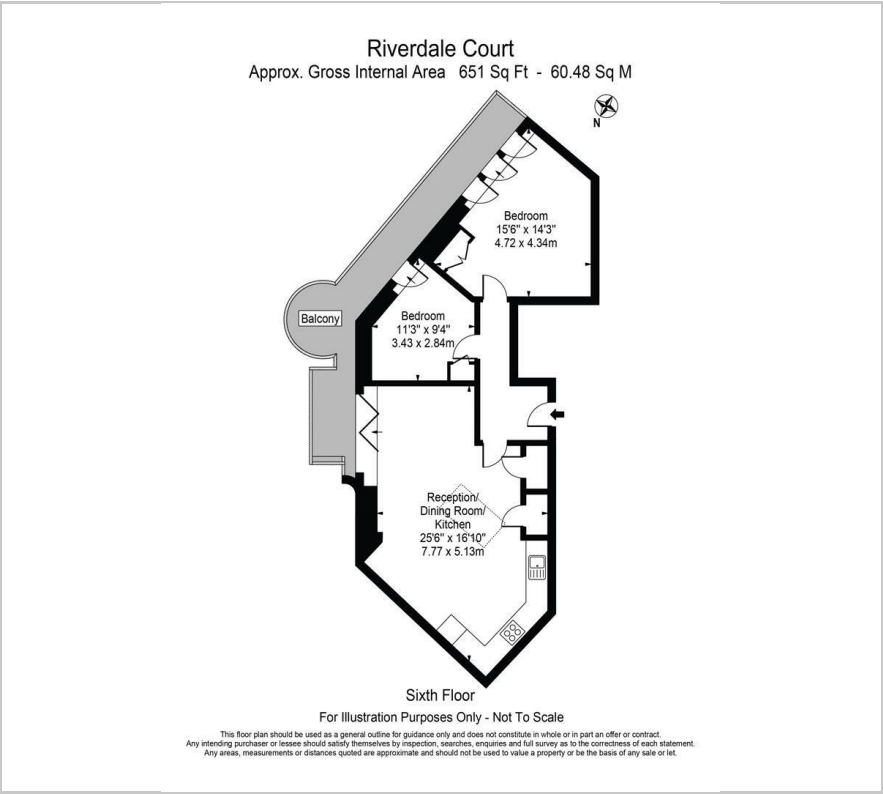

Area Map



Energy Efficiency Graph

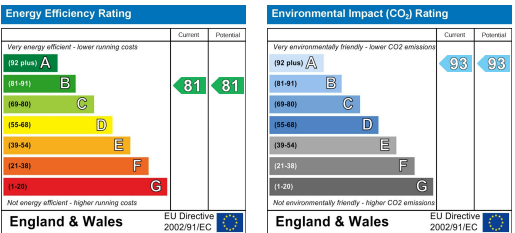

These particulars, whilst believed to be accurate are set out as a general outline only for guidance and do not constitute any part of an offer or contract. Intending purchasers should not rely on them as statements of representation of fact, but must satisfy themselves by inspection or otherwise as to their accuracy. No person in this firms employment has the authority to make or give any representation or warranty in respect of the property.