

# Franklyn James



## 60 Westferry Road, Isle Of Dogs

, E14 8JF

£575,000

Nestled along the banks of the River Thames, Ocean Wharf is a secure, gated development offering luxury living within close proximity to Canary Wharf. This elegant two-bedroom apartment spans approximately 887 sq ft and showcases a contemporary design with numerous tasteful upgrades. The apartment features an expansive entrance hall with ample fitted storage, leading into a spacious open-plan living area. The living space includes a modern kitchen equipped with integrated appliances and opens onto a large, south-facing private balcony.

Residents of Ocean Wharf benefit from a concierge service, a private riverside garden ideal for social gatherings and barbecues, access to a bike shed, and a secure underground parking bay.

Ocean Wharf is ideally situated near Canary Wharf, providing easy access to a vibrant array of shops, bars, and restaurants. The property is conveniently located 0.8 miles from the Canary Wharf Jubilee Line and 0.5 miles from South Quay DLR, ensuring excellent transport links throughout London. The newly opened Elizabeth line further enhances connectivity, offering swift travel across the Capital and to Heathrow Airport in just 45 minutes. Additionally, there is a bus stop just outside the development with routes into Canary Wharf, and riverboat services are a short distance away.

- GATED RIVERSIDE DEVELOPMENT
- CONCIERGE
- BALCONY
- NO ONWARD CHAIN
- 915 SQFT OF LIVING SPACE
- NEUTRAL DECOR THROUGHOUT
- PARKING

### Viewing

Please contact our Westferry Sales Office on 02070056080 if you wish to arrange a viewing appointment for this property or require further information.



2



2



1



C

# Floor Plan

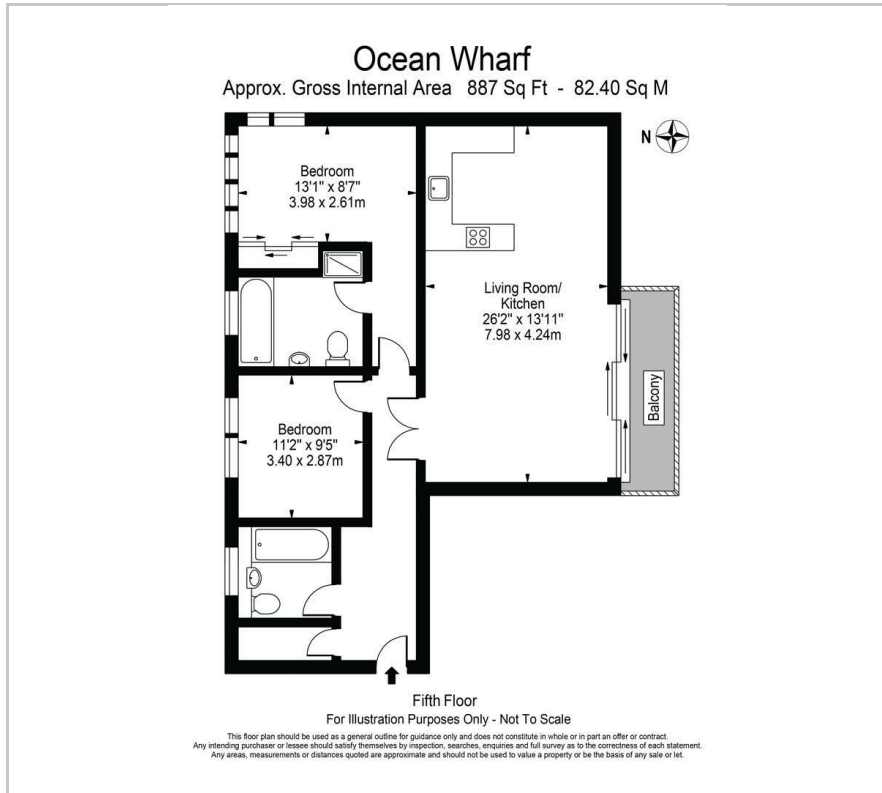

# Area Map



# Energy Efficiency Graph

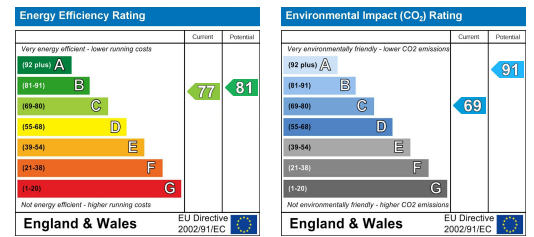

These particulars, whilst believed to be accurate are set out as a general outline only for guidance and do not constitute any part of an offer or contract. Intending purchasers should not rely on them as statements of representation of fact, but must satisfy themselves by inspection or otherwise as to their accuracy. No person in this firm's employment has the authority to make or give any representation or warranty in respect of the property.