

Franklyn James



26 East Tenter Street

, London, E1 8DN

Asking Price £310,000

Fantastic Investment Property Near the City Centre!

No onward chain. This stylish raised ground floor apartment in a beautiful late Victorian conversion boasts a modern open-plan layout. Featuring a well-equipped kitchen, a cozy bedroom at the back, and a bathroom, this property offers a comfortable living space. Additionally, the flat includes the exclusive benefit of a private rear garden.

Conveniently located within walking distance of Bank, this property is surrounded by a variety of restaurants, cafes, and shops, all just a two-minute stroll away. With landmarks like Tower Hill and Spitalfields market in close proximity, this area is rich in local attractions.

Transport links are excellent, with easy access to Tower Hill, Aldgate, Aldgate East, Tower Gateway, and Fenchurch Street stations, providing connections to various tube lines and overground services.

Don't miss this opportunity to own a gem in an extremely quiet yet vibrant neighborhood!

- No Onward Chain
- Excellent condition throughout
- Enviably Located
- Private Garden
- Long Lease 959 years
- One Bedroom
- No Ground Rent
- Ideal for first time buyer or investors
- Walking Distance to Aldgate Station

Viewing

Please contact our Westferry Sales Office on 02070056080 if you wish to arrange a viewing appointment for this property or require further information.



Floor Plan

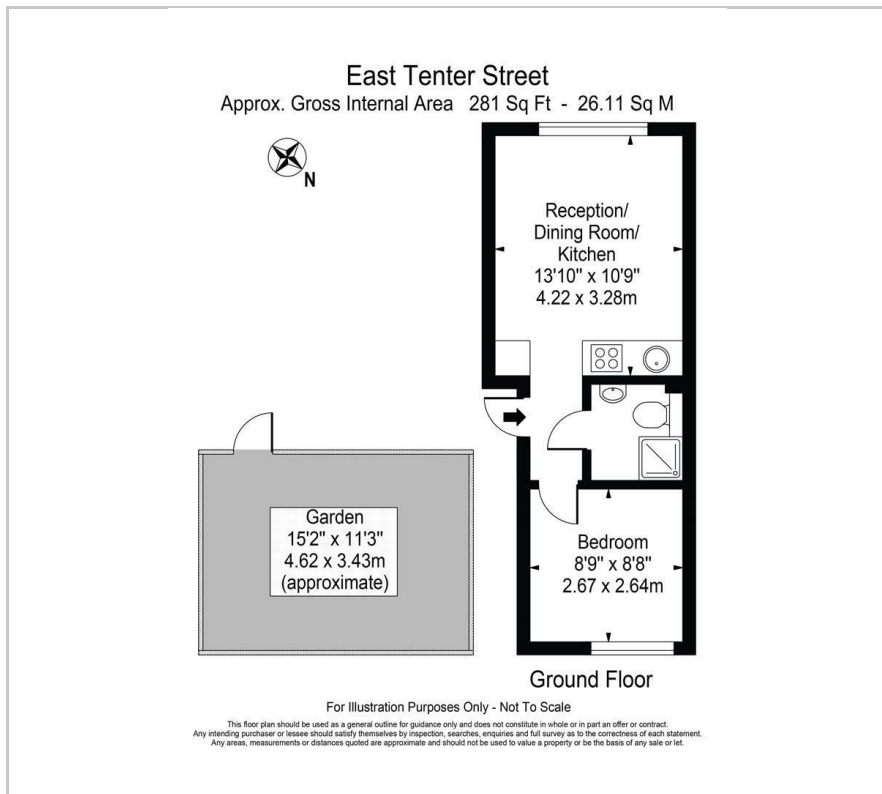

Area Map



Energy Efficiency Graph

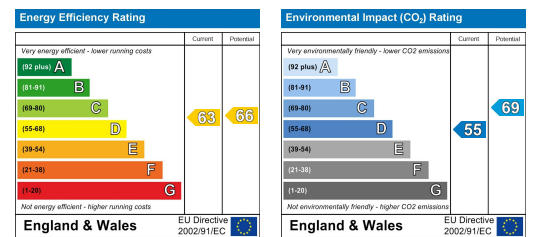

These particulars, whilst believed to be accurate are set out as a general outline only for guidance and do not constitute any part of an offer or contract. Intending purchasers should not rely on them as statements of representation of fact, but must satisfy themselves by inspection or otherwise as to their accuracy. No person in this firm's employment has the authority to make or give any representation or warranty in respect of the property.