

# Franklyn James



## 3 Lawn House Close Canary Wharf, London, E14 9YG £2,200 Per Calendar Month

Located on the raised ground floor is this stunning one bedroom apartment which benefits from direct views of the dock and Canary Wharf. The property is offered on a furnished basis and has a spacious lounge leading onto a private balcony, separate fully fitted kitchen, double bedroom with ample storage and main shower room.

The development is within walking distance to Canary Wharf and all its amenities along with South Quay DLR station. An allocated parking space is also available at additional cost.

- Offered furnished
- Large double bedroom apartment
- Separate fully fitted kitchen
- Direct views of the dock
- Private balcony
- Excellent decorative order
- Secure underground parking available at additional cost
- Abundance of natural light
- Easy access into the City
- Walking distance to Canary Wharf

Please contact our Westferry Lettings Office on 02070056080 if you wish to arrange a viewing appointment for this property or require further information.



1



1



1



C



# Floor Plan

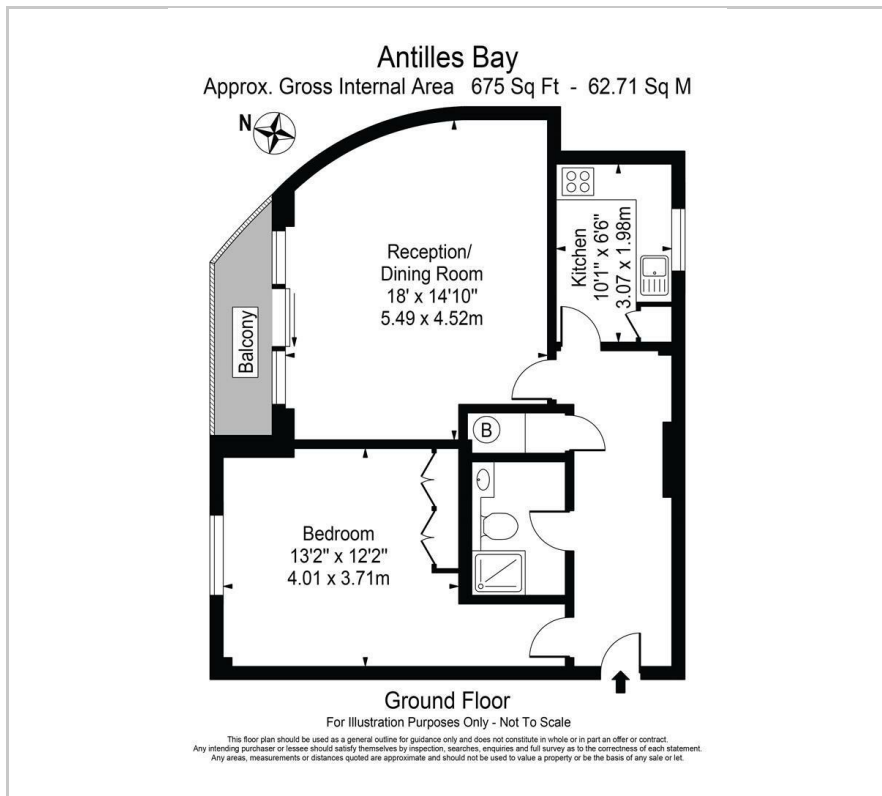

# Area Map



# Energy Efficiency Graph

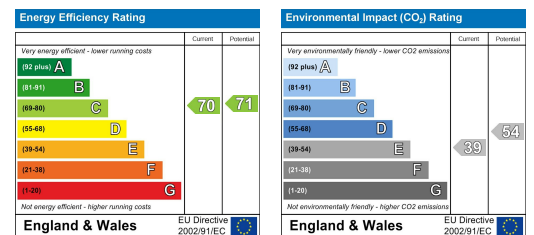

These particulars, whilst believed to be accurate are set out as a general outline only for guidance and do not constitute any part of an offer or contract. Intending purchasers should not rely on them as statements of representation of fact, but must satisfy themselves by inspection or otherwise as to their accuracy. No person in this firm's employment has the authority to make or give any representation or warranty in respect of the property.