

# Franklyn James



## 11 Keymer Place

, London, E14 7QZ

£450,000

A stylish 2-bed, 1-bath apartment located in a private gated development with secure underground parking. The apartment features an open plan lounge/kitchen with high spec integrated appliances, wooden floors and neutral decor throughout, while the cozy bedrooms are carpeted and come with built-in wardrobes. The well-maintained interiors provide a contemporary living space, ideal for relaxation and entertaining as well as having a large private balcony.

The development offers exceptional amenities including an onsite concierge, video security, and a residents-only roof terrace. Conveniently situated within a few minutes' walk to Westferry and Limehouse DLR stations for easy access to Bank and The City. Additionally, the Elizabeth Line from Canary Wharf offers fast access to London's key areas and Heathrow airport.

- LUXURY APARTMENT
- UNDERGROUND ALLOCATED PARKING
- PRIVATE GATED DEVELOPMENT
- EXCELLENT LOCATION
- MODERN INTERIORS
- LARGE BALCONY
- LONG LEASE
- EPC RATING B

### Viewing

Please contact our Westferry Sales Office on 02070056080 if you wish to arrange a viewing appointment for this property or require further information.





# Floor Plan

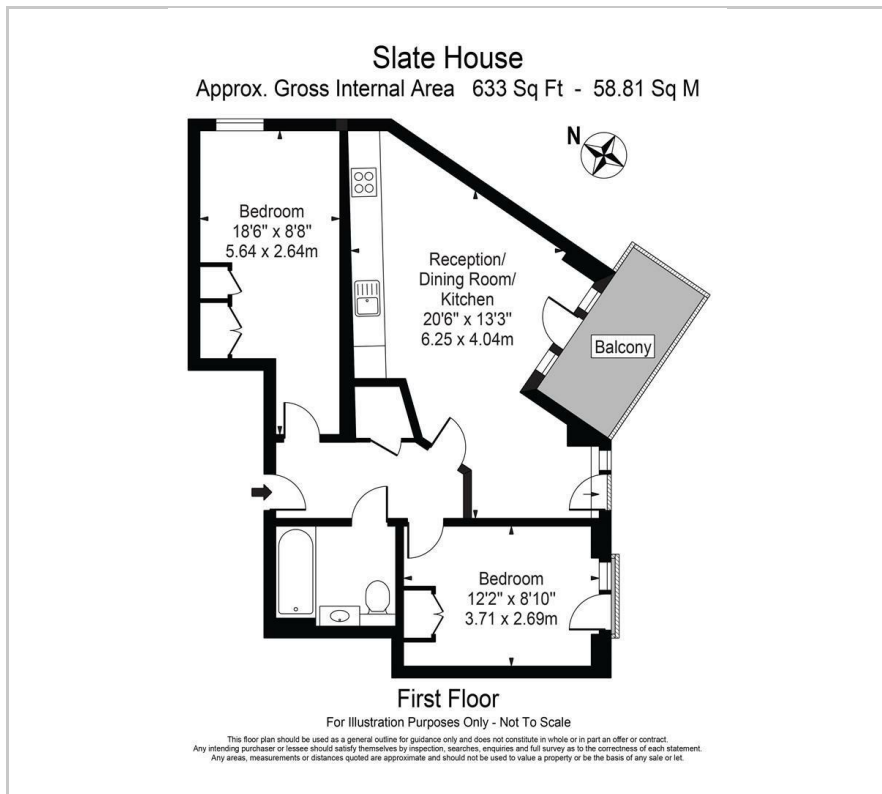

# Area Map

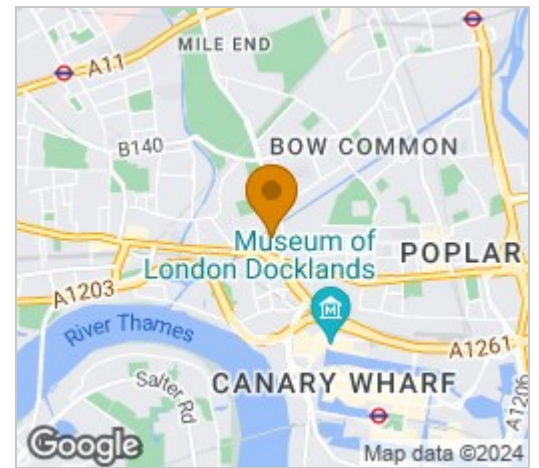

# Energy Efficiency Graph

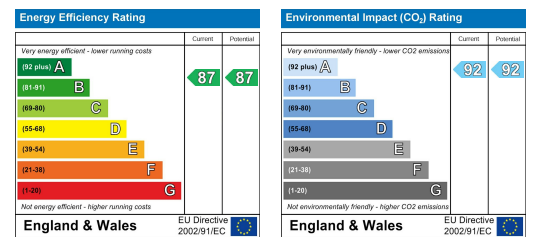

These particulars, whilst believed to be accurate are set out as a general outline only for guidance and do not constitute any part of an offer or contract. Intending purchasers should not rely on them as statements of representation of fact, but must satisfy themselves by inspection or otherwise as to their accuracy. No person in this firm's employment has the authority to make or give any representation or warranty in respect of the property.