

Franklyn James



Harbinger Road

London, E14 3AA

£600,000

This delightful two-bedroom period terraced house exudes character and retains several original features, offering the perfect blend of historical charm and modern convenience. The accommodation is beautifully arranged over two floors, with good-size rooms throughout, a large first-floor bathroom and a secluded tranquil garden. In a quiet road, the property boasts convenient access to a range of nearby amenities, lovely parks and Mudchute Farm and is a three-minute walk from the Thames. Excellent transport options via the DLR and TfL network are within easy reach, with Canary Wharf and Mudchute DLR stations a short distance away, ensuring effortless connectivity to the heart of the city.

- CHAIN FREE
- PERIOD PROPERTY
- ORIGINAL FEATURES
- TRANQUIL GARDEN
- ORIGINAL FLOORBOARDS
- FREEHOLD
- EXCELLENT TRANSPORT LINKS INTO CANARY WHARF AND THE CITY
- SPACIOUS THROUGHOUT

Please contact our Westferry Sales Office on 0207 005 6080 if you wish to arrange a viewing appointment for this property or require further information.



Floor Plan

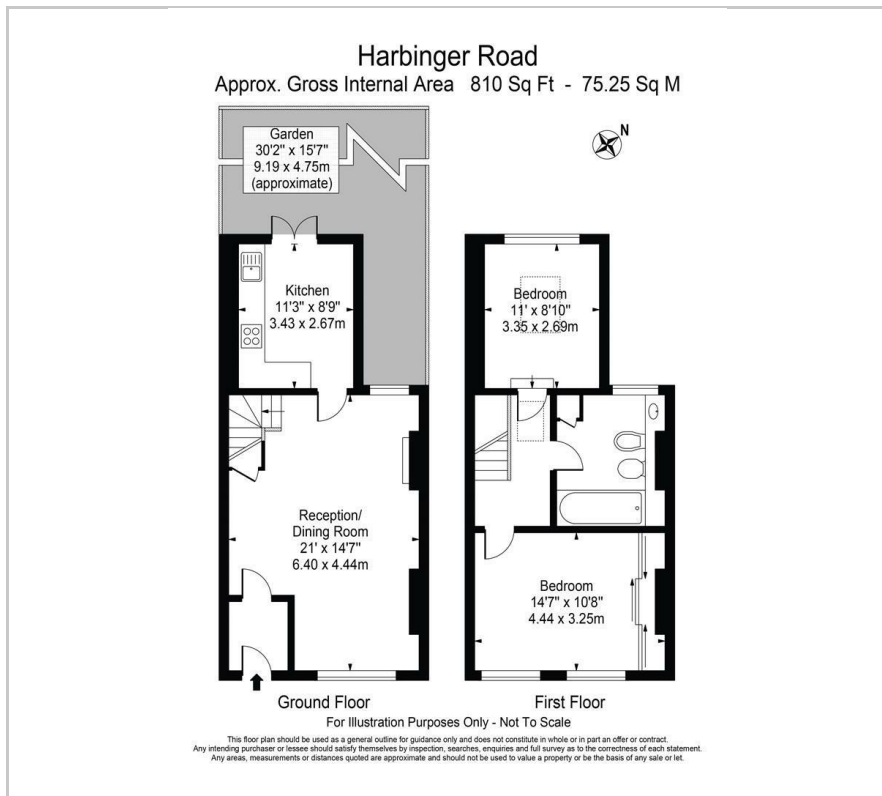

Area Map



Energy Efficiency Graph

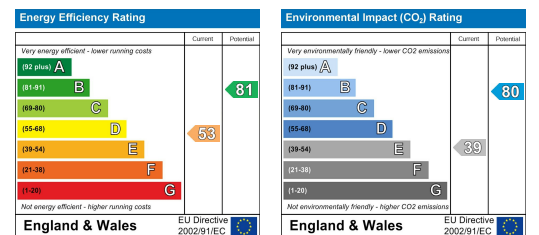

These particulars, whilst believed to be accurate are set out as a general outline only for guidance and do not constitute any part of an offer or contract. Intending purchasers should not rely on them as statements of representation of fact, but must satisfy themselves by inspection or otherwise as to their accuracy. No person in this firm's employment has the authority to make or give any representation or warranty in respect of the property.