

# Franklyn James



## 84 Stainsby Road

, London, E14 6JD

£525,000

Situated in a modern development, this property boasts a spacious reception, kitchen from the lounge there are double doors which lead onto generous private terrace with views over Bartlett Park.

The kitchen is ultra-modern and recently fitted with integrated appliances Spacious main double bedroom benefitting from built-in wardrobes. Bright and airy second bedroom with also benefitting from a fitted wardrobe.

This apartment is just a stone's throw away from the thriving Canary Wharf district, home to a plethora of bars, restaurants, and shops.

Within a short walk of West-ferry DLR station, residents benefit from direct connections to The City and the Elizabeth Line Station at Canary Wharf, making this the perfect base for city commuters.

- Prime location
- Great views over Bartlett Park
- Generous private terrace
- East access to Canary and the City of London
- Ideal for first time buyers
- Long lease
- Generous living accommodation
- Must see
- New boiler as of May 2024
- New bathroom as of 2022

### Viewing

Please contact our Westferry Sales Office on 02070056080 if you wish to arrange a viewing appointment for this property or require further information.



2



1



1



B

# Floor Plan

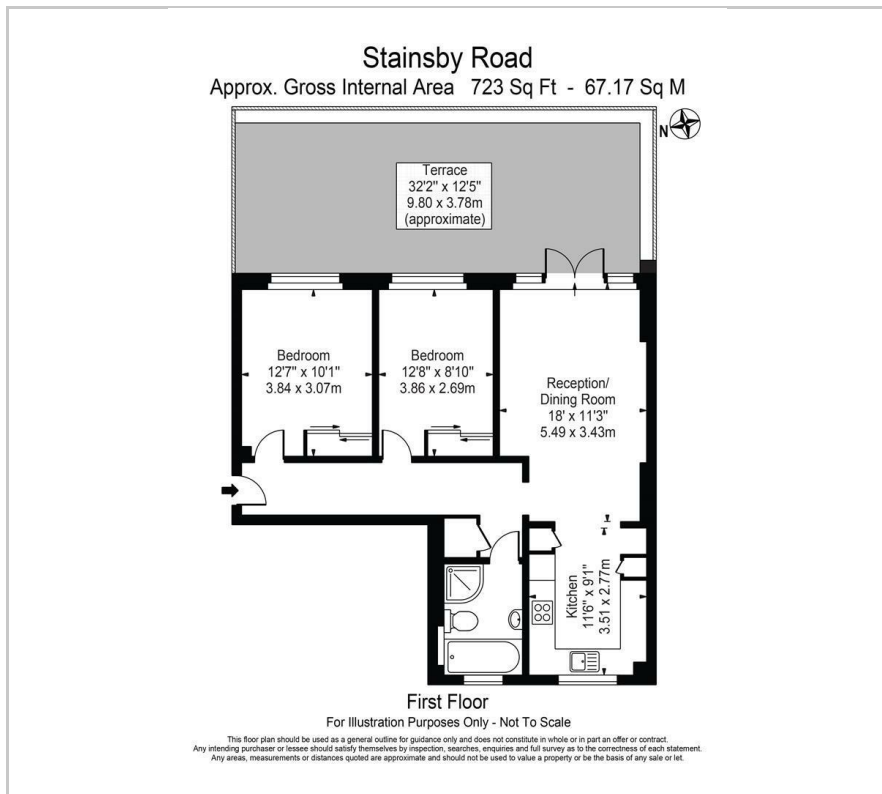

# Area Map

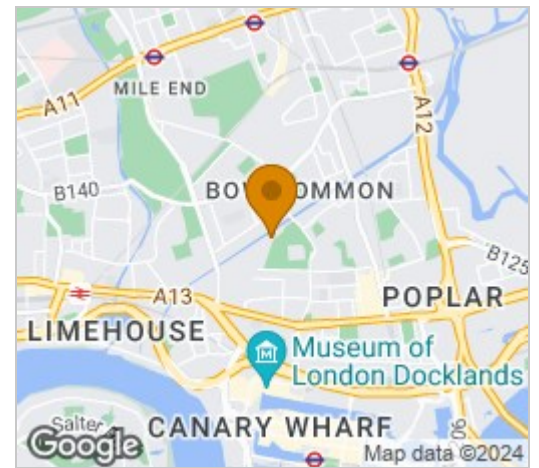

# Energy Efficiency Graph

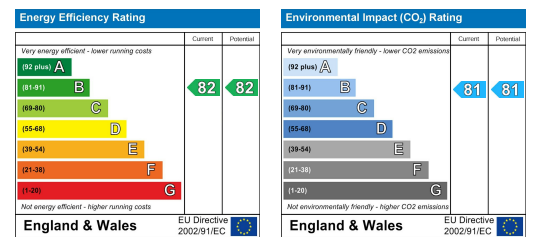

These particulars, whilst believed to be accurate are set out as a general outline only for guidance and do not constitute any part of an offer or contract. Intending purchasers should not rely on them as statements of representation of fact, but must satisfy themselves by inspection or otherwise as to their accuracy. No person in this firm's employment has the authority to make or give any representation or warranty in respect of the property.