

Franklyn James



Franklyn James

Galaxy Building

5 Crews Street, London, E14 3SP

Offers In Excess Of £550,000

An impressive two bedroom apartment in the desirable Galaxy building, part of the Odyssey development. The property offers approximately 1,100 sq. ft. of living space, and benefits from a large lounge with access to an outside patio, fully equipped kitchen with integrated appliances, a master bedroom with en-suite shower room and built-in wardrobes, a large second bedroom, a family bathroom and comes with a parking space. The Odyssey development offers a 24 concierge service and a residents' gym.

Galaxy Building is situated within minutes walking distance to Canary Wharf and many of the elite shops, bars dock-side attractions and restaurants. Local transport links include Mudchute & Crossharbour (DLR) & Canary Wharf Station (Jubilee Line, Cross Rail & DLR) within a short walking distance as well as many quick routes into and out of London for the motorist.

- Two double bedrooms
- Two bathrooms
- Large private patio
- Parking
- 24 hour concierge
- Residents' gym
- Chain Free
- 1100 sqft

Viewing

Please contact our Westferry Lettings Office on 02070056080 if you wish to arrange a viewing appointment for this property or require further information.

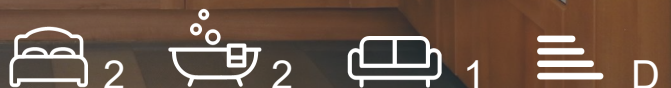

Franklyn James

Floor Plan

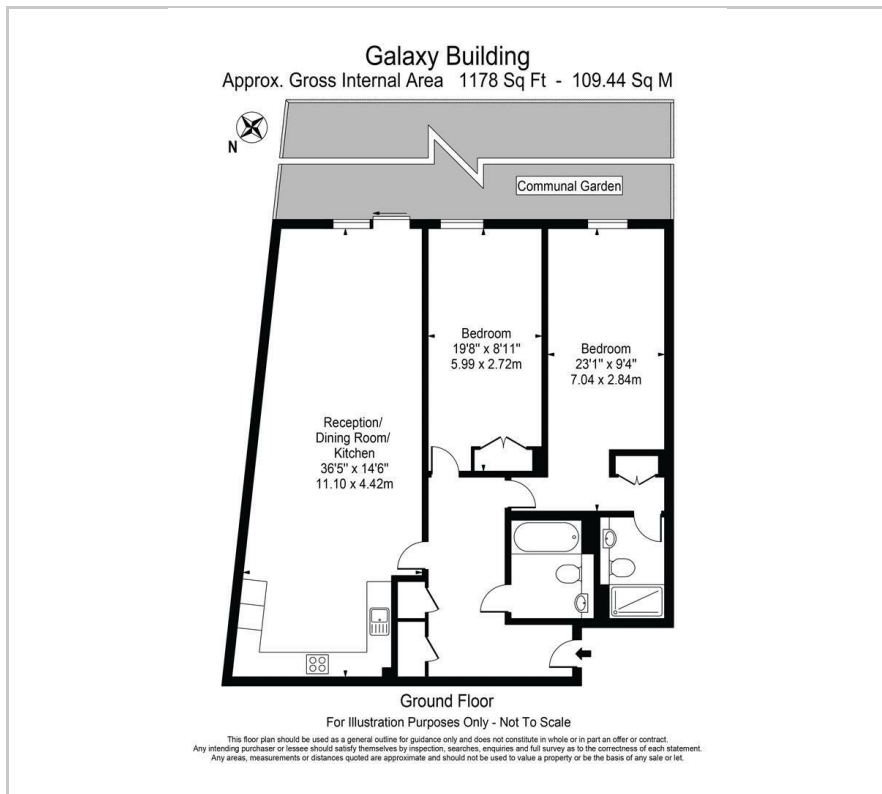

Area Map



Energy Efficiency Graph

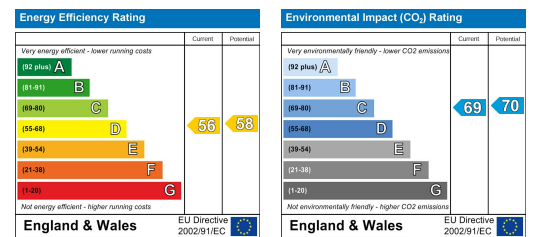

These particulars, whilst believed to be accurate are set out as a general outline only for guidance and do not constitute any part of an offer or contract. Intending purchasers should not rely on them as statements of representation of fact, but must satisfy themselves by inspection or otherwise as to their accuracy. No person in this firm's employment has the authority to make or give any representation or warranty in respect of the property.