

Franklyn James



Marshfield Street

, London, E14 3HJ

£400,000

Offered with no onward chain is this beautiful 3-bedroom ground floor and first-floor maisonette, boasting a delightful garden and presented in impeccable decorative condition. This inviting property features generously proportioned rooms throughout, offering ample space for comfortable living. Whether relaxing in the cozy living areas or entertaining guests in the well-appointed kitchen and dining spaces, this home provides a perfect blend of functionality and style.

Located minutes from Crossharbour DLR station and being close to the local eateries and amenities on Pepper St. The property is an easy commute to the centre of Canary Wharf with its plethora of shops, bars & eateries and excellent transport links with it's Jubilee and Elizabeth line stations.

- NO ONWARD CHAIN
- 3 bedroom maisonette
- Private garden
- Generously sized rooms throughout
- Many local amenities
- Various transportation links into the city

Viewing

Please contact our Westferry Sales Office on 02070056080 if you wish to arrange a viewing appointment for this property or require further information.



Floor Plan

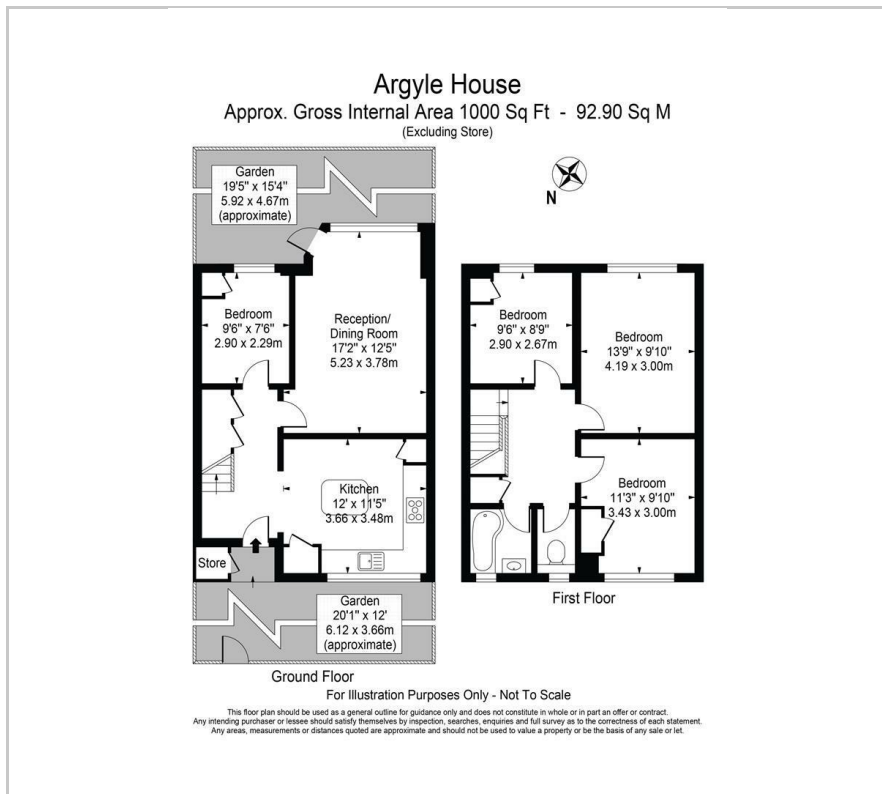

Area Map



Energy Efficiency Graph

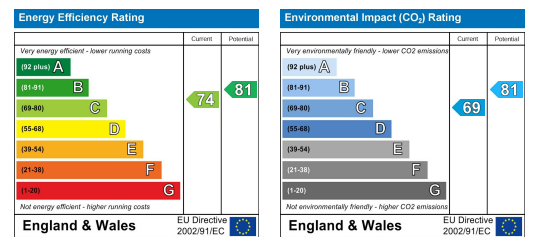

These particulars, whilst believed to be accurate are set out as a general outline only for guidance and do not constitute any part of an offer or contract. Intending purchasers should not rely on them as statements of representation of fact, but must satisfy themselves by inspection or otherwise as to their accuracy. No person in this firm's employment has the authority to make or give any representation or warranty in respect of the property.