

Franklyn James



Plover Way

, London, SE16 7TS

Offers In The Region Of £375,000

Offered with no onward chain- A stunning one-bedroom waterside apartment nestled in the heart of Surrey Quays. Situated just moments away from the station and an array of convenient amenities, this contemporary dwelling offers a perfect blend of comfort, convenience, and scenic views.

This stylish apartment boasts a spacious bedroom, a modern bathroom, and a well-appointed kitchen equipped with top-notch appliances. The open-plan living area provides a relaxing space to unwind, entertain, or simply soak in the serene waterfront vistas.

Located in a vibrant neighbourhood, residents have easy access to local shops, restaurants, and leisure facilities. The proximity to Surrey Quays station ensures effortless commuting, connecting you to various parts of London swiftly.

- No onward chain
- Waterside development
- Close to Surrey Quays DLR Station
- Moments away from local amenities
- Has a generous sized bedroom
- Modern bathroom

Please contact our Westferry Sales Office on 02070056080 if you wish to arrange a viewing appointment for this property or require further information.



1



1



null



C

Floor Plan

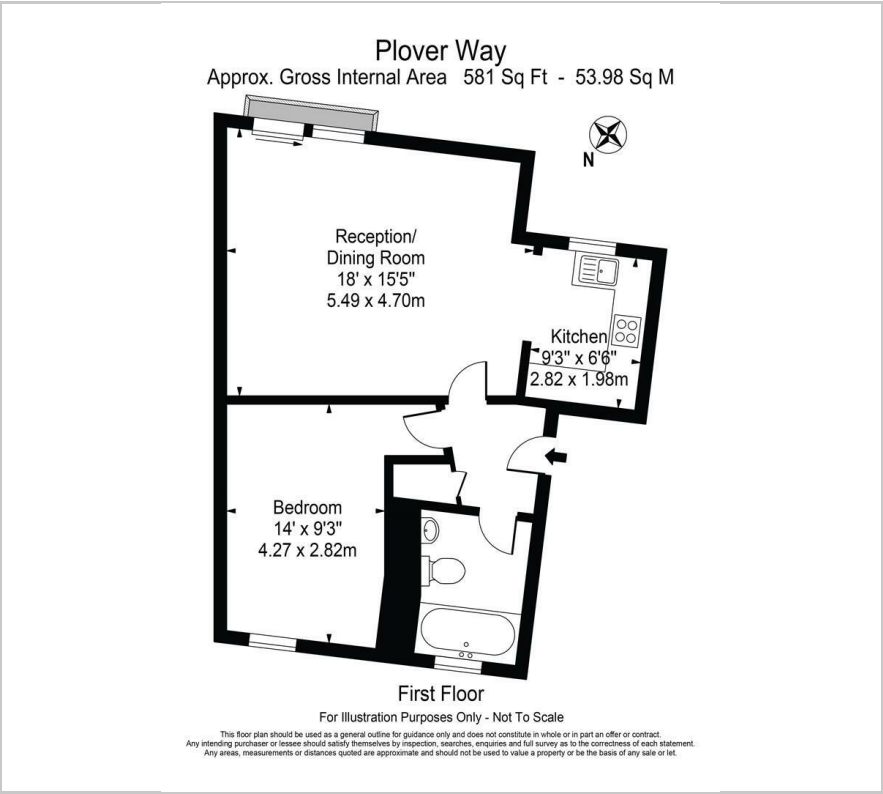

Area Map



Energy Efficiency Graph

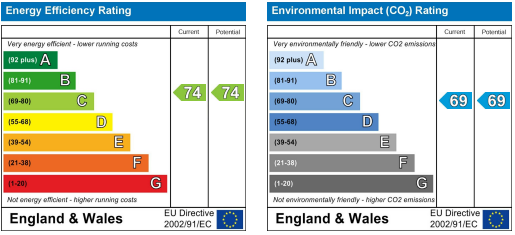

These particulars, whilst believed to be accurate are set out as a general outline only for guidance and do not constitute any part of an offer or contract. Intending purchasers should not rely on them as statements of representation of fact, but must satisfy themselves by inspection or otherwise as to their accuracy. No person in this firms employment has the authority to make or give any representation or warranty in respect of the property.