



12 - 230840 Beech Walk, Adel, Leeds, West Yorkshire, LS16 8NY

£1,850 PCM

SW
RESIDENTIAL

- Detached Four Bedroom Family Home
- Driveway and Double Garage
- Utility Room and Downstairs WC
- En-suite to Master Bedroom
- Unfurnished
- Secluded Cul-De-Sac Location
- High Specification Kitchen
- Gardens to Front and Rear
- Council Tax Band F
- Available for six month fixed term

THE PROPERTY

Welcome to this stunning 4-bedroom detached house located in the sought-after area of Beech Walk, Adel, Leeds. This property boasts a large high-spec kitchen, perfect for whipping up delicious meals for family and friends.

Situated in a peaceful cul-de-sac, this home offers privacy and tranquillity. With parking for 2 vehicles, a large driveway, and a double garage, you'll never have to worry about finding a parking spot again.

The fixed six-month tenancy term gives flexibility to those perhaps seeking a shorter rental commitment. Don't miss out on the opportunity to live in this charming property in one of the most desirable areas in Adel.

Available to make your home from the middle of July.

SITUATION

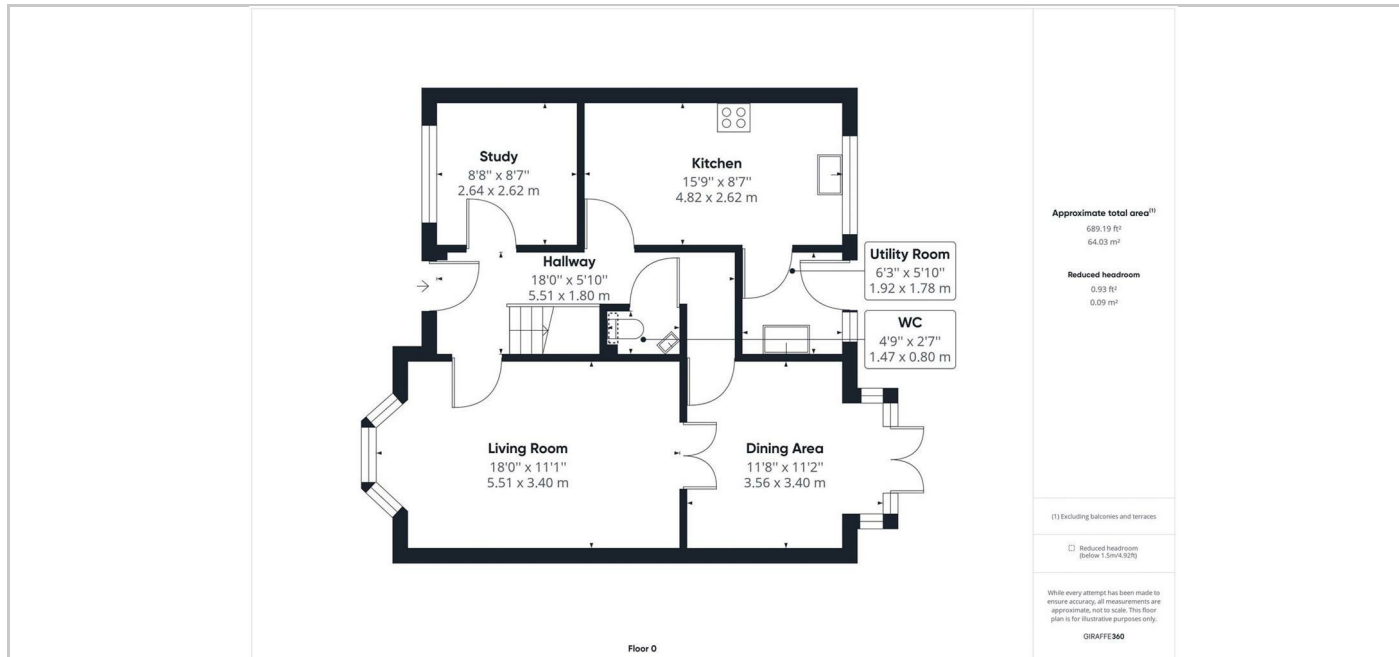

Directions