



3, Church House Church House, Ogleforth, York, YO1 7JN

£2,250 Per Calendar Month

**SW**  
RESIDENTIAL



## THE PROPERTY

Welcome to Church House in the heart of Ogleforth, York! This stunning large two-bedroom apartment on the ground floor offers a spacious and comfortable living space with picturesque views over communal gardens.

As you step into the apartment, you are greeted by a large master bedroom, perfect for relaxing after a long day. The property boasts not just one, but two bathrooms for added convenience.

The apartment comes fully equipped with all white goods included, making your move a breeze. Please note that the furniture shown is for illustration purposes only, allowing you the freedom to decorate and style the space to your taste.

Don't miss out on the opportunity to make this charming apartment your new home. Contact us today to arrange a viewing and experience the beauty of Church House living for yourself!

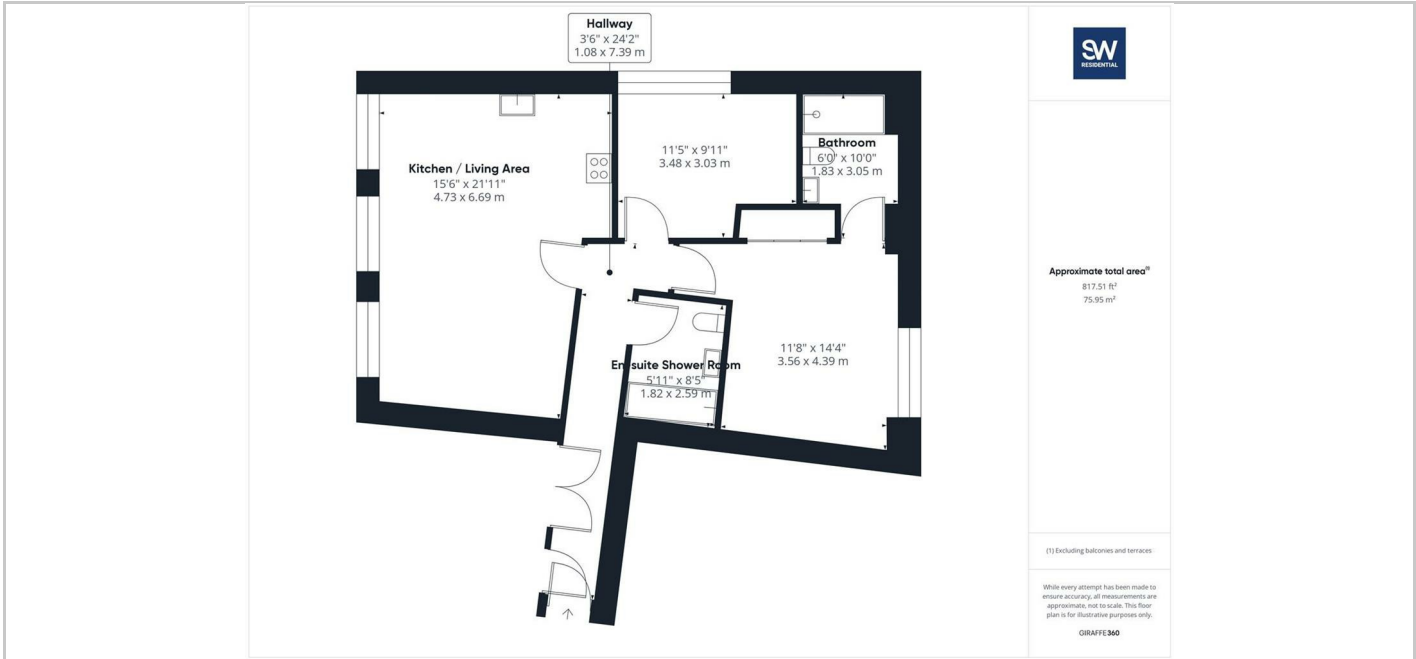

## SITUATION

## Directions

6th Floor Central Square, 29 Wellington Street, West Yorkshire, LS1 4DL  
Tel: 0113 221 6000 Email: residential@sw.co.uk