

Plots 44 Grange Way, Gristhorpe, North Yorkshire, YO14 9FE

£325,000

SW
RESIDENTIAL

- New Build Detached House
- Garage & Driveway
- Spacious kitchen/dining area
- Master bedroom with ensuite
- Three Further bedrooms
- Family bathroom and cloakroom
- Gas Central Heating
- Double Glazed Windows
- Good sized garden
- Country location

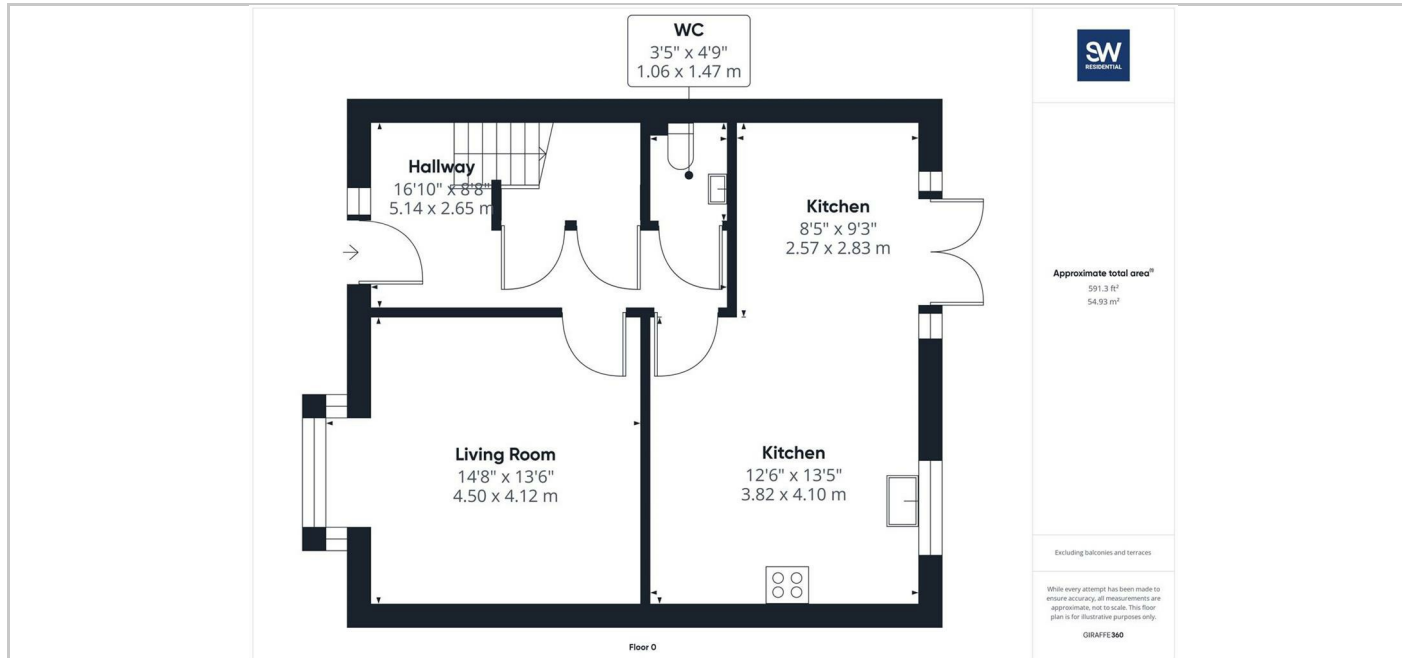

THE PROPERTY

This is a fantastic opportunity to purchase this four bedroom detached property on the Dale Meadows Development. Located in this quaint, charming village is nestled amongst the gently rolling fields and countryside of North Yorkshire. Just a few minutes drive away from the East Coast, the village offers residents the best of country living whilst providing convenient access to the coast, York and motorway network via the A165. All of the homes have a top quality fitted kitchen which is complimented with integral stainless-steel appliances, including an oven, hob, extractor and a double door fridge/freezer unit. All of the sanitary ware is white and contemporary with chrome finished taps, a mixer shower unit over the bath and electric showers to the ensembles. The homes are gas centrally heated, double glazed and have a ten-year LABC guarantee. The accommodation briefly comprises an entrance hallway with storage, spacious front aspect lounge, dining kitchen with French doors leading to the rear garden and downstairs cloakroom. To the first floor is the master bedroom with ensuite shower room, 3 further bedrooms and family bathroom fitted with a white three-piece suite. Outside the home has a garage and driveway along with a good-sized garden to the rear.

SITUATION

Directions