

# HUNTERS®

HERE TO GET *you* THERE



## Riverside Close

London, E5 9ST

£1,995 Per Month



A stunning two bedroom ground floor apartment is ideally placed within a small purpose built development overlooking the River Lea and the benefit of river walks via well-maintained communal gardens.

The property comprises semi open plan kitchen reception room, two double bedrooms, ample storage, bathroom and communal gardens leading to the river tow-path with stunning views across Walthamstow marshes.

Riverside Close is a private residential development located moments from the many bars, restaurants and coffee houses of Chatsworth Road whilst the wide-open spaces of Millfields park and Springfield park are also located close by.

Transport links include, Clapton Station (Overground just three stops to Liverpool Street) and a variety of bus routes into The City and West End.



Area Map

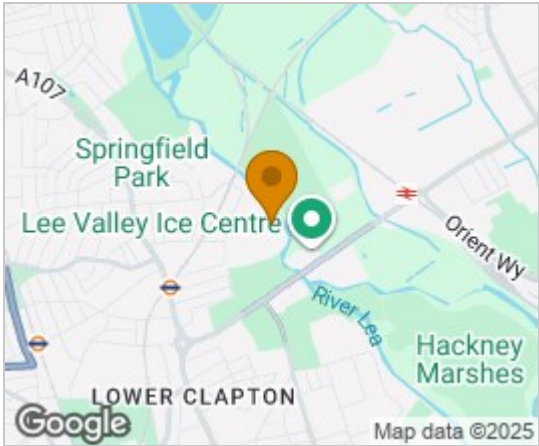

Floor Plans

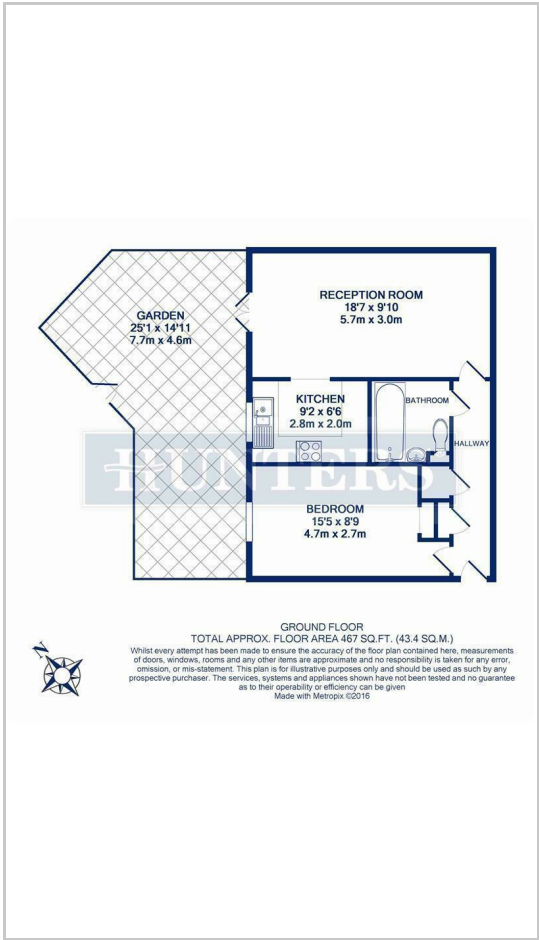

Energy Efficiency Graph

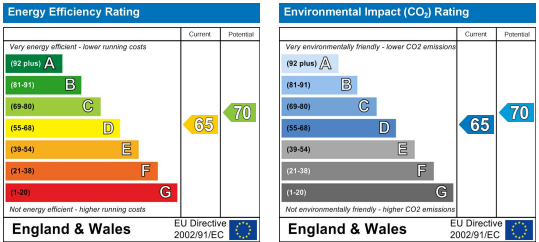

These particulars are intended to give a fair and reliable description of the property but no responsibility for any inaccuracy or error can be accepted and do not constitute an offer or contract. We have not tested any services or appliances (including central heating if fitted) referred to in these particulars and the purchasers are advised to satisfy themselves as to the working order and condition. If a property is unoccupied at any time there may be reconnection charges for any switched off/disconnected or drained services or appliances - All measurements are approximate.

**THINKING OF SELLING?** If you are thinking of selling your home or just curious to discover the value of your property, Hunters would be pleased to provide free, no obligation sales and marketing advice. Even if your home is outside the area covered by our local offices we can arrange a Market Appraisal through our national network of Hunters estate agents.