

# HUNTERS<sup>®</sup>

HERE TO GET *you* THERE



## Crouch End Hill

London, N8 8DE

£2,000 Per Calendar Month



\*\*\* £100.00 PAID TOWARDS YOUR MOVE \*\*\*

A stunning one bedroom, newly refurbished to an excellent standard throughout. This bright one double bedroom flat is presented in excellent condition throughout and benefits from a great location. The property comprises open-plan kitchen lounge, one double bedroom and a stylish bathroom.

Within walking distance from the popular shops and restaurants of Crouch End and only moments away from Crouch Hill and Archway Stations.



Area Map



Floor Plans

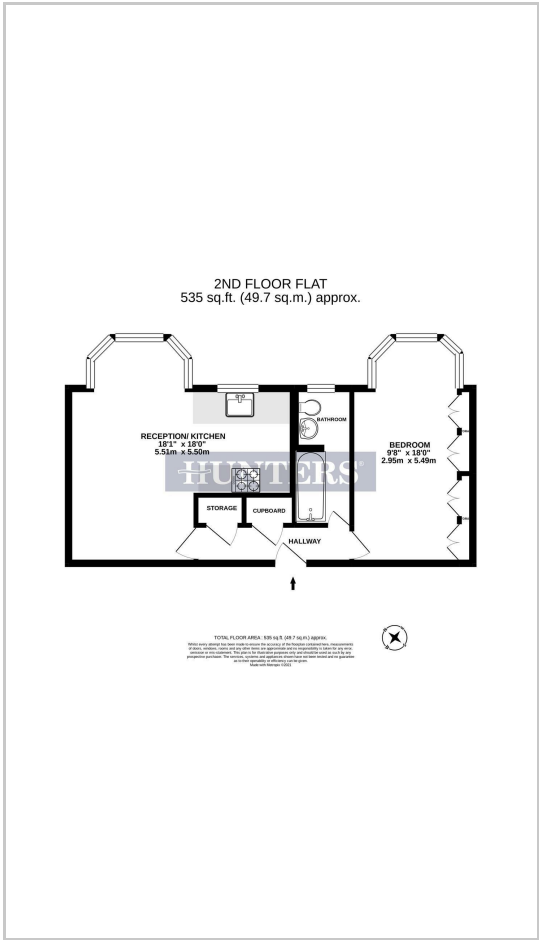

Energy Efficiency Graph



These particulars are intended to give a fair and reliable description of the property but no responsibility for any inaccuracy or error can be accepted and do not constitute an offer or contract. We have not tested any services or appliances (including central heating if fitted) referred to in these particulars and the purchasers are advised to satisfy themselves as to the working order and condition. If a property is unoccupied at any time there may be reconnection charges for any switched off/disconnected or drained services or appliances - All measurements are approximate.

**THINKING OF SELLING?** If you are thinking of selling your home or just curious to discover the value of your property, Hunters would be pleased to provide free, no obligation sales and marketing advice. Even if your home is outside the area covered by our local offices we can arrange a Market Appraisal through our national network of Hunters estate agents.