



Crown Street, Thetford, IP26 4NR

Rent - £230,000 Deposit -

A charming Period cottage built in traditional local materials and boasting comfortable accommodation over three floors including a sitting room, garden room and large kitchen diner. Well presented throughout with a first floor bathroom, LPG (Calor) heating system, double glazing and enclosed rear garden. Viewings recommended.

- CHARMING PERIOD COTTAGE
- SITTING ROOM WITH WOOD BURNER
- GOOD SIZE KITCHEN/DINER
- BATHROOM
- UPVC DOUBLE GLAZING
- ENCLOSED REAR GARDEN
- REAR GARDEN ROOM
- THREE BEDROOMS OVER FIRST & SECOND FLOOR
- GAS (LPG) HEATING
- GARDEN WORKSHOP AND TIMBER SHED



Council Tax Band: B - EPC Rating: G 18



Ground Floor

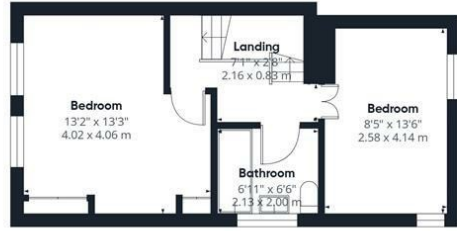

Floor 1



Floor 2

Approximate total area^(*)

957 ft²
89 m²

Reduced headroom

38 ft²
3.5 m²

(*) Excluding balconies and terraces.

Reduced headroom

..... Below 5 ft/1.5 m

While every attempt has been made to ensure accuracy, all measurements are approximate, not to scale. This floor plan is for illustrative purposes only.

Calculations were based on RICS IPMS 3C standard. Please note that calculations were adjusted by a third party and therefore may not comply with RICS IPMS 3C.

GIRAFFE360

