



Elizabeth Road, Brandon, Suffolk, IP27 0EZ

Rent - £150,000 Deposit -

An ideal opportunity for those purchasers seeking a comfortable two bedroom property in this well served and popular town. Offering good sized accommodation and conveniently located for easy access to the towns amenities.

- GOOD SIZED ACCOMMODATION
- MULTI-FUEL BURNER
- CLOSE PROXIMITY TO TOWN CENTRE
- SPACIOUS KITCHEN
- IDEAL INVESTMENT
- DOUBLE GLAZING
- PRIVATE GARDENS
- TWO BEDROOMS
- NON STANDARD CONSTRUCTION
- VIEWINGS RECOMMENDED



Council Tax Band: A - EPC Rating: E 40



Ground Floor

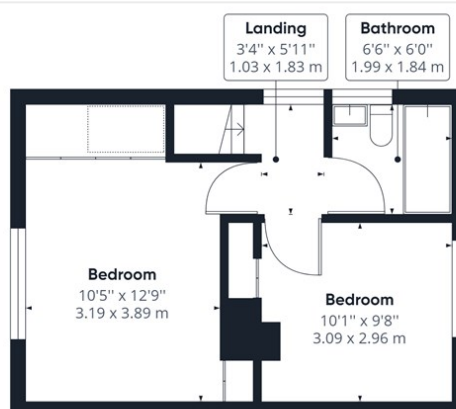

Floor 1

Approximate total area⁽¹⁾
664.67 ft²
61.75 m²

(1) Excluding balconies and terraces

While every attempt has been made to ensure accuracy, all measurements are approximate, not to scale. This floor plan is for illustrative purposes only.

GIRAFFE360

