



Sussex Road, Bury St Edmunds, Suffolk, IP32 6TE

Rent - £210,000 Deposit -

A modern two bedroom semi-detached home occupying a popular residential location this sought after town. The property benefits from a modern bathroom suite, gas central heating, good sized gardens and parking. Offered to the market Chain Free.

- SEMI-DETACHED FAMILY HOME
- LOUNGE
- BATHROOM
- DRIVEWAY
- POPULR LOCATION
- TWO BEDROOMS
- KITCHEN/DINER
- GOOD SIZED GARDENS
- CHAIN FREE
- VIEWING RECOMMENDED



Council Tax Band: B - EPC Rating: D 68

GROUND FLOOR 296 sq. ft.
(27.5 sq. m.)

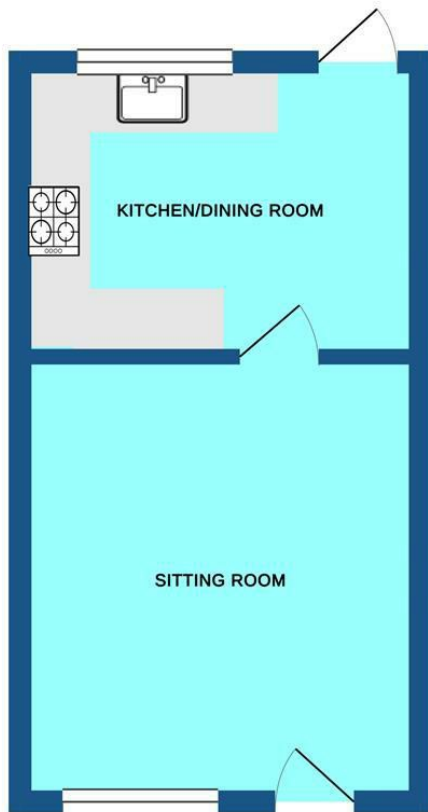

1ST FLOOR 282 sq. ft.
(26.2 sq. m.)

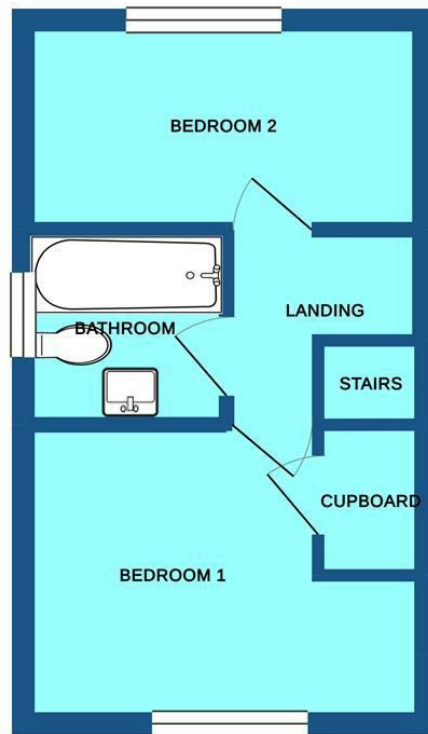

TOTAL FLOOR AREA : 578 sq. ft. (53.7 sq. m.) approx.

Whilst every attempt has been made to ensure the accuracy of the floorplan contained here, measurements of doors, windows, rooms and any other items are approximate and no responsibility is taken for any error, omission or mis-statement. This plan is for illustrative purposes only and should be used as such by any prospective purchaser. The services, systems and appliances shown have not been tested and no guarantee as to their operability or efficiency can be given.
Made with Metropix 6/2019

