

16 Radcliffe Road, West Bridgford, Nottingham, NG2 5FW

£570 Per Week

- AVAILABLE ACADEMIC YEAR 2024/25
- LARGE REAR GARDEN
- 6 DOUBLE BEDROOMS
- Start Date - 18/07
- Council Tax Band - C
- £95 PPPW BASED ON 6 SHARING excluding bills
- THREE STOREY PROPERTY
- Rent Payable in Instalments
- Term open to negotiation
- EPC D



Directions

Viewings

Viewings by arrangement only. Call to make an appointment.

Council Tax Band:

C

EPC Rating:

D

Energy Efficiency Rating		Current	Potential
Very energy efficient - lower running costs			
(92 plus) A			84
(81-91) B			
(69-80) C			
(55-68) D		56	
(39-54) E			
(21-38) F			
(1-20) G			
Not energy efficient - higher running costs			
England & Wales		EU Directive 2002/91/EC	

Approx. 58.4 sq. metres (629.1 sq. feet)

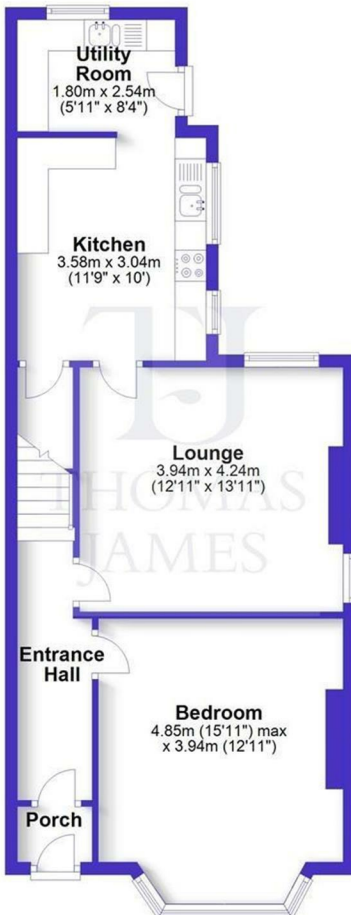

First Floor
Approx. 53.5 sq. metres (575.6 sq. feet)

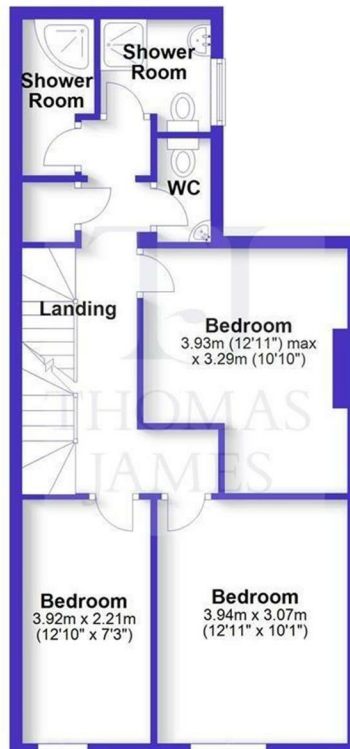

Second Floor
Approx. 43.1 sq. metres (463.7 sq. feet)

