



TK International
020 7794 8700
www.t-k.co.uk

Residential Sales
Residential Lettings
Property Management

Sales Office:
9 Heath Street
Hampstead
London NW3 6TP
E: sales@t-k.co.uk

Lettings Office:
16-18 Heath Street
Hampstead
London NW3 6TE
E: lettings@t-k.co.uk

 tk.international
 TK International
 TK International



Winchester Road Swiss Cottage NW3

An exceptionally bright and spacious two bedroom, two bathroom lateral apartment on the 5th floor of an exclusive modern apartment block, which is served by passenger lifts, a 24 hour concierge desk and the added benefit of a secure underground parking space.

Benefits include a Juliette balcony from the reception room and wonderful far reaching views, only available to apartments situated on the higher floors of this wonderful development.

Visage Apartments is a prestigious modern development in Swiss Cottage, just moments from the underground station (Jubilee Line) in addition to a large gymnasium with swimming pool, GP surgery and pharmacy, and also conveniently located for access to the vast spaces of Primrose Hill and Regents Park.

£4,200 Per Month

SOLE AGENT







Winchester Road, Swiss Cottage, NW3

Approximate Area = 989 sq ft / 91.8 sq m

For identification only - Not to scale

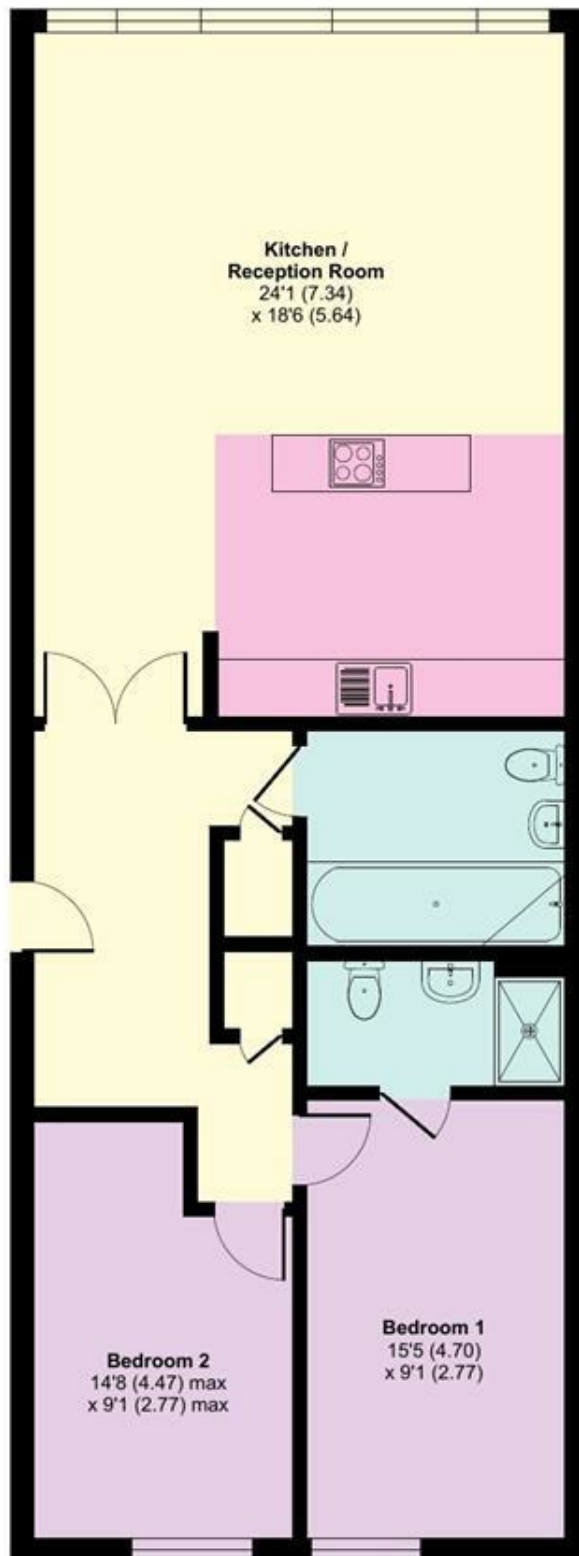

FIFTH FLOOR



Floor plan produced in accordance with RICS Property Measurement Standards incorporating International Property Measurement Standards (IPMS2 Residential). © nichecom 2022. Produced for TK (Hampstead) Ltd. REF: 886792