



TK International  
020 7794 8700  
www.t-k.co.uk

Residential Sales  
Residential Lettings  
Property Management

Sales Office:  
9 Heath Street  
Hampstead  
London NW3 6TP  
E: sales@t-k.co.uk

Lettings Office:  
16-18 Heath Street  
Hampstead  
London NW3 6TE  
E: lettings@t-k.co.uk

tk.international  
 TK International  
 TK International

1998 > 2023 Celebrating 25 years of trusted service.



## North End Way Hampstead NW3

Carved from this famous listed mansion adjacent to Hampstead Heath, once the home of Viscount Levehulme and set within acres of private gated grounds including the famous pergola, Lawn House is a grand self contained house of some 8,600 sq ft arranged primarily over two floors plus a basement swimming pool and leisure complex.

This remarkable property is offered for sale in pristine decorative condition throughout and retains a number of period features including listed oak wall panelling and opulent decorative ceiling mouldings in the drawing room as well as striking marble pillars and marble covered walls throughout the main hallway - and 4.6M high ceilings!

The ground floor offers a 40' drawing room, 30' reception room, double volume study/galleried library, 'art deco' style cinema, 42' kitchen/breakfast room, utility room, guest WC and private lift.

The first floor can also be reached by a beautiful curving staircase with overhead glazed lantern which floods the lobby with light. On the half landing is a guest suite with sitting room, bedroom and en-suite bathroom. The first floor offers a principal suite with bedroom, sitting room/dressing room and en-suite bathroom, plus three further bedrooms with en-suite bathrooms, as well as a large 35' roof terrace.

The property comes with garaging for three cars plus hard standing for three more and two large lawned areas are demised with the house. Inverforth House enjoys 24 hour portage and security.

**£13,950,000**

**SOLE AGENT**

**Share of Freehold**













Inverforth House,  
Hampstead NW3

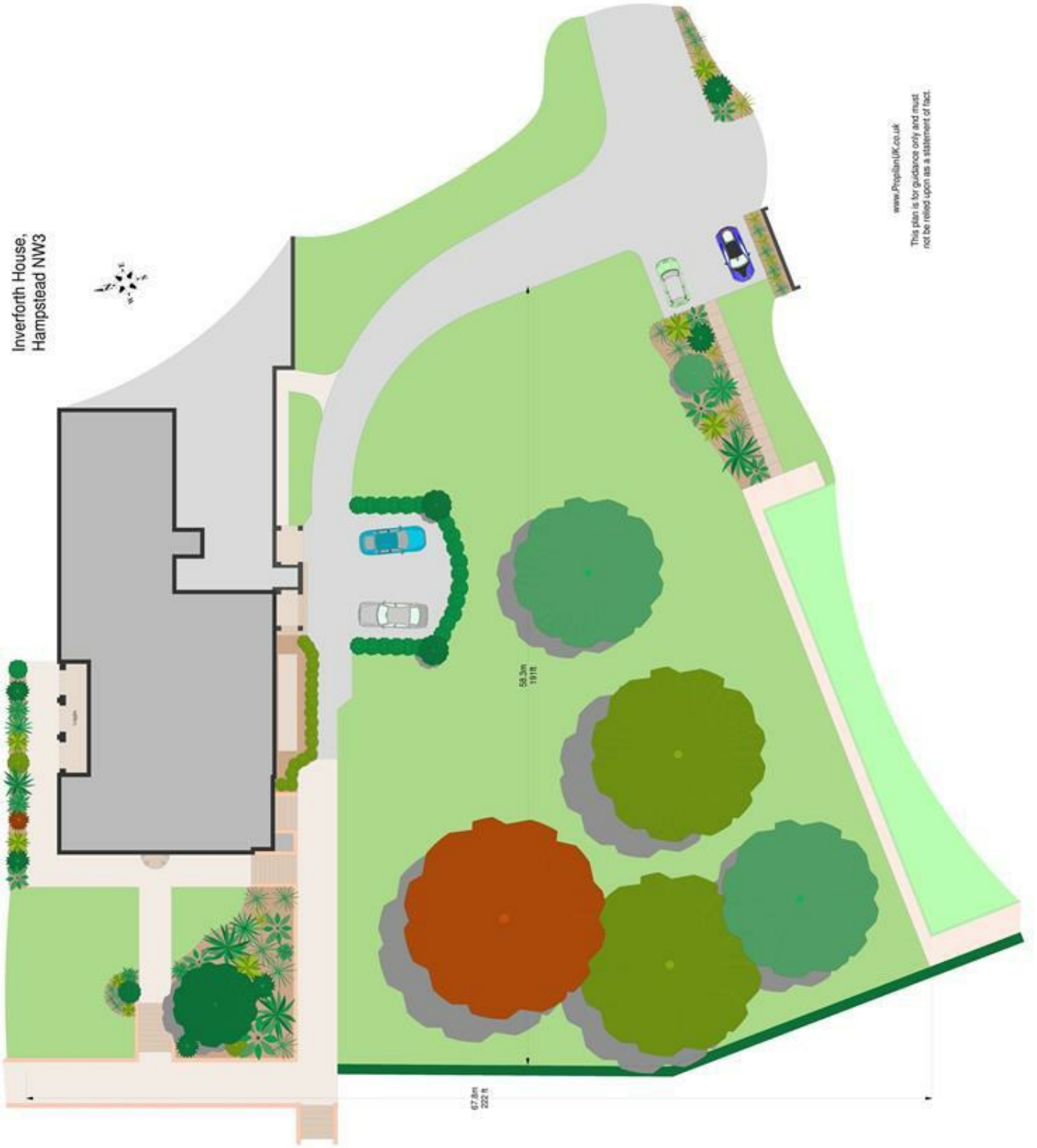

[www.PopplanUK.co.uk](http://www.PopplanUK.co.uk)

This plan is for guidance only and must  
not be relied upon as a statement of fact.