

HJC

HIGHER VALUES



4, 58 Effingham Road
Long Ditton, Surbiton, KT6 5LB
£1,000 Per Calendar Month



0 1 1 D

Floor Plan

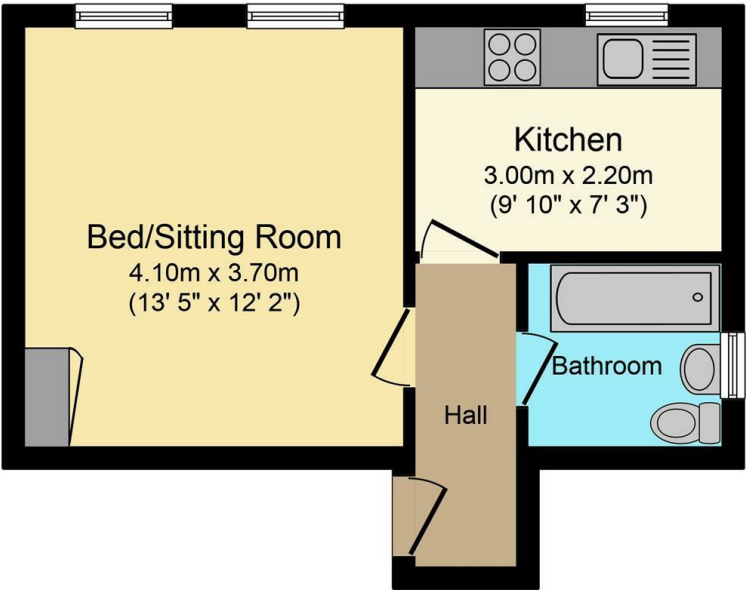

Floor Plan

Floor area 30.3 sq. m. (326 sq. ft.) approx.

Total floor area 30.3 sq. m. (326 sq. ft.) approx.
This plan is for illustration purposes only and may not be representative of the property.
Plan created for HJC Estate Agents.

Produced by www.keyagent.co.uk

Area Map



Energy Efficiency Graph

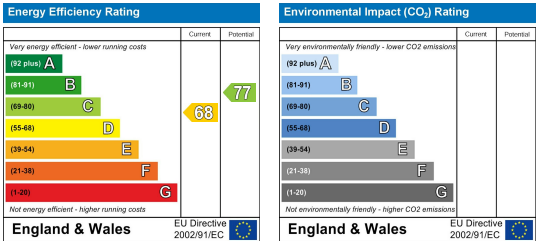

Viewing

Please contact our HJC Surbiton Office on 020 8390 0404 if you wish to arrange a viewing appointment for this property or require further information.

- Stunning studio apartment
- Communal garden
- Walking distance to Surbiton Station
- Single occupant only
- Available from the end of April
- Council Tax Band B



Sorry - all viewing slots now taken. A super studio apartment with a communal garden located in an attractive Victorian building. The property is located on the first floor and comprises a modern fitted kitchen, studio room with far reaching views across Long Ditton recreation ground and white bathroom suite. Available to single occupants only. Unfurnished and available end of April.



These particulars, whilst believed to be accurate are set out as a general outline only for guidance and do not constitute any part of an offer or contract. Intending purchasers should not rely on them as statements of representation of fact, but must satisfy themselves by inspection or otherwise as to their accuracy. No person in this firm's employment has the authority to make or give any representation or warranty in respect of the property.