

# HJC

HIGHER VALUES



## Lysander Gardens

Surbiton, KT6 6AT

Guide Price £325,000

A charming one bedroom apartment close to Surbiton Station and town centre with garage. The property is located on the first floor of this purpose built development and comprises a double bedroom, bathroom and open plan kitchen / living room. It also benefits from a garage and is within walking distance of Surbiton Station with its fast link to London Waterloo and Surbiton Town centre with its array of shops, bars and restaurants. Council Tax Band C.

Material Info: Brick Walls Roof Tiles Water / Electricity / Sewerage: Mains. Broadband: Fibre (FTTC). Mobile Coverage: Indoor: Likely Outdoor: Likely.

- Charming One Bedroom Apartment
- Open Plan Kitchen / Living Room
- Bathroom
- Leasehold
- Close to Town Centre
- First Floor
- Double Bedroom
- Garage
- Close to Surbiton Station
- No Onward Chain

# Floor Plan

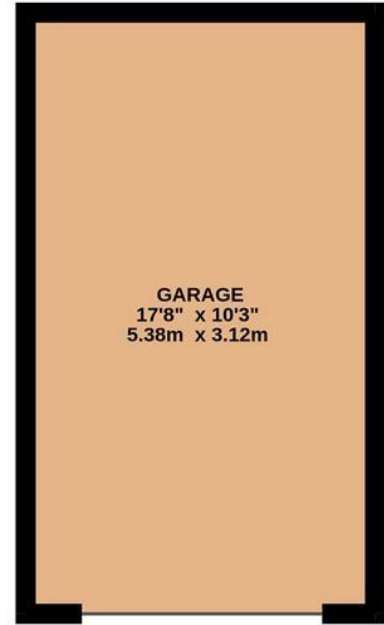
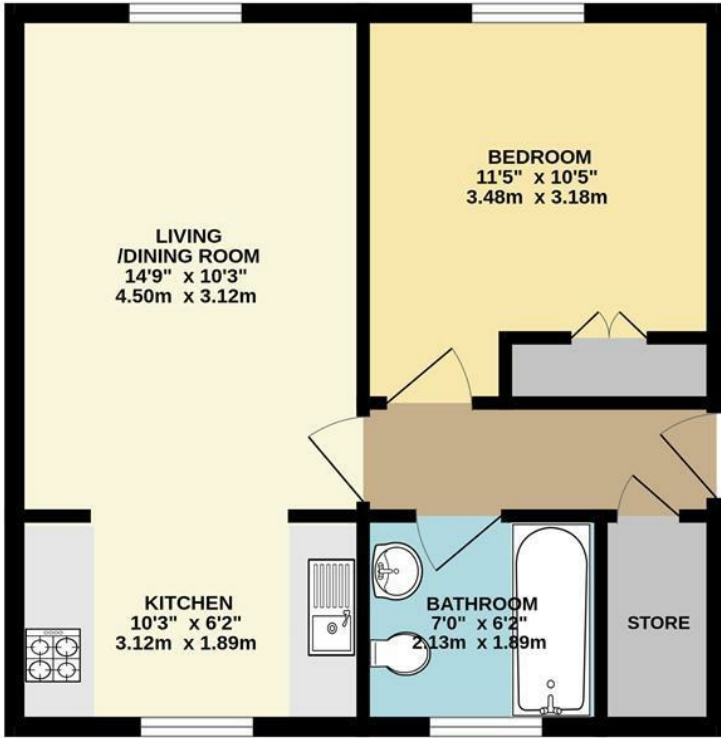

FIRST FLOOR FLAT



LYSANDER GARDENS, SURBITON  
INTERNAL FLOOR AREA (APPROX.) 442 sq ft/ 41 sq m  
GARAGE (APPROX.) 180 sq ft/ 16.72 sq m

Whilst every attempt has been made to ensure the accuracy of this floor plan, measurement of doors, windows, rooms and any other items are approximate and no responsibility is taken for any error, omission or mis-statement. Made with Metropix © 2024.

## Energy Efficiency Graph

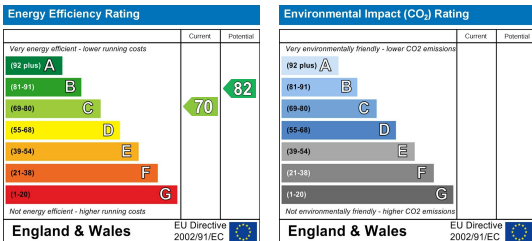

These particulars, whilst believed to be accurate are set out as a general outline only for guidance and do not constitute any part of an offer or contract. Intending purchasers should not rely on them as statements of representation of fact, but must satisfy themselves by inspection or otherwise as to their accuracy. No person in this firm's employment has the authority to make or give any representation or warranty in respect of the property.