

HJC

HIGHER VALUES



18 Savery Drive

Surbiton, KT6 5RH

£4,500 Per Calendar Month

4 3 2 D

Floor Plan

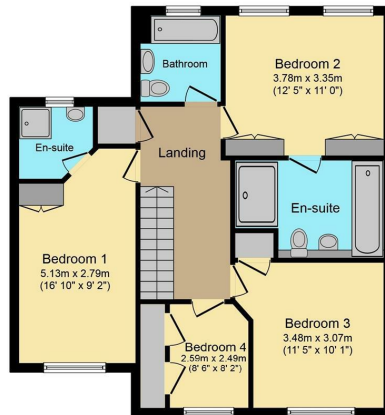
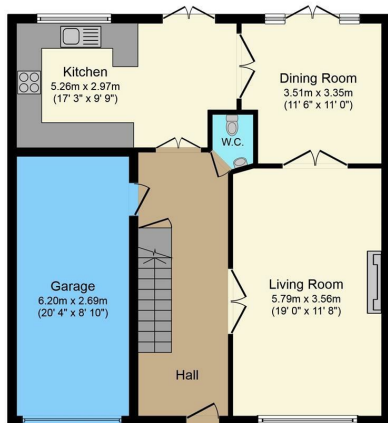

Total floor area 154.0 sq. m. (1,658 sq. ft.) approx.
This plan is for illustration purposes only and may not be representative of the property.
Plan created for HJC Estate Agents.

Produced by www.keyagent.co.uk

Area Map



Energy Efficiency Graph

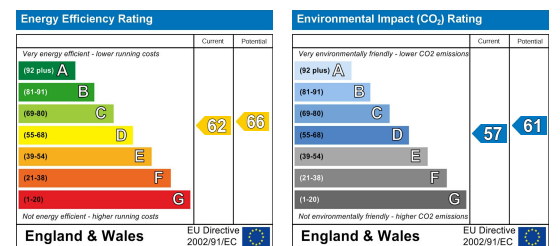

Viewing

Please contact our HJC Surbiton Office on 020 8390 0404 if you wish to arrange a viewing appointment for this property or require further information.

- Detached family home
- Situated on St James Development
- 4 bedrooms
- Large reception room
- Recently re-decorated
- Available end of Aug throughout
- Council tax band G



Located on the hugely popular St James Development is this superb detached family home with glorious southerly rear aspect. The accommodation is bright, spacious and includes a good size living room, dining area, well appointed kitchen/breakfast room, master bedroom with ensuite bathroom, guest bedroom with ensuite, two further bedrooms and a family bathroom. The property also benefits from garage, driveway parking and is unfurnished. Available end of August.



These particulars, whilst believed to be accurate are set out as a general outline only for guidance and do not constitute any part of an offer or contract. Intending purchasers should not rely on them as statements of representation of fact, but must satisfy themselves by inspection or otherwise as to their accuracy. No person in this firm's employment has the authority to make or give any representation or warranty in respect of the property.