

HJC

HIGHER VALUES



Chadwick Place

Surbiton, KT6 5RG

Guide Price

£1,150,000

A stunning end of terrace town house located on the sought after St James Development. This beautifully presented town house is overlooking the main square with only a few on the development being of this size. The accommodation includes two reception rooms, a well appointed kitchen/breakfast room, main bedroom with ensuite bathroom, three further bedrooms and two further bathrooms. The property also benefits from a pretty rear garden, detached garage, off-street parking and walking distance to Surbiton Town centre and mainline Train station. Council Tax Band G.

- End of Terrace Town House
- 4 Bedrooms
- Stunning Kitchen/Breakfast Room
- Detached garage
- Close to the River Thames
- St James Development
- 3 bath/shower Rooms
- Two Reception Rooms
- Off street parking
- Close To Surbiton Station

Floor Plan

CHADWICK PLACE, SURBITON
 TOTAL APPROX. FLOOR AREA
 1658 sq ft/ 154.1 sq m
 excluding garage

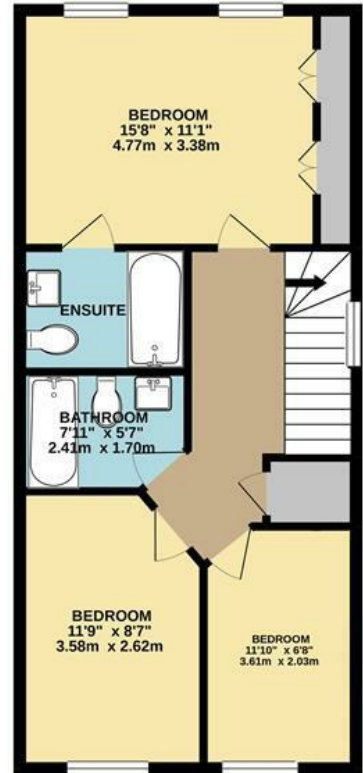
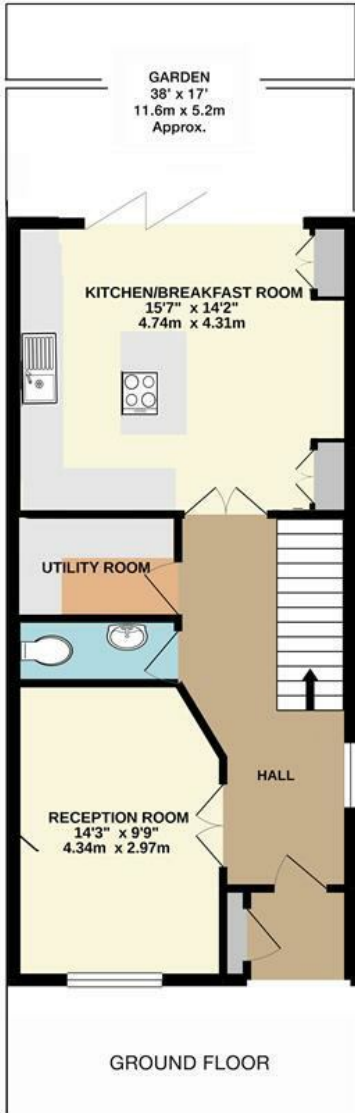
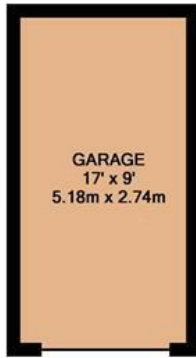

Whilst every attempt has been made to ensure the accuracy of this floor plan, measurement of doors, windows, rooms and any other items are approximate and no responsibility is taken for any error, omission or mis-statement. Made with Metropix © 2024.

Energy Efficiency Graph

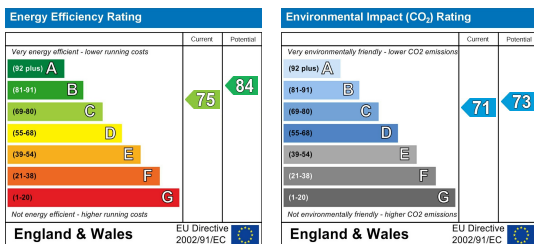

These particulars, whilst believed to be accurate are set out as a general outline only for guidance and do not constitute any part of an offer or contract. Intending purchasers should not rely on them as statements of representation of fact, but must satisfy themselves by inspection or otherwise as to their accuracy. No person in this firm's employment has the authority to make or give any representation or warranty in respect of the property.