

HJC

HIGHER VALUES



Lysander Gardens

Surbiton, KT6 6AT

Guide Price £315,000

A delightful and well presented one bedroom apartment close to Surbiton Station and town centre with allocated parking. The property is located on the ground floor of this purpose built development and comprises a double bedroom, separate kitchen, bright living room and bathroom. It also benefits from an allocated parking space and being within walking distance of Surbiton Station with its fast link to London Waterloo and Surbiton Town centre with its array of shops, bars and restaurants. Council Tax Band C.

- Delightful One Bedroom Apartment
- Separate Kitchen
- Bathroom
- Leasehold
- Close to River Thames and Town
- Ground Floor
- Double Bedroom
- Parking
- Close to Surbiton Station
- Chain Free

Floor Plan

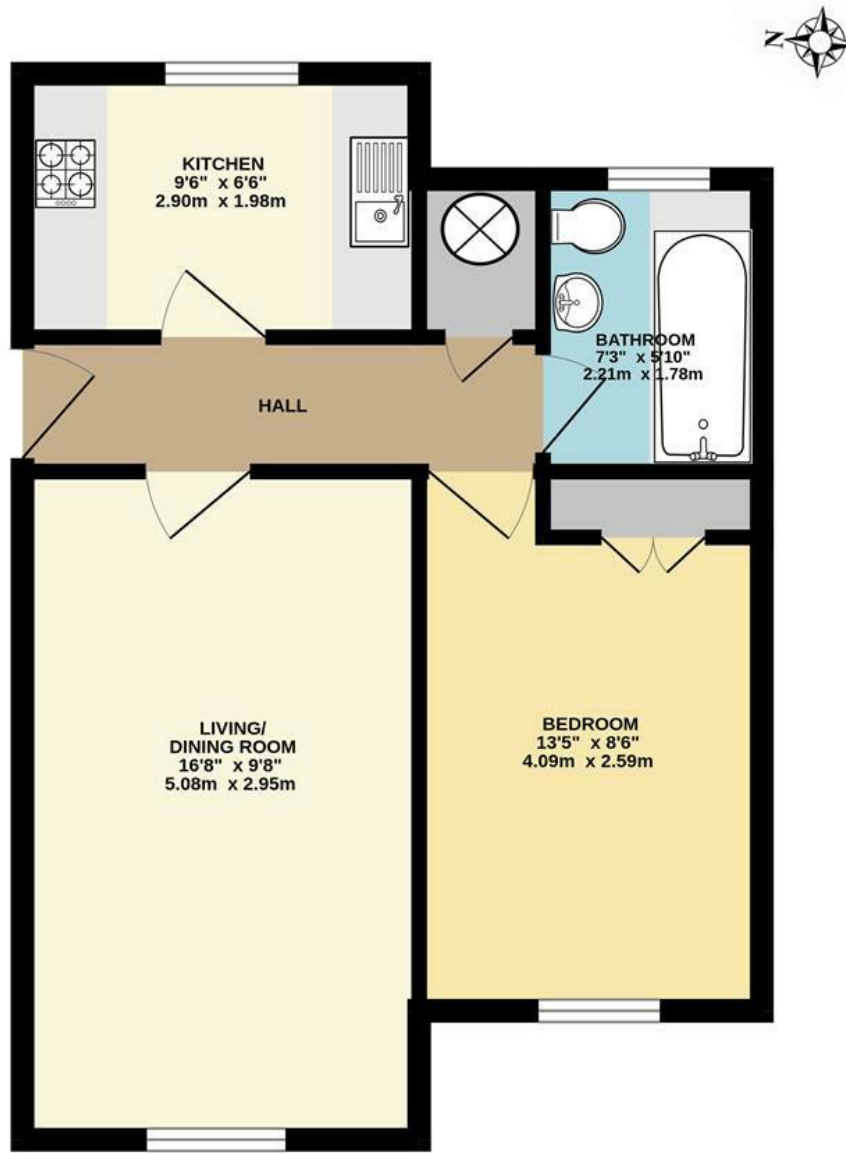

GROUND FLOOR FLAT

LYSANDER GARDENS, SURBITON
INTERNAL FLOOR AREA (APPROX.) 452 sq ft/ 42 sq m

Whilst every attempt has been made to ensure the accuracy of this floor plan, measurement of doors, windows, rooms and any other items are approximate and no responsibility is taken for any error, omission or mis-statement. Made with Metropix © 2024.

Energy Efficiency Graph

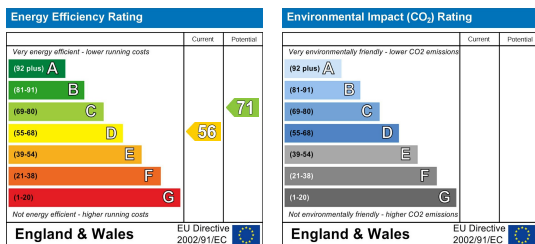

These particulars, whilst believed to be accurate are set out as a general outline only for guidance and do not constitute any part of an offer or contract. Intending purchasers should not rely on them as statements of representation of fact, but must satisfy themselves by inspection or otherwise as to their accuracy. No person in this firm's employment has the authority to make or give any representation or warranty in respect of the property.