

# HJC

HIGHER VALUES



**3 Selsdon Close**  
, Surbiton, KT6 4TF  
**£2,995 Per Month**



 3  1  3 



## Floor Plan

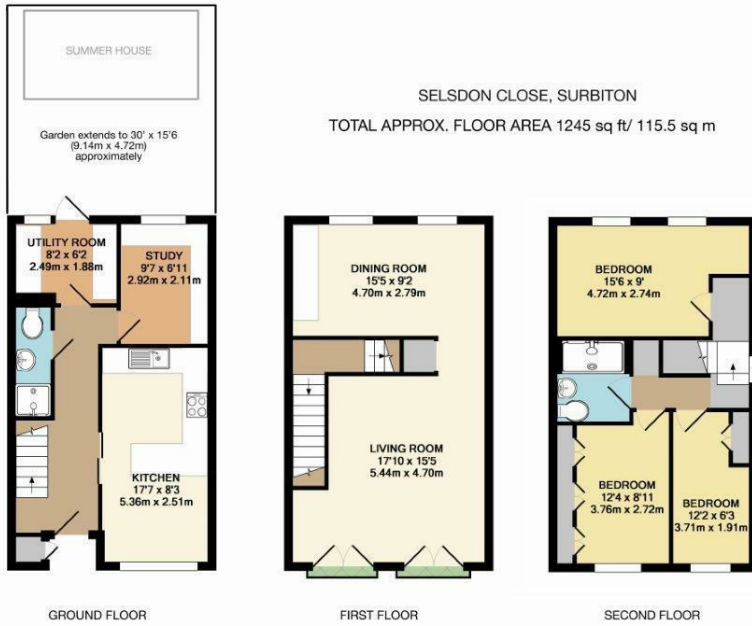

Whilst every attempt has been made to ensure the accuracy of this floor plan, measurement of doors, windows, rooms and any other items are approximate and no responsibility is taken for any error, omission or mis-statement. Made with Metropix © 2016.

## Area Map



## Energy Efficiency Graph

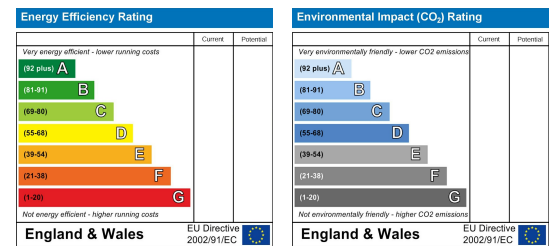

## Viewing

Please contact our HJC Surbiton Office on 020 8390 0404 if you wish to arrange a viewing appointment for this property or require further information.

- Luxury townhouse
- Open plan living area
- 3 Bedrooms
- Unfurnished
- Council tax band F
- Beautifully presented
- Modern fitted kitchen
- Modern shower room
- Available Mid July



An attractive 3 bedroom Georgian style town house with an absolutely stunning interior that has been finished to a very high standard. Further benefits include off-street parking for two cars, open plan living room/dining room and stunning kitchen/breakfast room. The property also benefits from a utility room and an office. Located in a highly sought after cul de sac, south facing garden and only a few minutes walk from Surbiton town centre and main line station. Unfurnished and available mid July.



These particulars, whilst believed to be accurate are set out as a general outline only for guidance and do not constitute any part of an offer or contract. Intending purchasers should not rely on them as statements of representation of fact, but must satisfy themselves by inspection or otherwise as to their accuracy. No person in this firm's employment has the authority to make or give any representation or warranty in respect of the property.