

HJC

HIGHER VALUES



Saxonbury Gardens

Surbiton, KT6 5HF

Guide Price

£1,895,000

Superb 6 Bedroom, 5 Bathroom Detached Family home set in a private secluded sought after road. The property has been refurbished throughout to a very high standard offering spacious accommodation, featuring outdoor entertaining areas, Double Garage, Off Street parking and walking distance to Surbiton Mainline Station, shops and the River Thames. Council Tax Band G.

- 5 Bedroom Detached Home
- Separate Living Room
- Separate Dining Area
- 4 Ensuite Bathrooms
- Double garage and OSP
- Large Study
- Kitchen/Dining/Family Room
- Utility Room
- Family Bathroom
- Freehold property

Floor Plan

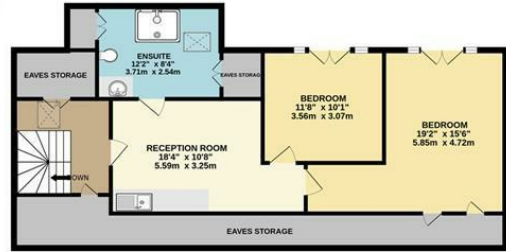

SAXONBURY GARDENS, SURBITON
INTERNAL FLOOR AREA (APPROX.) 3685 sq ft/ 342.34sq m
 (Including Eaves Storage 3960 sq ft/ 367.9sq m)

Whilst every attempt has been made to ensure the accuracy of this floor plan, measurement of doors, windows, rooms and any other items are approximate and no responsibility is taken for any error, omission or mis-statement. Made with Metropix © 2024.

Energy Efficiency Graph

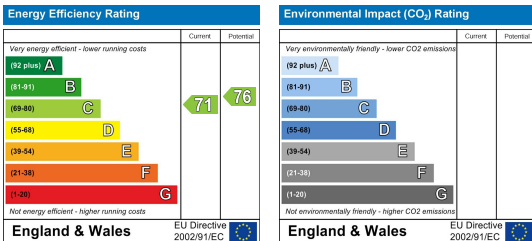

These particulars, whilst believed to be accurate are set out as a general outline only for guidance and do not constitute any part of an offer or contract. Intending purchasers should not rely on them as statements of representation of fact, but must satisfy themselves by inspection or otherwise as to their accuracy. No person in this firm's employment has the authority to make or give any representation or warranty in respect of the property.