

first for homes

first for property in life - firstforhomes.co.uk

Contact Allan England's Team

01592 752 944



Jenny Gray Place, Lochgelly

Offers over £269,000

Jenny Gray Place, Lochgelly

Stunning 3-Bed Detached Bungalow With 3-Car Driveway Situated Within A Highly Sought-After Development In Lochgelly!

Allan England's award winning team at first for homes are proud to welcome to the market this lovely 3-bed Detached Bungalow situated within The Avenues, a much-desired area of Lochgelly. The property, built by Easy Living Developments in 2021 comprises: entrance hall, family lounge, open-plan quality fitted kitchen/diner with integrated NEFF appliances, master bedroom with en-suite shower room, 2 further bedrooms and family bathroom. Oak wood finishes throughout. Externally, there are garden grounds to the front with a 3-car driveway and private South-West gardens to the rear. Early viewing is highly recommended.

HOME REPORT VALUE £275,000

EPC RATING B

COUNCIL TAX BAND D

Call first for homes - first for trust... first for service... first for aftercare!

The popular residential area of Lochgelly is convenient for local amenities such as banking, schools, The Lochgelly Centre, golf course and a variety of local shops. For the commuter, it boasts its' own Train Station and the area also benefits from easy access to the A92 giving swift access to all major local Towns and Edinburgh.





SITUATION – Lochgelly

ENTRANCE VESTIBULE

ENTRANCE HALL

FAMILY LOUNGE

14'8" x 10'9" approx. (4.48m x 3.28m approx.)

KITCHEN / DINER

19'3" x 11'1" approx. (5.88m x 3.38m approx.)

MASTER BEDROOM

12'9" x 9'4" approx. (3.91m x 2.85m approx.)

EN-SUITE SHOWER ROOM

BEDROOM 2

10'0" x 9'8" approx. (3.06m x 2.96m approx.)

BEDROOM 3

10'0" x 9'4" approx. (3.06m x 2.87m approx.)

FAMILY BATHROOM

10'10" x 6'1" approx. (3.32m x 1.86m approx.)

3-CAR DRIVEWAY

GARDEN GROUNDS

INFORMATION



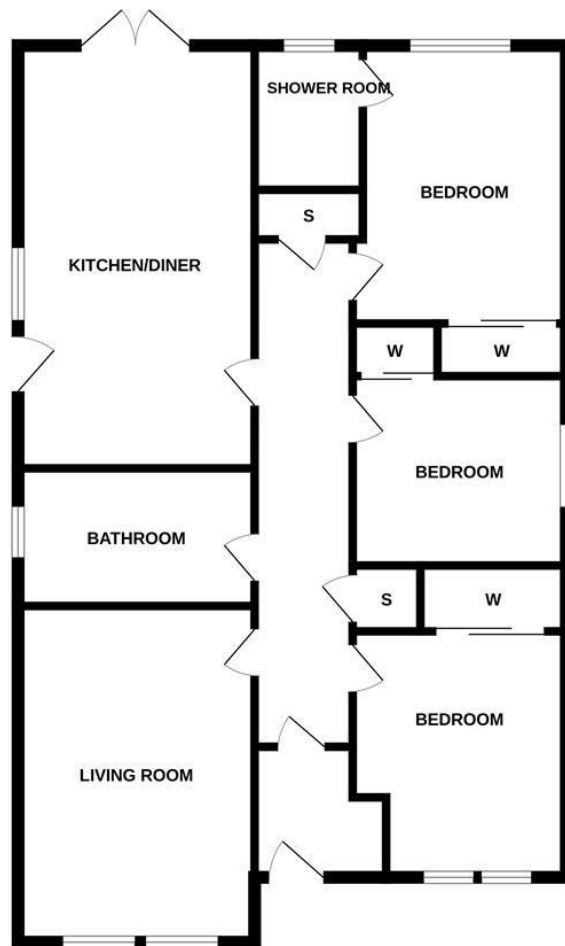

Whilst every attempt has been made to ensure the accuracy of the floorplan contained here, measurements of doors, windows, rooms and any other items are approximate and no responsibility is taken for any error, omission or mis-statement. This plan is for illustrative purposes only and should be used as such by any prospective purchaser. The services, systems and appliances shown have not been tested and no guarantee as to their operability or efficiency can be given.
Made with Metropix ©2025

Information

These particulars are prepared on the basis of information provided by our clients. We have not tested the electrical system or any electrical appliances, nor where applicable, any central heating system. All sizes are recorded by electronic tape measurement to give an indicative, approximate size only. Prospective purchasers should make their own enquiries – no warranty is given or implied. This schedule is not intended to, and does not form any contract.

FREE Valuation

Selling Your Home?

Choose first for homes - a highly experienced estate agency team you can trust to sell your home at the highest possible price. Offering fantastic savings on selling fees, with no compromise on service, free professional photography highlighting your home in its best light, first for homes will be your first choice. Contact us today to arrange your appointment.



first for trust



first for service



first for aftercare