



## AMITY GROVE

Wimbledon, SW20







# CHARMING FAMILY RESIDENCE

A beautiful fully extended period property which has been tastefully finished located in the heart of West Wimbledon, near to excellent transport link and local schools.



Local Authority: London Borough of Merton

Council Tax band: G

Tenure: Freehold

Guide Price: £1,400,000



## AMITY GROVE

This elegant four-bedroom home offers a front reception room with wooden shutters and bespoke fitted storage, the modern fitted kitchen leads to the rear dinning space and onto the lawned garden via bi-folding doors. Further benefits include a ground floor WC, a spacious full width principal bedroom, with two bedrooms in the loft extension. This well-rounded family home also boasts two bathrooms and off-street parking.

Amity Grove is a popular road located in the heart of West Wimbledon, set close to Raynes Park high street and train station with Wimbledon Village nearby. Surrounded by local parks with Wimbledon Chase primary School nearby.













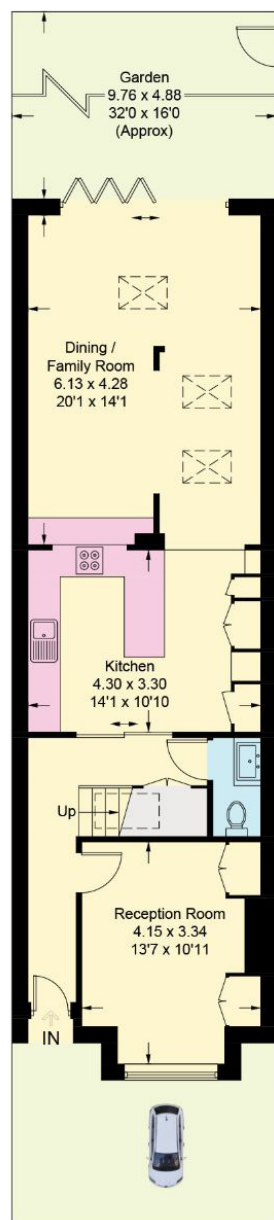

**Ground Floor**

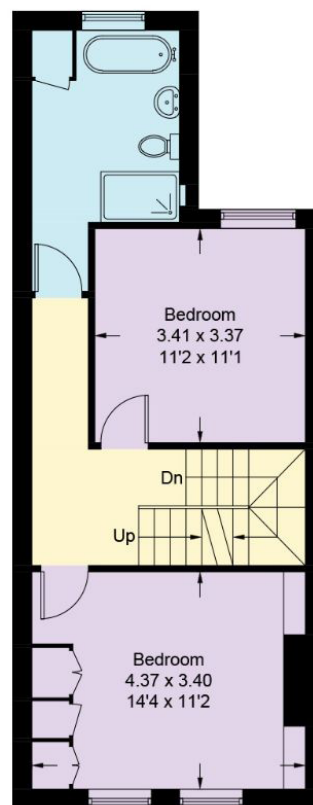

**First Floor**

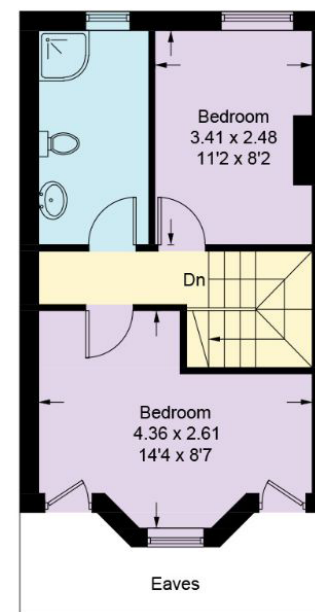

**Second Floor**

Approximate Gross Internal Area = 146.7 sq m / 1579 sq ft

This plan is for layout guidance only. Not drawn to scale unless stated. Windows and door openings are approximate. Whilst every care is taken in the preparation of this plan, please check all dimensions, shapes and compass bearings before making any decisions reliant upon them. (ID767266)



We would be delighted  
to tell you more.

**Ross Jordan**  
+44 20 3830 8634  
ross.jordan@knightfrank.com

**Knight Frank Wimbledon**  
58 High Street, London  
SW19 5EE

**Danielle Gaughan**  
+44 20 7861 5487  
danielle.gaughan@knightfrank.com

**knightfrank.co.uk**

**Your partners in property**

1. Particulars: These particulars are not an offer or contract, nor part of one. You should not rely on statements given by Knight Frank in the particulars, by word of mouth or in writing ("information") as being factually accurate about the property, its condition or its value. Neither Knight Frank nor any joint agent has any authority to make any representations about the property, and accordingly any information given is entirely without responsibility on the part of Knight Frank. 2. Material Information: Please note that the material information is provided to Knight Frank by third parties and is provided here as a guide only. While Knight Frank has taken steps to verify this information, we advise you to confirm the details of any such material information prior to any offer being submitted. If we are informed of changes to this information by the seller or another third party, we will use reasonable endeavours to update this as soon as practical. 3. Photos, Videos etc: The photographs, property videos and virtual viewings etc. show only certain parts of the property as they appeared at the time they were taken. Areas, measurements and distances given are approximate only. 4. Regulations etc: Any reference to alterations to, or use of, any part of the property does not mean that any necessary planning, building regulations or other consent has been obtained. A buyer must find out by inspection or in other ways that these matters have been properly dealt with and that all information is correct. 5. Fixtures and fittings: A list of the fitted carpets, curtains, light fittings and other items fixed to the property which are included in the sale (or may be available by separate negotiation) will be provided by the Seller's Solicitors. 6. VAT: The VAT position relating to the property may change without notice. 7. To find out how we process Personal Data, please refer to our Group Privacy Statement and other notices at <https://www.knightfrank.com/legals/privacy-statement>.

Particulars dated March 2025. Photographs and videos dated March 2025. All information is correct at the time of going to print. Knight Frank is the trading name of Knight Frank LLP. Knight Frank LLP is a limited liability partnership registered in England and Wales with registered number OC305934. Our registered office is at 55 Baker Street, London W1U 8AN. We use the term 'partner' to refer to a member of Knight Frank LLP, or an employee or consultant. A list of members names of Knight Frank LLP may be inspected at our registered office. If you do not want us to contact you further about our services then please contact us by either calling 020 3544 0692, email to [marketing.help@knightfrank.com](mailto:marketing.help@knightfrank.com) or post to our UK Residential Marketing Manager at our registered office (above) providing your name and address.