

Briar Walk,
Putney
SW15







A spectacular eight-bedroom detached family home in Putney.



Offering huge potential and scope to create a truly magnificent family home, this secluded detached Edwardian house sits on a quiet and popular residential road in Putney.

Upon entering the house you will find a grand reception hall with a fireplace and a wonderful black and white marble floor.

The house benefits from extensive reception space on the ground floor allowing for formal and informal entertaining. The large kitchen/breakfast/family room opens out onto the expansive gardens and the drawing-room and library have bay windows with views over the gardens. The accommodation also offers versatility and multiple options for a home office, study, playroom or snug.

London Borough of Wandsworth
The guide price is available upon request

Freehold



The main staircase is wide and sweeps up to the first-floor landing and there is a second staircase leading up to the top floor. The principal bedroom overlooks the gardens within an attractive bay window and has dual walk-in wardrobes as well as a delightful large en suite bathroom and air-conditioning. There are three further bedrooms on this floor.

The top floor comprises of four further bedrooms all with air-conditioning and two of which are en suite. Additionally, there is a laundry room conveniently located on this floor along with a further guest bathroom.

There is a large basement with high ceilings and access to the garden, used as a dry store and games room. This versatile layout offers flexible space to create a media room, gym and wine cellar.



Briar Walk is close to Putney and Barnes Commons and Richmond Park. The location is within 2 miles of some of the best schools in London. Nearby there is golf and tennis at the private Roehampton Club. Putney and Barnes mainline stations (to Waterloo and the City) and East Putney tube are within walking distance.



Briar Walk, SW15

Approximate Gross Internal Area: 715.42 Sq. metres
7701 Sq. feet

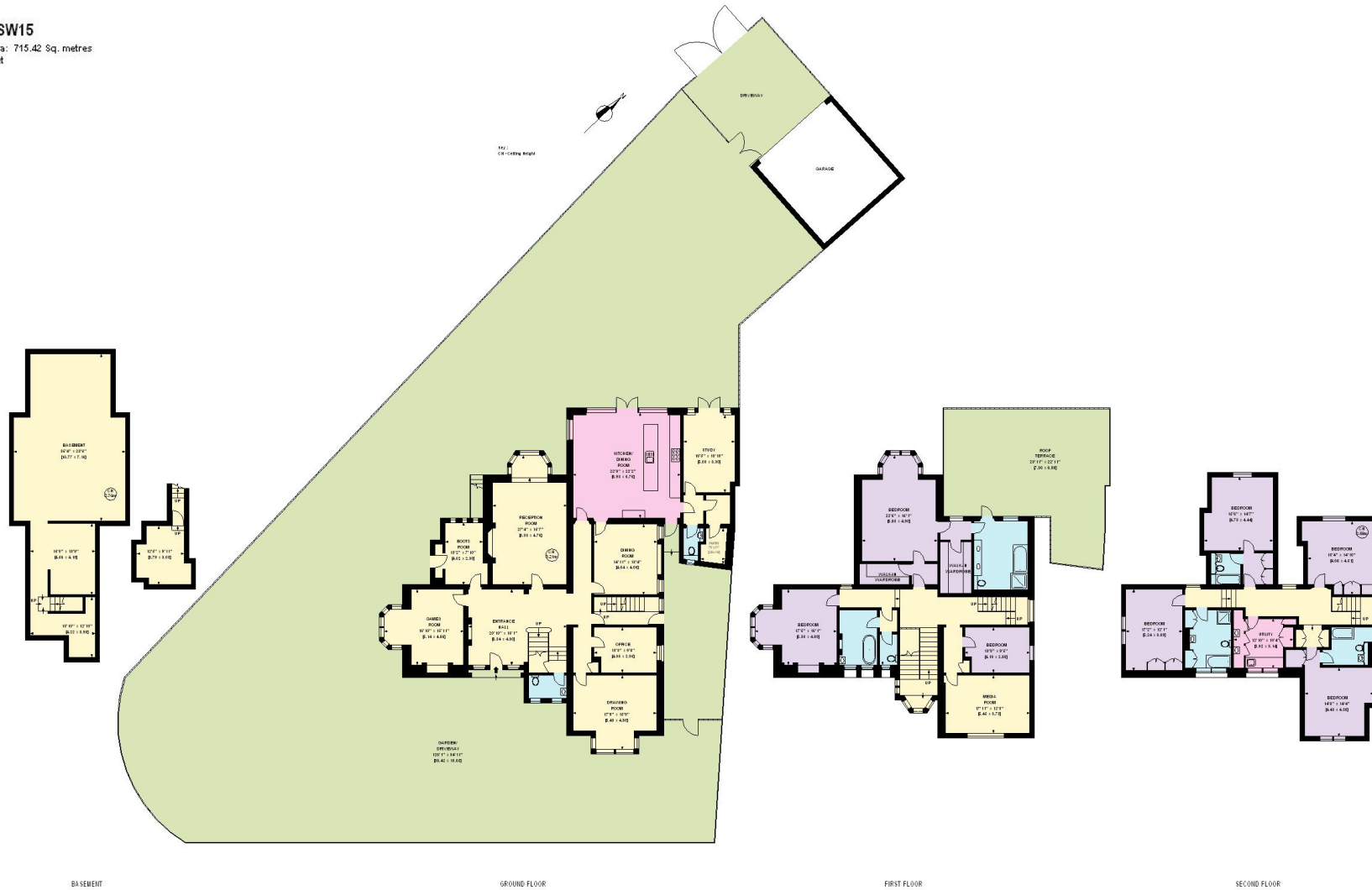

Knight Frank
Wimbledon
81 High Street
Wimbledon SW19 5EG

We would be delighted to tell you more.

The Wimbledon sales team
020 8946 0026
wimbledon@knightfrank.com

knightfrank.co.uk



Connecting people & property, perfectly.

Fixtures and fittings: A list of the fitted carpets, curtains, light fittings and other items fixed to the property which are included in the sale (or may be available by separate negotiation) will be provided by the Seller's Solicitors.

Important Notice: 1. Particulars: These particulars are not an offer or contract, nor part of one. You should not rely on statements by Knight Frank LLP in the particulars or by word of mouth or in writing ("information") as being factually accurate about the property, its condition or its value. Neither Knight Frank LLP nor any joint agent has any authority to make any representations about the property, and accordingly any information given is entirely without responsibility on the part of the agents, seller(s) or lessor(s). 2. Photos, Videos etc: The photographs, property videos and virtual viewings etc. show only certain parts of the property as they appeared at the time they were taken. Areas, measurements and distances given are approximate only. 3. Regulations etc: Any reference to alterations to, or use of, any part of the property does not mean that any necessary planning, building regulations or other consent has been obtained. A buyer or lessee must find out by inspection or in other ways that these matters have been properly dealt with and that all information is correct. 4. VAT: The VAT position relating to the property may change without notice. 5. To find out how we process Personal Data, please refer to our Group Privacy Statement and other notices at <https://www.knightfrank.com/legals/privacy-statement>.

Particulars dated [March 2021]. Photographs and videos dated [March 2021].

Knight Frank is the trading name of Knight Frank LLP. Knight Frank LLP is a limited liability partnership registered in England and Wales with registered number OC305934. Our registered office is at 55 Baker Street, London W1U 8AN where you may look at a list of members' names. If we use the term 'partner' when referring to one of our representatives, that person will either be a member, employee, worker or consultant of Knight Frank LLP and not a partner in a partnership. If you do not want us to contact you further about our services then please contact us by either calling 020 3544 0692, email to marketing.help@knightfrank.com or post to our UK Residential Marketing Manager at our registered office (above) providing your name and address.