



Chester Place, Regent's Park **NW1**

Chester Place, Regent's Park NW1

Situated in a prime location with stunning views over Regent's Park, this magnificent Regency house is now available for purchase through Knight Frank. A true gem in one of London's most sought-after locations, the property effortlessly blends period elegance with modern comforts.

This charming residence boasts high ceilings, intricate period features, and an abundance of natural light throughout. The spacious layout includes five well-proportioned bedrooms, three luxurious bathrooms, a grand double reception room perfect for entertaining, a formal dining room, and kitchen with high-end appliances.



Guide price: £5,000,000

Tenure: Leasehold: approximately 140 years remaining

Service charge: Please note we have been unable to confirm the service charge, ground rent and review periods. You should ensure you make your own enquiries.

Local authority: London Borough of Camden

Council tax band: H









The property further benefits from two balconies and ample storage throughout. With its blend of historic charm and modern amenities, this exceptional home is an ideal retreat in the heart of London.

Chester Terrace faces Regent's Park with its boating lake, lawns, and rose gardens,. The property is ideally located for the green spaces of Regent's Park, London Zoo, and Lord's Cricket Ground. The boutiques and restaurants of St John's Wood High Street are also close by.



Chester Place, NW1

Approximate Gross Internal Area 2,320 sq ft – 215 sq m
 Vaults Area 243 sq ft – 23 sq m

This plan is for guidance only and must not be relied upon as a statement of fact. Attention is drawn to the important notice on the last page of the text of the Particulars.

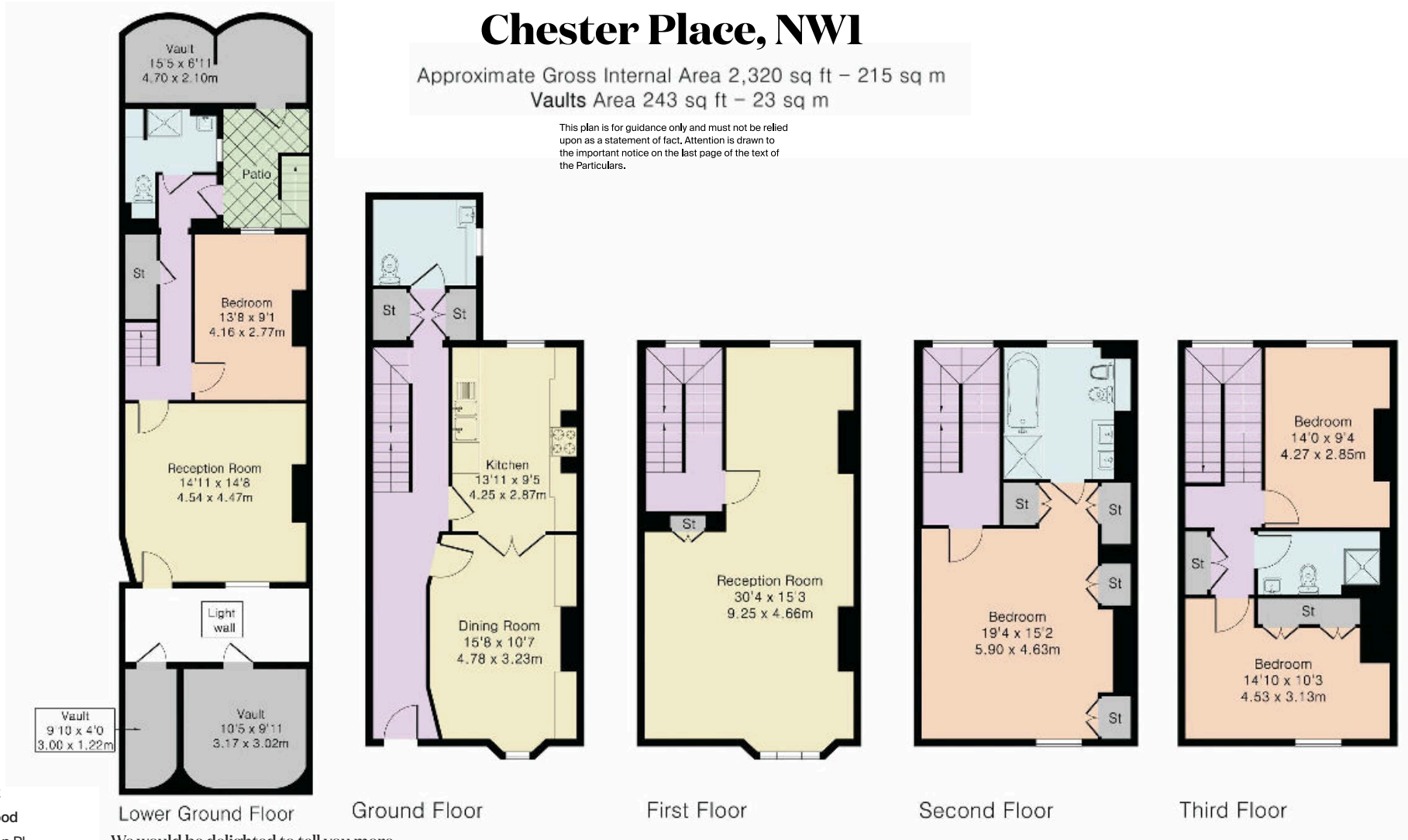

Knight Frank
 St John's Wood
 5-7 Wellington Pl
 London
 NW8 7PB
knightfrank.co.uk

Lower Ground Floor
 We would be delighted to tell you more

Sam Krisman
 +44 20 7483 8337
sam.krisman@knightfrank.com



Fixtures and fittings: A list of the fitted carpets, curtains, light fittings and other items fixed to the property which are included in the sale (or may be available by separate negotiation) will be provided by the Seller's Solicitors.
 Important Notice: 1. Particulars: These particulars are not an offer or contract, nor part of one. You should not rely on statements by Knight Frank LLP in the particulars or by word of mouth or in writing ("information") as being factually accurate about the property, its condition or its value. Neither Knight Frank LLP nor any joint agent has any authority to make any representations about the property, and accordingly any information given is entirely without responsibility on the part of the agents, seller(s) or lessor(s). 2. Photos, Videos etc: The photographs, property videos and virtual viewings etc. show only certain parts of the property as they appeared at the time they were taken. Areas, measurements and distances given are approximate only. 3. Regulations etc: Any reference to alterations to, or use of, any part of the property does not mean that any necessary planning, building regulations or other consent has been obtained. A buyer or lessee must find out by inspection or in other ways that these matters have been properly dealt with and that all information is correct. 4. VAT: The VAT position relating to the property may change without notice. 5. To find out how we process Personal Data, please refer to our Group Privacy Statement and other notices at <https://www.knightfrank.com/legals/privacy-statement>.
 Particulars dated September 2024. Photographs and videos dated September 2024.

Knight Frank is the trading name of Knight Frank LLP. Knight Frank LLP is a limited liability partnership registered in England and Wales with registered number OC305934. Our registered office is at 55 Baker Street, London W1U 8AN where you may look at a list of members' names. If we use the term 'partner' when referring to one of our representatives, that person will either be a member, employee, worker or consultant of Knight Frank LLP and not a partner in a partnership. If you do not want us to contact you further about our services then please contact us by either calling 020 3544 0692, email to marketing.help@knightfrank.com or post to our UK Residential Marketing Manager at our registered office (above) providing your name and address.