

Imperial Court, St John's Wood NW8



Imperial Court, St John's Wood **NW8**

Imperial Court, located in the prestigious St John's Wood neighbourhood, offers a luxurious lifestyle with stunning views of Regent's Park.

This third-floor apartment features an impressive reception room with tree-top views, wood flooring and, direct access to a superb terrace, a beautifully finished kitchen with integrated appliances, two spacious en suite bedrooms and a cloakroom. The property also benefits from a porter, lift and storage room.



Asking price: £3,950,000

Tenure: Leasehold: approximately 951 years remaining

Service charge: £24,747 per annum*

Ground rent: *

Local authority: City of Westminster

Council tax band: H



Imperial Court is within walking distance to Primrose Hill, Regent's Park, and the amenities of St John's Wood High Street in addition to St John's Wood Underground Station (Jubilee Line).

*Please note that we have been unable to confirm the next review dates for the service charge/ground rent value. You should ensure that you or your advisors make your own inquiries.



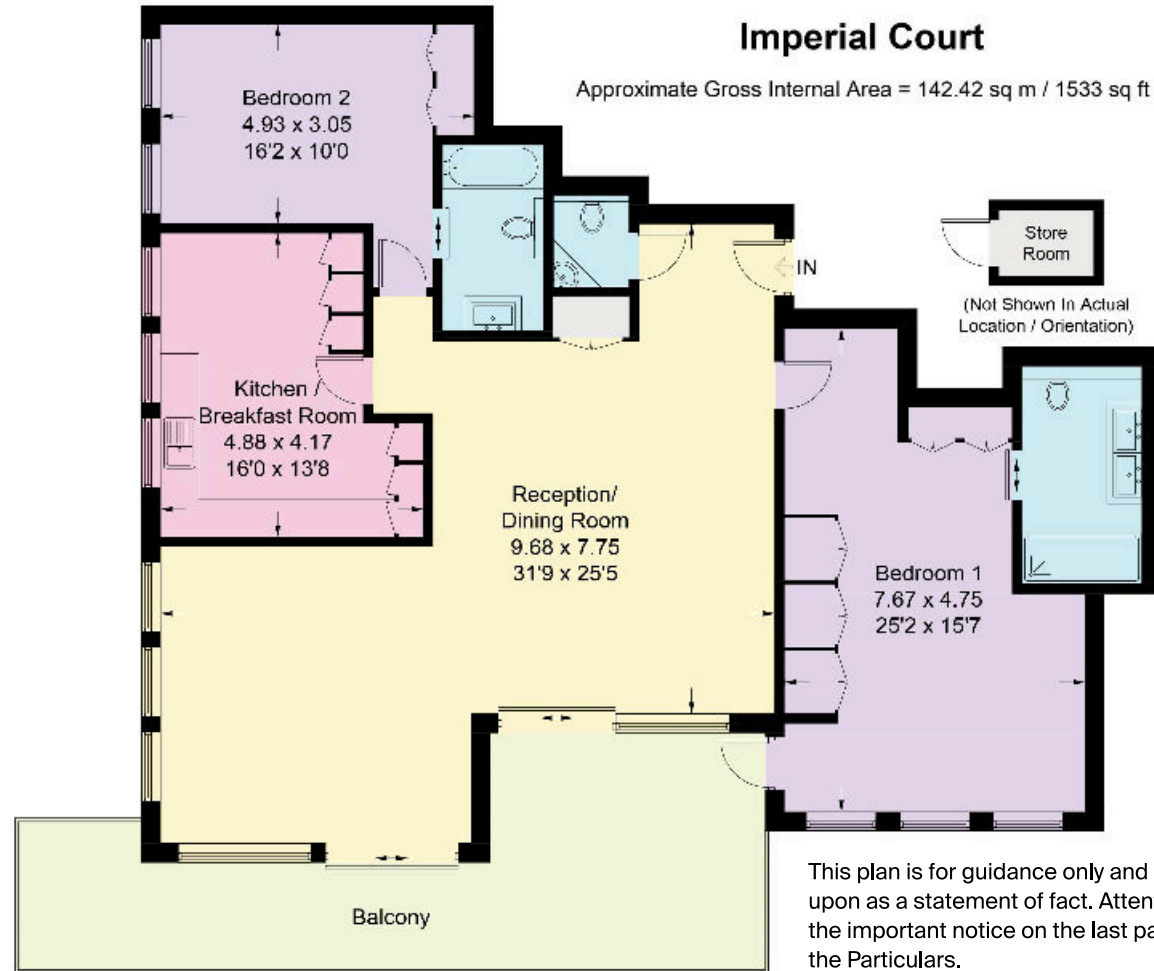

Knight Frank
 St John's Wood
 5-7 Wellington Pl
 London
 NW8 7PB
knightfrank.co.uk

I would be delighted to tell you more
Tim Perks
 +44 20 7871 5065
tim.perks@knightfrank.com



Fixtures and fittings: A list of the fitted carpets, curtains, light fittings and other items fixed to the property which are included in the sale (or may be available by separate negotiation) will be provided by the Seller's Solicitors.

Important Notice: 1. Particulars: These particulars are not an offer or contract, nor part of one. You should not rely on statements by Knight Frank LLP in the particulars or by word of mouth or in writing ("information") as being factually accurate about the property, its condition or its value. Neither Knight Frank LLP nor any joint agent has any authority to make any representations about the property, and accordingly any information given is entirely without responsibility on the part of the agents, seller(s) or lessor(s). 2. Photos, Videos etc: The photographs, property videos and virtual viewings etc. show only certain parts of the property as they appeared at the time they were taken. Areas, measurements and distances given are approximate only. 3. Regulations etc: Any reference to alterations to, or use of, any part of the property does not mean that any necessary planning, building regulations or other consent has been obtained. A buyer or lessee must find out by inspection or in other ways that these matters have been properly dealt with and that all information is correct. 4. VAT: The VAT position relating to the property may change without notice. 5. To find out how we process Personal Data, please refer to our Group Privacy Statement and other notices at <https://www.knightfrank.com/legals/privacy-statement>.

Particulars dated April 2024. Photographs and videos dated April 2024.

All information is correct at the time of going to print. Knight Frank is the trading name of Knight Frank LLP. Knight Frank LLP is a limited liability partnership registered in England and Wales with registered number OC305934. Our registered office is at 55 Baker Street, London W1U 8AN. We use the term 'partner' to refer to a member of Knight Frank LLP or an employee or consultant. A list of members names of Knight Frank LLP may be inspected at our registered office. If you do not want us to contact you further about our services then please contact us by either calling 020 3544 0692, email to marketing.help@knightfrank.com or post to our UK Residential Marketing Manager at our registered office (above) providing your name and address.