



Empire House, Thurloe Place, London SW7

Thurloe Place, London SW7

A superb two-bedroom fourth floor apartment, with lift, found in a prestigious portered building. The apartment is well configured offering versatile space, good ceiling height and ample light throughout.

Bordering Knightsbridge and South Kensington and opposite the Brompton Oratory and the Victoria & Albert Museum, this location is ideal for prime central London living. Empire House is a well-run portered (24hrs) converted building. There are a host of shops, restaurants, bars, and choice of public transport all within close proximity.



Guide price: £1,435,000

Tenure: Leasehold: approximately 125 years remaining

Service charge: £11,365 per annum, reviewed every year, next review due 2025

Ground rent: Peppercorn

Local authority: Royal Borough of Kensington and Chelsea

Council tax band: G









 = Reduced head height below 1.5m

Empire House, SW7

Approximate Gross Internal Floor Area
100.7 sq m / 1084 sq ft

This plan is for guidance only and must not be relied upon as a statement of fact. Attention is drawn to the important notice on the last page of the text of the Particulars.

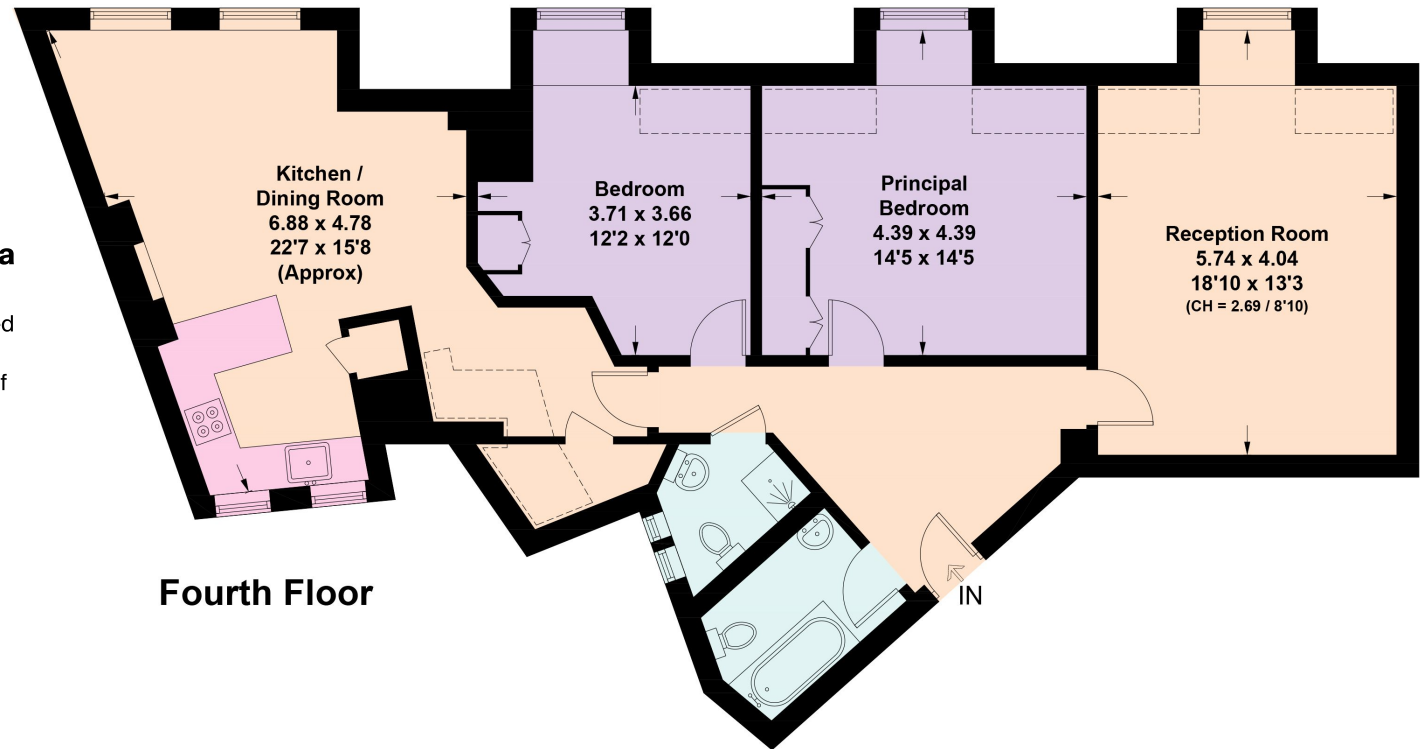

Fourth Floor

Knight Frank
Knightsbridge
52-54 Sloane Avenue
London
SW3 3DD
[knightfrank.co.uk](https://www.knightfrank.co.uk)

We would be delighted to tell you more
James Robinson
+44 207 861 1771
james.robinson@knightfrank.com



Fixtures and fittings: A list of the fitted carpets, curtains, light fittings and other items fixed to the property which are included in the sale (or may be available by separate negotiation) will be provided by the Seller's Solicitors.

Important Notice: 1. Particulars: These particulars are not an offer or contract, nor part of one. You should not rely on statements by Knight Frank LLP in the particulars or by word of mouth or in writing ("Information") as being factually accurate about the property, its condition or its value. Neither Knight Frank LLP nor any joint agent has any authority to make any representations about the property, and accordingly any information given is entirely without responsibility on the part of the agents, seller(s) or lessor(s). 2. Photos, Videos etc: The photographs, property videos and virtual viewings etc. show only certain parts of the property as they appeared at the time they were taken. Areas, measurements and distances given are approximate only. 3. Regulations etc: Any reference to alterations to, or use of, any part of the property does not mean that any necessary planning, building regulations or other consent has been obtained. A buyer or lessee must find out by inspection or in other ways that these matters have been properly dealt with and that all information is correct. 4. VAT: The VAT position relating to the property may change without notice. 5. To find out how we process Personal Data, please refer to our Group Privacy Statement and other notices at <https://www.knightfrank.com/legals/privacy-statement>.

Particulars dated July 2024. Photographs and videos dated July 2024.

Knight Frank is the trading name of Knight Frank LLP. Knight Frank LLP is a limited liability partnership registered in England and Wales with registered number OC305934. Our registered office is at 55 Baker Street, London W1U 8AN where you may look at a list of members' names. If we use the term 'partner' when referring to one of our representatives, that person will either be a member, employee, worker or consultant of Knight Frank LLP and not a partner in a partnership. If you do not want us to contact you further about our services then please contact us by either calling 020 3544 0692, email to marketing.help@knightfrank.com or post to our UK Residential Marketing Manager at our registered office (above) providing your name and address.