



Meriden Court, Chelsea Manor Street SW3



Meriden Court

Chelsea Manor Court SW3

Situated on the ground floor of a well maintained portered building, this is a light and bright one bedroom flat which measures approximately 542 square feet. The flat is presented in good order having recently undergone a kitchen refurbishment, in addition there is the added benefit of three basement storage rooms. This flat would make an excellent rental investment or pied-a-terre.



Guide price: £680,000

Tenure: share of freehold, approximately 996 years remaining

Service charge: £4,922.98 per annum, plus £2,775 to a reserve fund, reviewed every year, next review due 2025

Ground rent: Peppercorn

Local authority: Royal Borough of Kensington & Chelsea

Council tax band: E





Meriden Court is conveniently located for the shops and restaurants of both King's Road and Chelsea Green. The building is extremely well-run having just recently acquired the freehold.



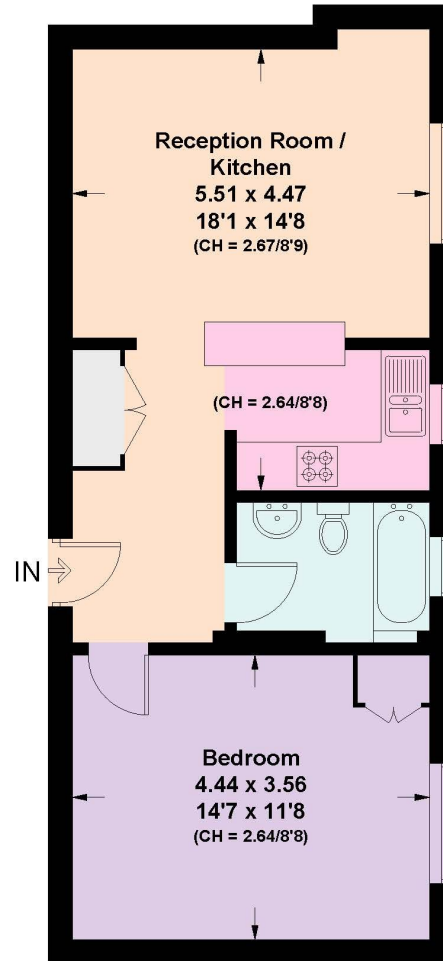

Ground Floor

Meriden Court, SW3

Approximate Floor Area 50.4 sq m / 542 sq ft



Knight Frank
Knightsbridge
 52 - 54 Sloane Avenue
 London
 SW3 3DD
knightfrank.co.uk

I would be delighted to tell you more
James Robinson
 +44 20 7861 1792
james.robinson@knightfrank.com

This plan is for guidance only and must not be relied upon as a statement of fact. Attention is drawn to the important notice on the last page of the text of the Particulars.



Fixtures and fittings: A list of the fitted carpets, curtains, light fittings and other items fixed to the property which are included in the sale (or may be available by separate negotiation) will be provided by the Seller's Solicitors.

Important Notice: 1. Particulars: These particulars are not an offer or contract, nor part of one. You should not rely on statements by Knight Frank LLP in the particulars or by word of mouth or in writing ("information") as being factually accurate about the property, its condition or its value. Neither Knight Frank LLP nor any joint agent has any authority to make any representations about the property, and accordingly any information given is entirely without responsibility on the part of the agents, seller(s) or lessor(s). 2. Photos, Videos etc: The photographs, property videos and virtual viewings etc. show only certain parts of the property as they appeared at the time they were taken. Areas, measurements and distances given are approximate only. 3. Regulations etc: Any reference to alterations to, or use of, any part of the property does not mean that any necessary planning, building regulations or other consent has been obtained. A buyer or lessee must find out by inspection or in other ways that these matters have been properly dealt with and that all information is correct. 4. VAT: The VAT position relating to the property may change without notice. 5. To find out how we process Personal Data, please refer to our Group Privacy Statement and other notices at <https://www.knightfrank.com/legals/privacy-statement>.

Particulars dated April 2024. Photographs and videos dated April 2024.

Knight Frank is the trading name of Knight Frank LLP. Knight Frank LLP is a limited liability partnership registered in England and Wales with registered number OC305934. Our registered office is at 55 Baker Street, London W1U 8AN where you may look at a list of members' names. If we use the term 'partner' when referring to one of our representatives, that person will either be a member, employee, worker or consultant of Knight Frank LLP and not a partner in a partnership. If you do not want us to contact you further about our services then please contact us by either calling 020 3544 0692, email to marketing.help@knightfrank.com or post to our UK Residential Marketing Manager at our registered office (above) providing your name and address.