



Pembridge Villas, London **W11**

Pembridge Villas, London W11

Located on the third floor of a period building, this quiet and light apartment on Pembridge Villas offers over 1,000 square feet of living space. It includes a spacious, south-east facing living room with far reaching views, three bedrooms and a separate kitchen and sizeable bathroom at the rear of the flat. It provides plenty of light and is a bright living space. There is a large storage space on the second floor half landing.

Pembridge Villas is well located for the many restaurants and shops of Notting Hill Gate. There is an electric car charging point beside the house.



Guide price: £1,200,000

Tenure: Share of freehold plus leasehold, approximately 973 years remaining

Service charge: We have been unable to confirm the service charges and review periods. You should make your own enquiries.

Ground rent: We are unable to confirm the ground rent. You should make your own enquiries.

Local authority: Royal Borough of Kensington and Chelsea

Council tax band: G







[Dashed line] = Reduced head height below 1.5m

Pembridge Villas, W11

Approximate Gross Internal Floor Area
95.3 sq m / 1026 sq ft

This plan is for guidance only and must not be relied upon as a statement of fact. Attention is drawn to the important notice on the last page of the text of the Particulars.

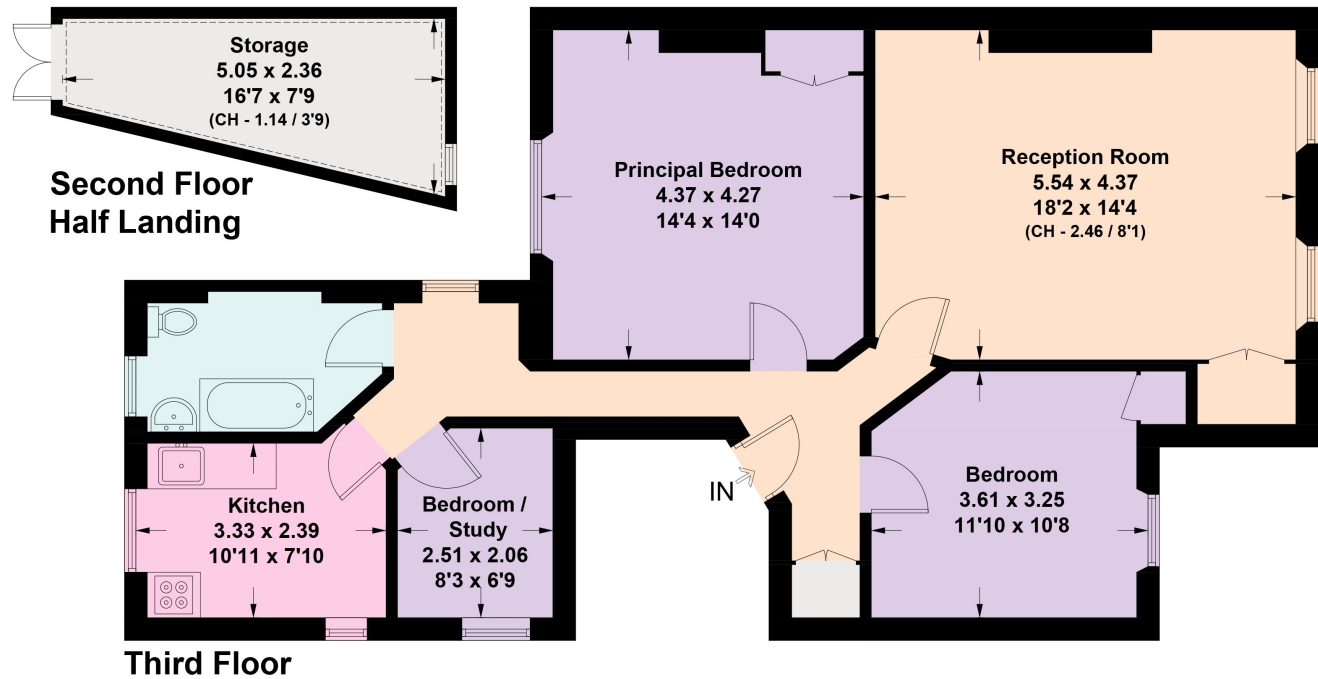

Knight Frank

Notting Hill

294 Westbourne Grove

London

W11 2PS

We would be delighted to tell you more

Jack Thomas

020 3910 9732

jack.thomas@knightfrank.com



Fixtures and fittings: A list of the fitted carpets, curtains, light fittings and other items fixed to the property which are included in the sale (or may be available by separate negotiation) will be provided by the Seller's Solicitors.

Important Notice: 1. Particulars: These particulars are not an offer or contract, nor part of one. You should not rely on statements by Knight Frank LLP in the particulars or by word of mouth or in writing ("information") as being factually accurate about the property, its condition or its value. Neither Knight Frank LLP nor any joint agent has any authority to make any representations about the property, and accordingly any information given is entirely without responsibility on the part of the agents, seller(s) or lessor(s). 2. Photos, Videos etc: The photographs, property videos and virtual viewings etc. show only certain parts of the property as they appeared at the time they were taken. Areas, measurements and distances given are approximate only. 3. Regulations etc: Any reference to alterations to, or use of, any part of the property does not mean that any necessary planning, building regulations or other consent has been obtained. A buyer or lessee must find out by inspection or in other ways that these matters have been properly dealt with and that all information is correct. 4. VAT: The VAT position relating to the property may change without notice. 5. To find out how we process Personal Data, please refer to our Group Privacy Statement and other notices at <https://www.knightfrank.com/legals/privacy-statement>.

Particulars dated September 2024. Photographs and videos dated September 2024.

Knight Frank is the trading name of Knight Frank LLP. Knight Frank LLP is a limited liability partnership registered in England and Wales with registered number OC305934. Our registered office is at 55 Baker Street, London W1U 8AN where you may look at a list of members' names. If we use the term 'partner' when referring to one of our representatives, that person will either be a member, employee, worker or consultant of Knight Frank LLP and not a partner in a partnership. If you do not want us to contact you further about our services then please contact us by either calling 020 3544 0692, email to marketing.help@knightfrank.com or post to our UK Residential Marketing Manager at our registered office (above) providing your name and address.