

Hollandgreen Place

LONDON W8





Hollandgreen Place is an award winning development completed in 2016 on the site of the former Commonwealth Institute and found on the southern border of Holland Park itself. It consists of three impressive interconnected buildings grouped around the former Institute's exhibition building which is now the home of the new Design Museum.

Residents are looked after by a 24 hour concierge team and also have use of a number of private facilities including a 20m swimming pool with double height ceilings and natural light, a sauna, steam room, gym, spa treatment room, cinema, golf simulator, business suite and children's playroom.

Kensington High Street is close by with its huge variety of amenities including Michelin starred restaurants, renowned supermarkets, excellent transport links (the District & Circle lines at High Street Kensington Underground Station), well-regarded preparatory schools as well as the open spaces of Holland Park, Kensington Gardens and Hyde Park. Furthermore, Knightsbridge and the West End are easily accessible, as is London Heathrow International Airport.









- Reception room
- Principal bedroom with en suite bath & shower room and dressing room
- Two guest double bedroom suites
- Kitchen / breakfast room
- Cloakroom
- Utility room
- Two balconies
- Lift
- 24hr concierge
- Underground parking space
- Storage unit
- Swimming pool
- Cinema
- Gym & spa
- Games room
- Golf simulator
- Conference suite
- EPC B



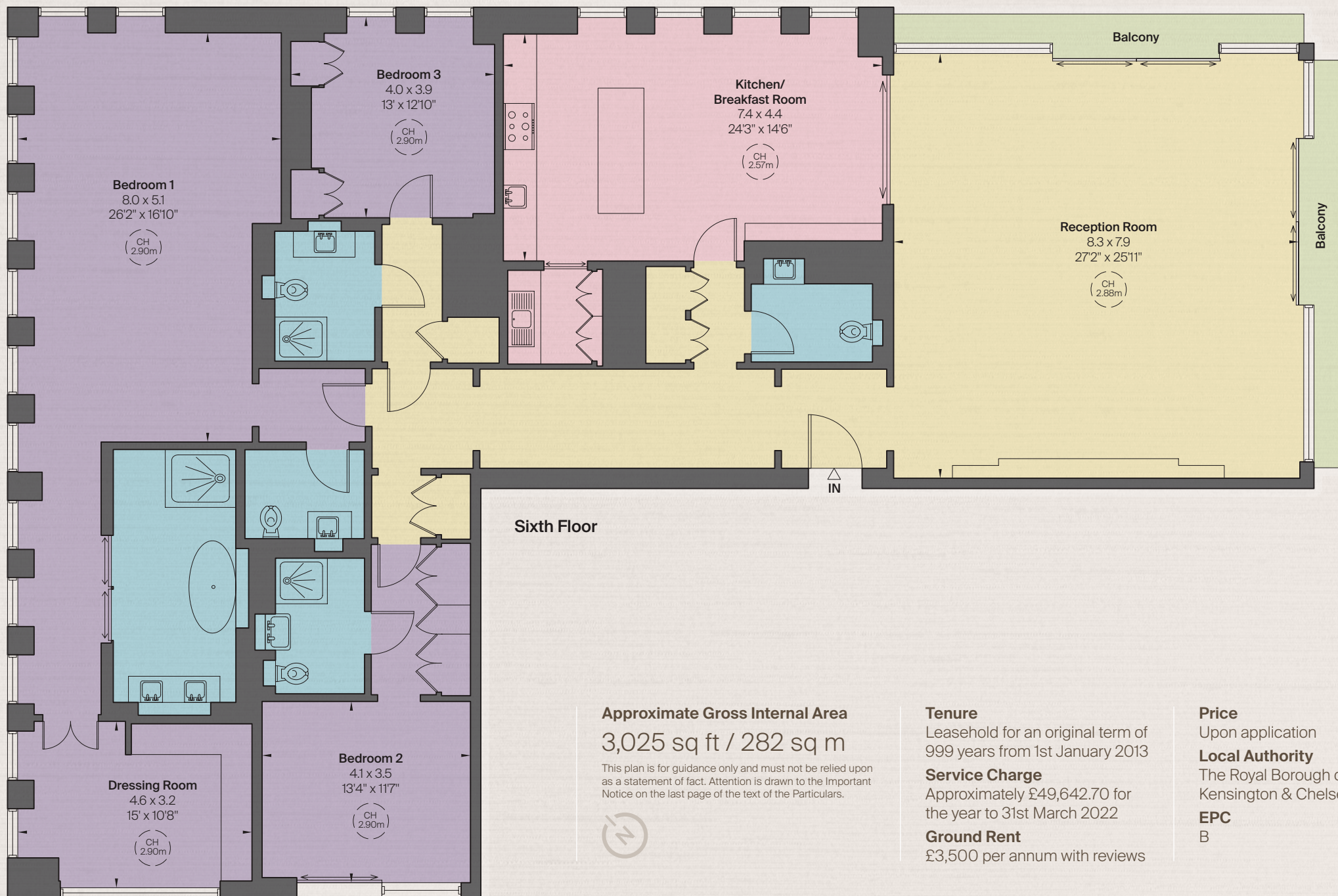



THE ALEX
BROCHURE WINSHIP



Kensington
020 7938 4311
kensington@knightfrank.com
knightfrank.co.uk



Savills Kensington
020 7535 3300
kensington@savills.com
savills.co.uk

Important Notice: 1. Particulars: These particulars are not an offer or contract, nor part of one. You should not rely on statements by Knight Frank LLP in the particulars or by word of mouth or in writing ("information") as being factually accurate about the property, its condition or its value. Neither Knight Frank LLP nor any joint agent has any authority to make any representations about the property, and accordingly any information given is entirely without responsibility on the part of the agents, seller(s) or lessor(s). 2. Photos, Videos etc: The photographs, property videos and virtual viewings etc. show only certain parts of the property as they appeared at the time they were taken. Areas, measurements and distances given are approximate only. 3. Regulations etc: Any reference to alterations to, or use of, any part of the property does not mean that any necessary planning, building regulations or other consent has been obtained. A buyer or lessee must find out by inspection or in other ways that these matters have been properly dealt with and that all information is correct. 4. VAT: The VAT position relating to the property may change without notice. 5. To find out how we process Personal Data, please refer to our Group Privacy Statement and other notices at <https://www.knightfrank.com/legal/privacy-statement>. **Particulars dated 15/03/22. Photographs and videos dated 03/11/20.** Knight Frank is the trading name of Knight Frank LLP. Knight Frank LLP is a limited liability partnership registered in England and Wales with registered number OC305934. Our registered office is at 55 Baker Street, London W1U 8AN where you may look at a list of members' names. If we use the term 'partner' when referring to one of our representatives, that person will either be a member, employee, worker or consultant of Knight Frank LLP and not a partner in a partnership. If you do not want us to contact you further about our services then please contact us by either calling 020 3544 0692, email to marketing.help@knightfrank.com or post to our UK Residential Marketing Manager at our registered office (above) providing your name and address. KF-201110B-08GG