



Fawcett Street, Chelsea **SW10**



Fawcett Street, Chelsea **SW10**

This immaculately presented family house offers excellent entertaining and living space across approximately 3,113 sq ft. Upon entry at the ground floor, there is an inviting open-plan kitchen/dining room at the heart of the home. Natural light floods through large windows in the TV/playroom on the floor below that leads directly through the bi-fold doors onto the south-facing walled garden. Additionally, there is an elegant, double reception room on the first floor with working fireplaces and features French windows which open onto a charming terrace.

A convenient study sits at the half landing with views over the garden.



Guide price: £4,250,000

Tenure: Freehold

Local authority: Royal Borough of Kensington and Chelsea

Council tax band: H



The second floor is dedicated to the master suite, complete with an en suite bathroom and a generously sized walk-in dressing room. Completing the accommodation are four further double bedrooms served by a family bathroom at half landing.

A further shower room, large utility room and tanked storage vaults add further convenience for a family home on the lower ground floor.

Location

Nestled in the heart of Chelsea, one of London's most prestigious and vibrant districts, Fawcett Street is a lovely and quiet residential street, moments from the independent shops, bars and restaurants of both the Hollywood and Fulham Road.

Transport links from Fawcett Street are excellent, with easy access to the rest of London via the nearby underground stations and bus routes.



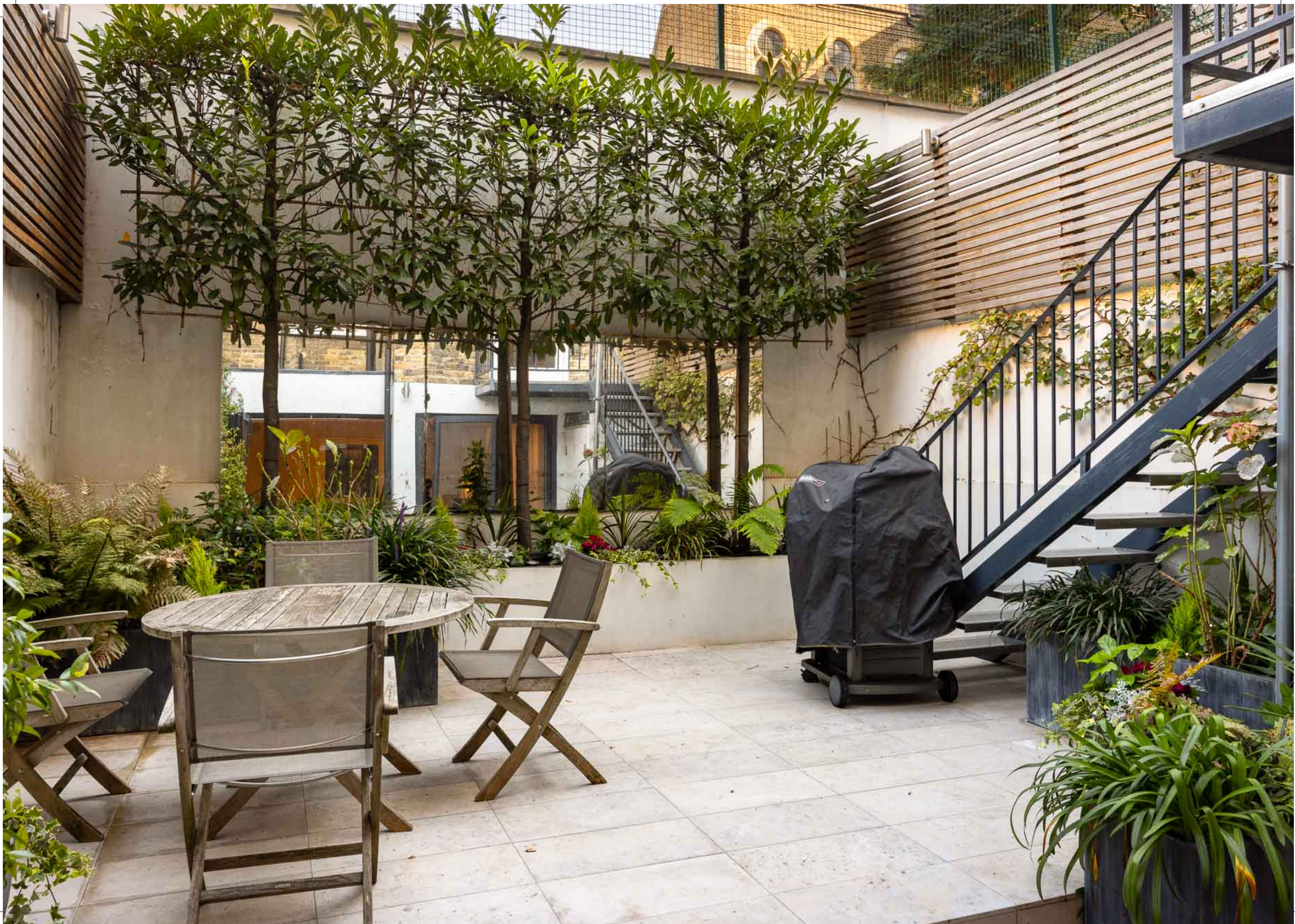

Fawcett Street, SW10

APPROX. GROSS INTERNAL AREA *
3062 Sq Ft - 284.48 Sq M
(Excluding Vault)

VAULT AREA
51 Sq Ft - 4.74 Sq M

TOTAL APPROX. GROSS INTERNAL AREA *
3113 Sq Ft - 289.22 Sq M

This floorplan is for GUIDANCE ONLY and NOT FOR VALUATION purposes.



This plan is for guidance only and must not be relied upon as a statement of fact. Attention is drawn to the important notice on the last page of the text of the Particulars.

Knight Frank
Chelsea
352A Kings Road
London
SW3 5UU
knightfrank.co.uk

We would be delighted to tell you more

Charles Olver
020 7349 4302

charles.olver@knightfrank.com

Anna Narizzano
020 3826 0639

anna.narizzano@knightfrank.com



Fixtures and fittings: A list of the fitted carpets, curtains, light fittings and other items fixed to the property which are included in the sale (or may be available by separate negotiation) will be provided by the Seller's Solicitors.

Important Notice: 1. Particulars: These particulars are not an offer or contract, nor part of one. You should not rely on statements by Knight Frank LLP in the particulars or by word of mouth or in writing ("information") as being factually accurate about the property, its condition or its value. Neither Knight Frank LLP nor any joint agent has any authority to make any representations about the property, and accordingly any information given is entirely without responsibility on the part of the agents, seller(s) or lessor(s). 2. Photos, Videos etc: The photographs, property videos and virtual viewings etc. show only certain parts of the property as they appeared at the time they were taken. Areas, measurements and distances given are approximate only. 3. Regulations etc: Any reference to alterations to, or use of, any part of the property does not mean that any necessary planning, building regulations or other consent has been obtained. A buyer or lessee must find out by inspection or in other ways that these matters have been properly dealt with and that all information is correct. 4. VAT: The VAT position relating to the property may change without notice. 5. To find out how we process Personal Data, please refer to our Group Privacy Statement and other notices at <https://www.knightfrank.com/legals/privacy-statement>.

Particulars dated April 2024. Photographs and videos dated April 2024.

All information is correct at the time of going to print. Knight Frank is the trading name of Knight Frank LLP. Knight Frank LLP is a limited liability partnership registered in England and Wales with registered number OC305934. Our registered office is at 55 Baker Street, London W1U 8AN. We use the term 'partner' to refer to a member of Knight Frank LLP or an employee or consultant. A list of members names of Knight Frank LLP may be inspected at our registered office. If you do not want us to contact you further about our services then please contact us by either calling 020 3544 0692, email to marketing.help@knightfrank.com or post to our UK Residential Marketing Manager at our registered office (above) providing your name and address.