



Elizabeth Court, Chelsea **SW10**



Elizabeth Court, Chelsea SW10

This is a wonderful, one bedroom flat on the ground floor of Elizabeth Court, a brilliantly managed, purpose built building in Chelsea for those aged 55 and over.

The accommodation is comprised of a reception room, which enjoys plenty of natural light, with doors which open out onto a small patio area. There is a separate kitchen, a double bedroom with built-in storage and a well-appointed bathroom. The apartment is conveniently situated close to the resident's reading room, guest suite and laundry. Elizabeth Court benefits from an Estate Manager, off street parking on a first come, first served basis and a beautiful communal garden. Elizabeth Court is one of Chelsea's true havens, which is perfect for those downsizing from a larger home in the area.



Guide price: £450,000

Tenure: Leasehold: approximately 114 years remaining

Local authority: The Royal Borough of Kensington and Chelsea

Council tax band: B



Elizabeth Court

Gross Internal Area(approx.) - 46.35 m²/ (499 Ft²)

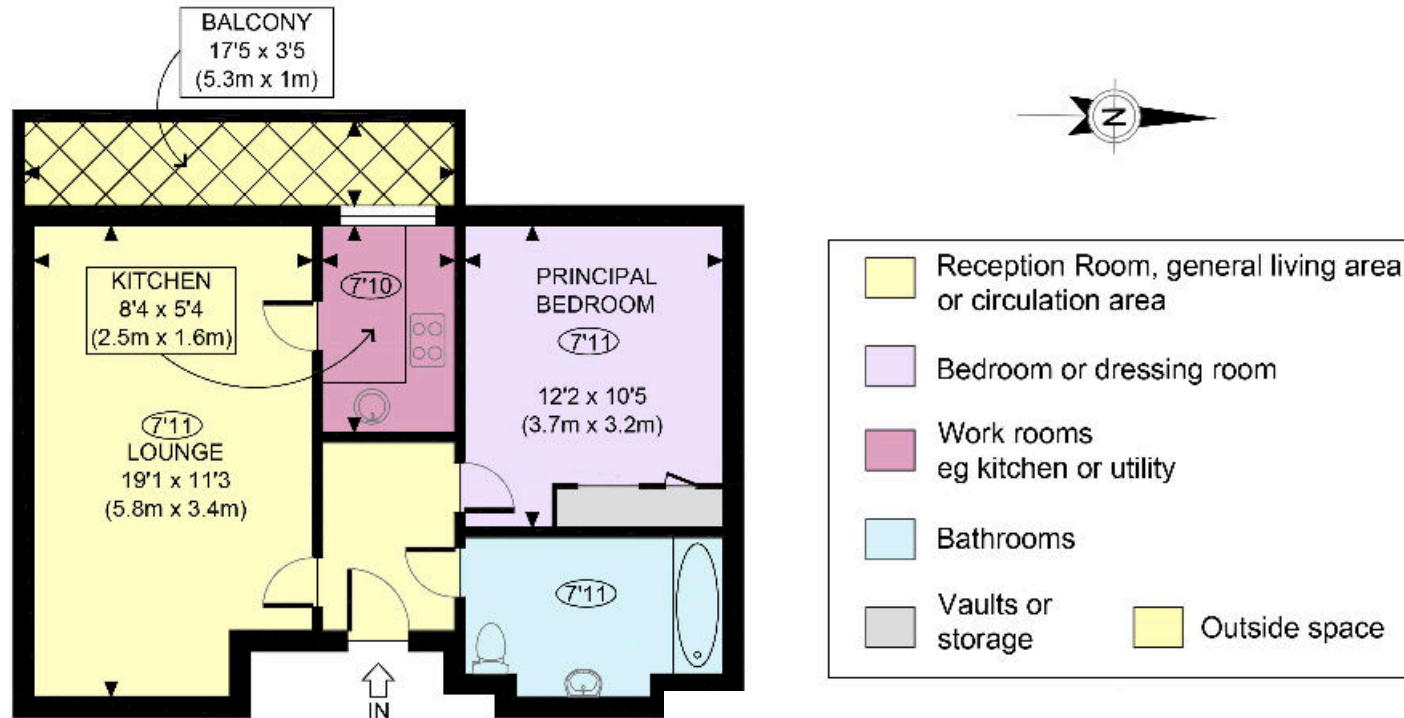

Knight Frank
Knight Frank Chelsea
352A King's Road
London SW3 5UU

We would be delighted to tell you more
Toto Lambert
020 7349 4309
antonia.lambert@knightfrank.com

[knightfrank.co.uk](https://www.knightfrank.co.uk)



Fixtures and fittings: A list of the fitted carpets, curtains, light fittings and other items fixed to the property which are included in the sale (or may be available by separate negotiation) will be provided by the Seller's Solicitors.

Important Notice: 1. Particulars: These particulars are not an offer or contract, nor part of one. You should not rely on statements by Knight Frank LLP in the particulars or by word of mouth or in writing ("information") as being factually accurate about the property, its condition or its value. Neither Knight Frank LLP nor any joint agent has any authority to make any representations about the property, and accordingly any information given is entirely without responsibility on the part of the agents, seller(s) or lessor(s). 2. Photos, Videos etc: The photographs, property videos and virtual viewings etc. show only certain parts of the property as they appeared at the time they were taken. Areas, measurements and distances given are approximate only. 3. Regulations etc: Any reference to alterations to, or use of, any part of the property does not mean that any necessary planning, building regulations or other consent has been obtained. A buyer or lessee must find out by inspection or in other ways that these matters have been properly dealt with and that all information is correct. 4. VAT: The VAT position relating to the property may change without notice. 5. To find out how we process Personal Data, please refer to our Group Privacy Statement and other notices at <https://www.knightfrank.com/legals/privacy-statement>.

Particulars dated August 2022. Photographs and videos dated August 2022.

Knight Frank is the trading name of Knight Frank LLP. Knight Frank LLP is a limited liability partnership registered in England and Wales with registered number OC305934. Our registered office is at 55 Baker Street, London W1U 8AN where you may look at a list of members' names. If we use the term 'partner' when referring to one of our representatives, that person will either be a member, employee, worker or consultant of Knight Frank LLP and not a partner in a partnership. If you do not want us to contact you further about our services then please contact us by either calling 020 3544 0692, email to marketing.help@knightfrank.com or post to our UK Residential Marketing Manager at our registered office (above) providing your name and address.