



KNARESBOROUGH DRIVE, SW18

£700,000

- Modern Apartment
- Two Bedrooms
- Two Bathrooms
- Large Private Terrace
- Allocated Parking
- Energy rating: TBC





ABOUT THE HOME

A two bedroom, two bathroom modern apartment. This property is being sold with allocated underground parking and benefits from large terrace views over King George's park.

Accommodation comprises of a spacious hallway with useful storage cupboard, leading to well presented modern kitchen with built in appliances, open plan to the reception and dining areas that have sliding doors onto the large private balcony offering a great entertaining space. A modern family bathroom, two double bedrooms; master bedroom benefiting from an in built wardrobe and en suite bathroom. His property is being sold with a secure, allocated underground parking space. The development boasts communal gardens, a concierge service.

George View House is located on Knaresborough Drive and is close to central Earlsfield, benefiting from the local amenities including shops, bars, restaurants and transport links.





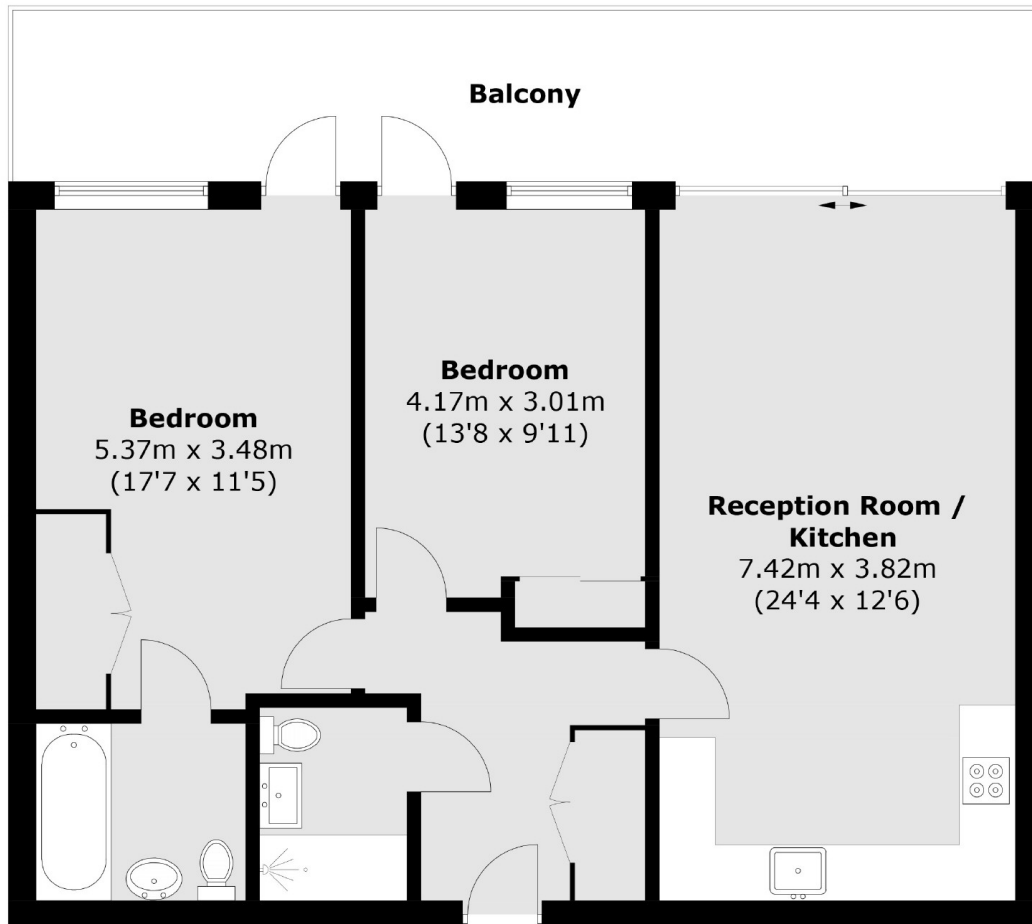

Third Floor

Approx Internal Area: 78.9 sq. m (849.3 sq. ft)
Balcony: 20.2 sq. m (217.4 sq. ft)

JACKSONS EARLSFIELD

372-374 Garratt Lane,
Earlsfield, London, SW18 4ES
Sales: 020 8971 7979
Lettings: 020 8971 7070

Energy Rating: We aim to make our particulars both accurate and reliable. However they are not guaranteed; nor do they form part of an offer or contract. If you require clarification on any points then please contact us, especially if you're traveling some distance to view. Please note that appliances and heating systems have not been tested and therefore no warranties can be given as to their good working order.