



ACUBA ROAD, SW18

£650,000

- Three double bedrooms
- Impressive views
- Close to transport links
- Communal garden
- Sought after location
- Energy rating: D





## ABOUT THE HOME

A stunning three bedroom first floor apartment with wonderful views over King George's Park.

The property is set within a 1930's development and benefits from a beautifully presented communal garden. Accommodation comprises; entrance hall with useful storage cupboard, three very generously sized double bedrooms, modern family bathroom, spacious and bright reception room and dining room which is open plan to a modern kitchen. The boasts ample storage throughout.

Located on a much sought after road in Earlsfield, the property is well placed for some of the most desirable schools in the area and is a short walk from Earlsfield, Southfields and Wimbledon Park stations. Garratt Lane with its array of trendy shops, bars and restaurants is within easy reach for a vibrant lifestyle. The green open space of King George's Park is also a stones throw away.









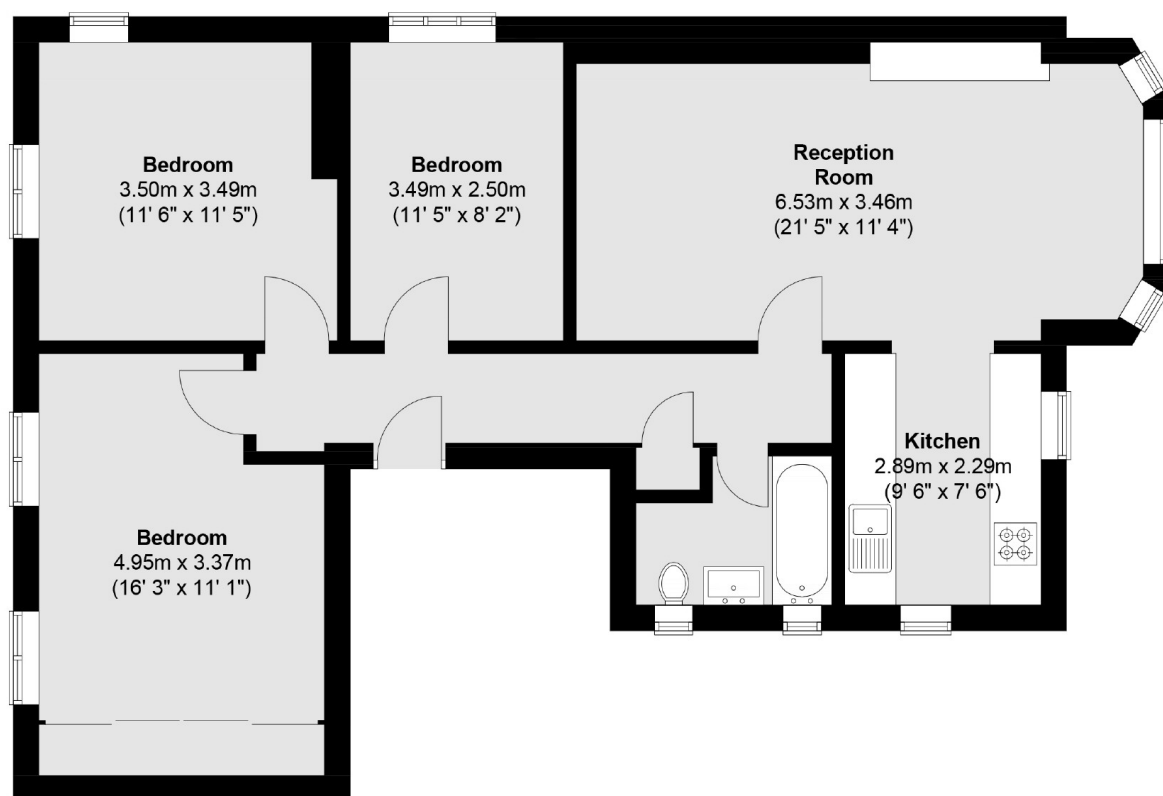

Total area (approx.) : 80.9 sq. m (871 sq. ft)

#### **JACKSONS EARLSFIELD**

372-374 Garratt Lane,  
Earlsfield, London, SW18 4ES  
Sales: 020 8971 7979  
Lettings: 020 8971 7070

Energy Rating: D We aim to make our particulars both accurate and reliable. However they are not guaranteed; nor do they form part of an offer or contract. If you require clarification on any points then please contact us, especially if you're traveling some distance to view. Please note that appliances and heating systems have not been tested and therefore no warranties can be given as to their good working order.