



St. Georges Grove, SW17

£485,000

A stunning two double bedroom, two bathroom, third floor modern apartment with large terrace and an allocated parking space.

- Large Terrace
- Two Bedrooms
- Two Bathrooms
- Modern Apartment
- Allocated Parking
- Sought After Location



The property also benefits from well maintained communal gardens. Accommodation comprises: an entrance hall with secure telephone entry system and useful storage cupboards, modern spacious bathroom, two generous bedrooms, the master bedroom benefiting from an en-suite bathroom and built-in wardrobe, open plan reception, kitchen and dining with door leading out to a private terrace.

The property is situated in the highly sought after 'Quadrangle/St Georges Grove' development, offering easy access to both Earlsfield mainline railway station or Tooting Broadway underground station. The green open spaces of Garratt Green and Wandsworth Common are also close by.



Third Floor

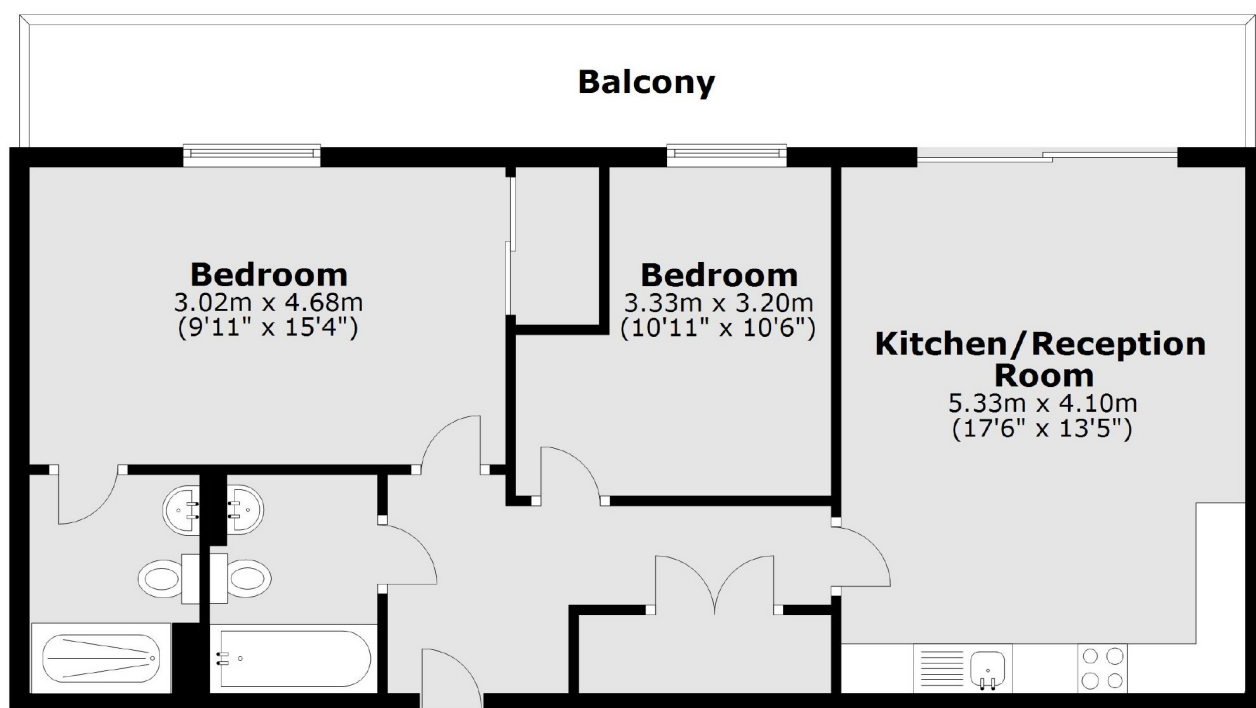

Main area: Approx. 65.7 sq. metres (706.7 sq. feet)

Plus balconies, approx. 16.5 sq. metres (177.9 sq. feet)

Jacksons Earlsfield
372-374 Garratt Lane
Earlsfield
London
SW18 4ES
020 8971 7979

Energy Rating: C We aim to make our particulars both accurate and reliable. However they are not guaranteed; nor do they form part of an offer or contract. If you require clarification on any points then please contact us, especially if you're traveling some distance to view. Please note that appliances and heating systems have not been tested and therefore no warranties can be given as to their good working order.