



KIMBER ROAD, SW18

£525,000

- Victorian ground floor flat
- Two bedrooms
- Modern kitchen
- Private garden
- Sought after location
- Energy rating: C







## ABOUT THE HOME

A two bedroom, ground floor, Victorian property with a private garden in a sought after location.

Accessed via a well maintained communal entrance this property is presented to the market in good condition throughout. Accommodation comprises a bright and spacious reception room to the front, a generous double bedroom, modern family bathroom, kitchen with an array of integrated appliances with direct access onto a large private garden, to the rear is a second bedroom.

Kimber Road is a residential road of similar period buildings, which are sought after being equidistant from Earlsfield and Wandsworth Town. This location is very well served by excellent transport links, restaurants, bars, leisure and shopping facilities all within close proximity of the property, as are the green open spaces of King George's Park.







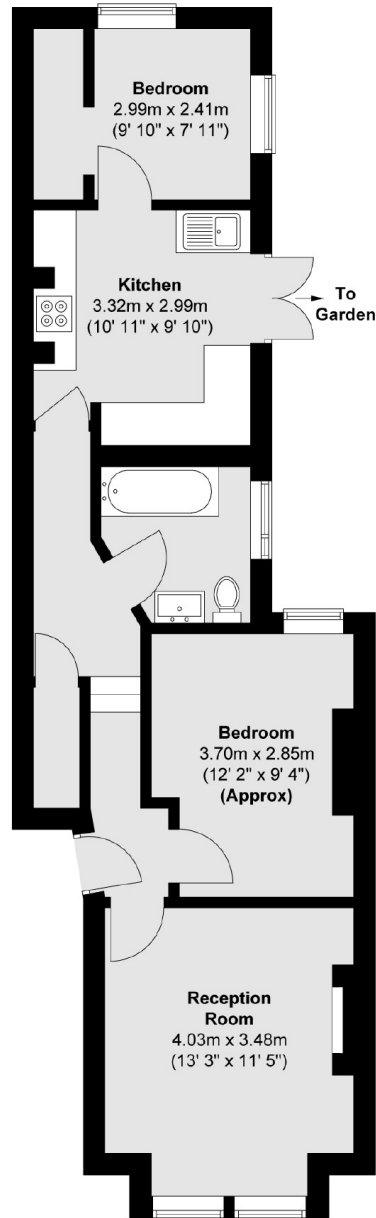

Total area (approx.) : 55.8 sq. m (601 sq. ft)

#### **JACKSONS EARLSFIELD**

372-374 Garratt Lane,  
Earlsfield, London, SW18 4ES  
Sales: 020 8971 7979  
Lettings: 020 8971 7070

Energy Rating: C We aim to make our particulars both accurate and reliable. However they are not guaranteed; nor do they form part of an offer or contract. If you require clarification on any points then please contact us, especially if you're traveling some distance to view. Please note that appliances and heating systems have not been tested and therefore no warranties can be given as to their good working order.