



BORRODAILE ROAD, SW18

£500,000

- Three bedroom ground floor flat
- Two modern bathrooms
- Large private garden
- Convenient Location
- No onward chain
- Energy rating: C





ABOUT THE HOME

A spacious three double bedroom ground floor apartment with direct access to a private rear garden. The property is being offered to the market with no onward chain.

This apartment comprises a spacious entrance hall with useful fitted cupboards, bright reception room which opens directly to a large private garden, four piece family bathroom with underfloor heating, separate fitted kitchen and three double bedrooms; the principle room boasting a stunning en suite bathroom and ample built in wardrobes. The property further benefits from a private front garden and is also eligible for permit parking.

Culver Court is located in close proximity to Southside shopping complex, with its array of high street shops, restaurants, multiplex cinema and a gym. Wandsworth Town and Earlsfield mainline stations are both within close proximity of the property, providing direct links to the City, the West End and outer London. King George's Park with its tennis courts, pond and playing fields is just moments away.





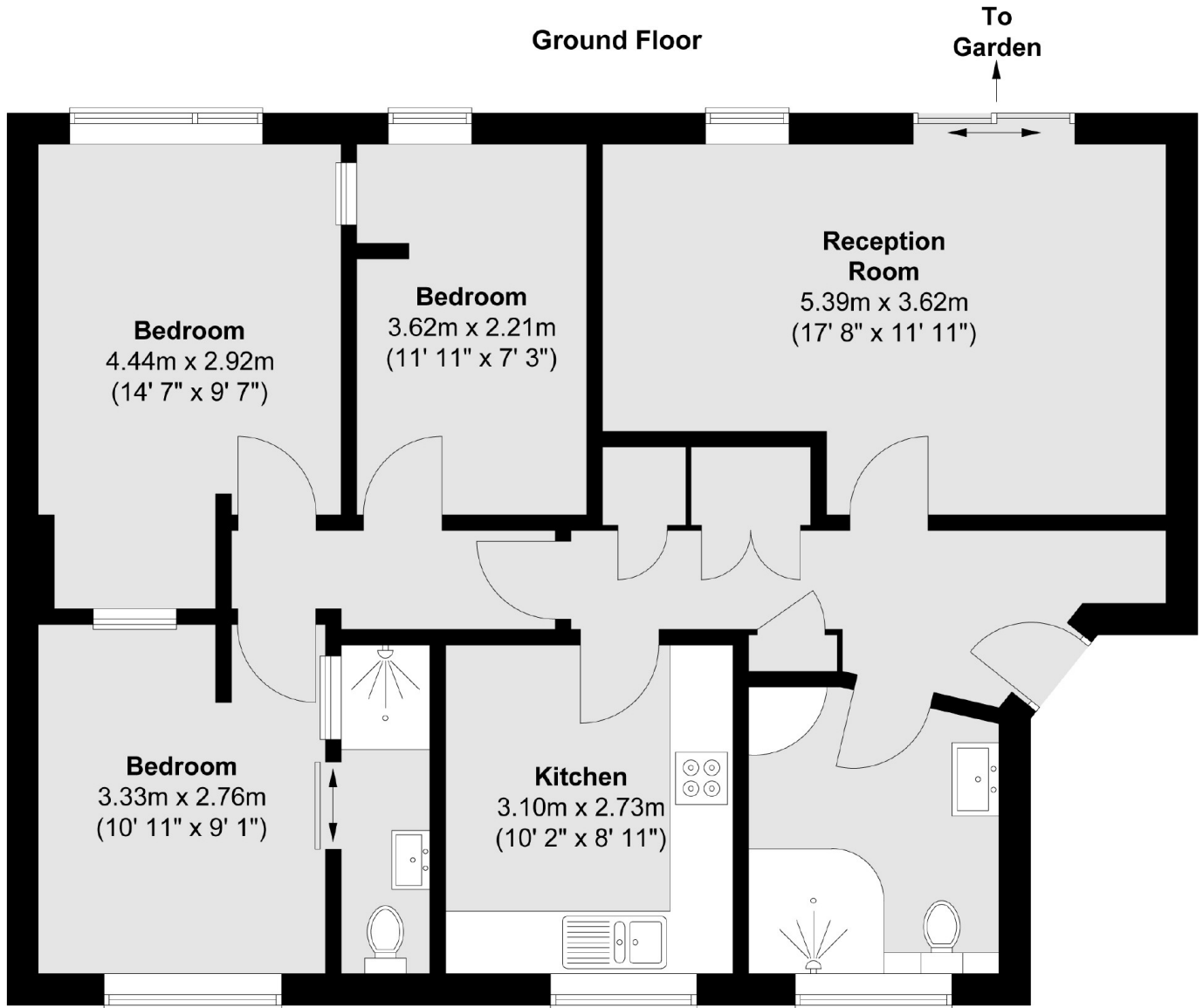

Total area (approx.) : 81.1 sq. m (873 sq. ft)

JACKSONS EARLSFIELD

372-374 Garratt Lane,
Earlsfield, London, SW18 4ES
Sales: 020 8971 7979
Lettings: 020 8971 7070

Energy Rating: C We aim to make our particulars both accurate and reliable. However they are not guaranteed; nor do they form part of an offer or contract. If you require clarification on any points then please contact us, especially if you're traveling some distance to view. Please note that appliances and heating systems have not been tested and therefore no warranties can be given as to their good working order.