



St. Georges Grove, SW17

£550,000

An impressively large, three bedroom, two bathroom modern apartment with secure allocated parking and direct access onto a private patio.

- Modern Development
- Three Double Bedrooms
- Two Bathrooms
- Open Plan
- Private Patio
- Allocated Parking



Accommodation comprises; an entrance hall with secure telephone entry system and useful storage cupboards, modern spacious bathroom with a bath, three generous double bedrooms, two of which benefit from built in wardrobes; the master bedroom offering a modern en-suite bathroom, exceptionally generous open plan reception, kitchen and dining room benefitting from an abundance of light and sliding doors lead out to a private patio and communal landscaped garden.

St. Georges Grove is located within close proximity to Earlsfield Station as well as the popular bars and restaurants of Garratt Lane. Further benefits of the development include onsite shopping facilities, allocated parking & bus links into Clapham Junction.



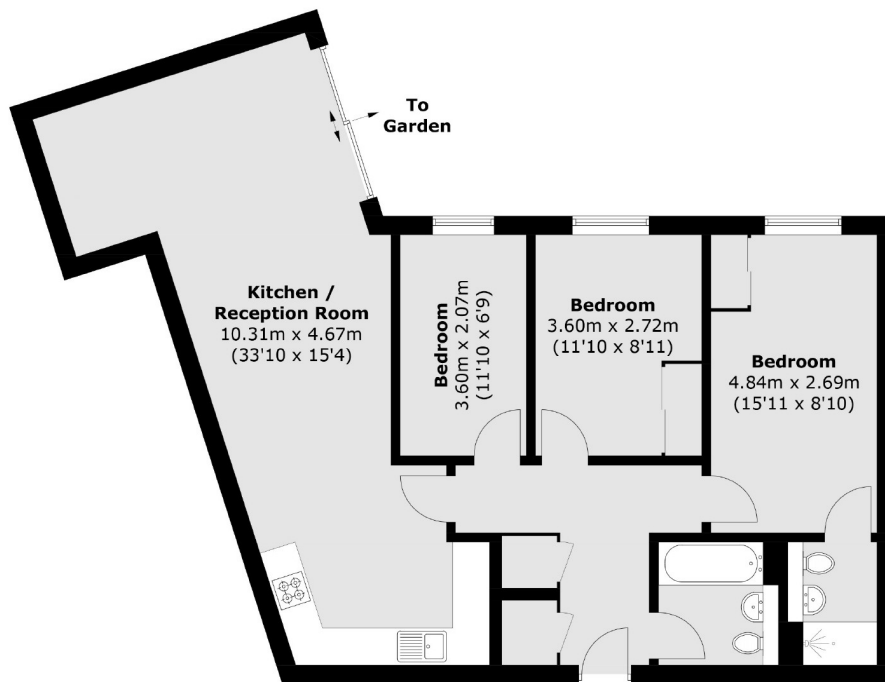

Total area (approx.): 87.3 sq. m (939.7 sq. ft)

Jacksons Earlsfield
372-374 Garratt Lane
Earlsfield
London
SW18 4ES
020 8971 7979

Energy Rating: We aim to make our particulars both accurate and reliable. However they are not guaranteed; nor do they form part of an offer or contract. If you require clarification on any points then please contact us, especially if you're traveling some distance to view. Please note that appliances and heating systems have not been tested and therefore no warranties can be given as to their good working order.