



St. Georges Grove, SW17

£475,000

A beautifully presented two double bedroom, two bathroom, ground floor modern apartment with a generous private terrace.

- Two Bedrooms
- Allocated Parking
- Ground Floor
- Private Terrace
- Modern Build
- Excellent Condition

Accommodation comprises; entrance hall with secure telephone entry system and useful storage cupboards, modern spacious bathroom, two generous double bedrooms, the main bedroom is complete with an en-suite bathroom and useful built-in wardrobe, open plan reception/kitchen and dining room which had been tastefully decorated and benefits from an abundance of light, with door leading out to a generous private terrace. The property also benefits from an allocated parking space, safe and secure bike storage facilities. This is a quiet, safe development with a community feel.

The property is situated in the highly sought after Quadrangle' development, offering fast access to both Wandsworth Common, Earlsfield and Tooting. The brand new Springfield Park is on the doorstep which provides open space for activities.



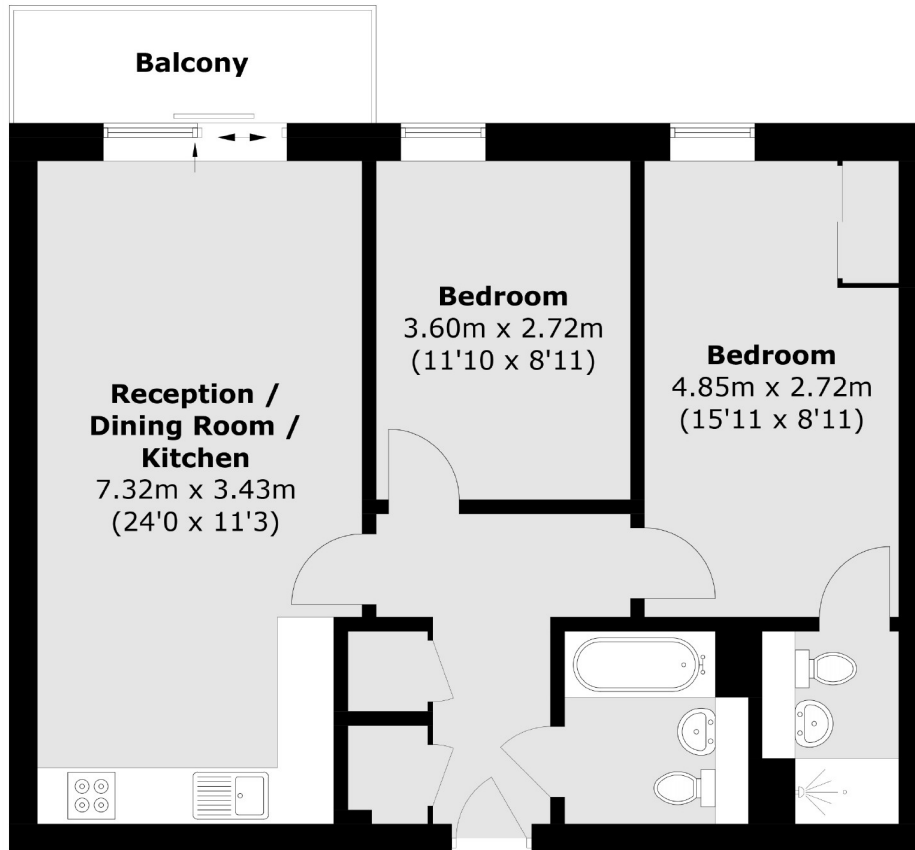

Total area (approx.): 65.1 sq. m (700.7 sq. ft)
Balcony area (approx.): 4.6 sq. m (49.5 sq. ft)

Jacksons Earlsfield
372-374 Garratt Lane
Earlsfield
London
SW18 4ES
020 8971 7979

Energy Rating: We aim to make our particulars both accurate and reliable. However they are not guaranteed; nor do they form part of an offer or contract. If you require clarification on any points then please contact us, especially if you're traveling some distance to view. Please note that appliances and heating systems have not been tested and therefore no warranties can be given as to their good working order.